

ALIEN



SPECTACULAR

1:2
SCALE

EASY
ASSEMBLY

BUILD THE
TERRIFYING
XENOMORPH
FROM ALIEN

PACK 2
KITS 5 - 12

ALIEN

PACK 2 | BUILD INSTRUCTIONS

KIT 05

SKULL & APPENDAGES

KIT 06

FRONT-LEFT SECTION
OF THE HEAD

KIT 07

CENTRE-LEFT SECTION
OF THE HEAD

KIT 08

FRONT-RIGHT SECTION
OF THE HEAD

KIT 09

CENTRE-RIGHT SECTION
OF THE HEAD

KIT 10

THE HEAD & NECK

KIT 11

THE NECK

KIT 12

THE HEAD & SKULL

WARNING: Some parts are assembled using magnets. These magnets can cause serious injury if they are swallowed. Keep away from children. If you suspect a magnet has been swallowed, seek medical help straight away.

Some parts may have sharp edges, please handle them with care.

The installation of electronic parts must always be carried out by an adult. When replacing batteries, use the same type of batteries.

Please ensure that the battery compartment is securely fastened before you use the model.

Used batteries should be recycled.

Please make sure to check with your local council how batteries should be disposed of in your area.

Batteries can present a choking danger to small children and may cause serious harm if ingested. Do not leave them lying around and keep any spare batteries locked away at all times.



STEPS & TIPS ONLINE

Hachette Partworks Ltd, 4th Floor, Jordan House,
47 Brunswick Place, London N1 6EB

www.hachettepartworks.com

© 2023/2024 Hachette Partworks Ltd.

© 2023 20th Century Studios.

ALL RIGHTS RESERVED

All parts belong to a kit. Collectors item for adults.

Not suitable for children under 14.



KIT 5: SKULL & APPENDAGES

In this kit you will continue the assembly of the skull of the Xenomorph and start to fix some of the appendages to the left-hand side.

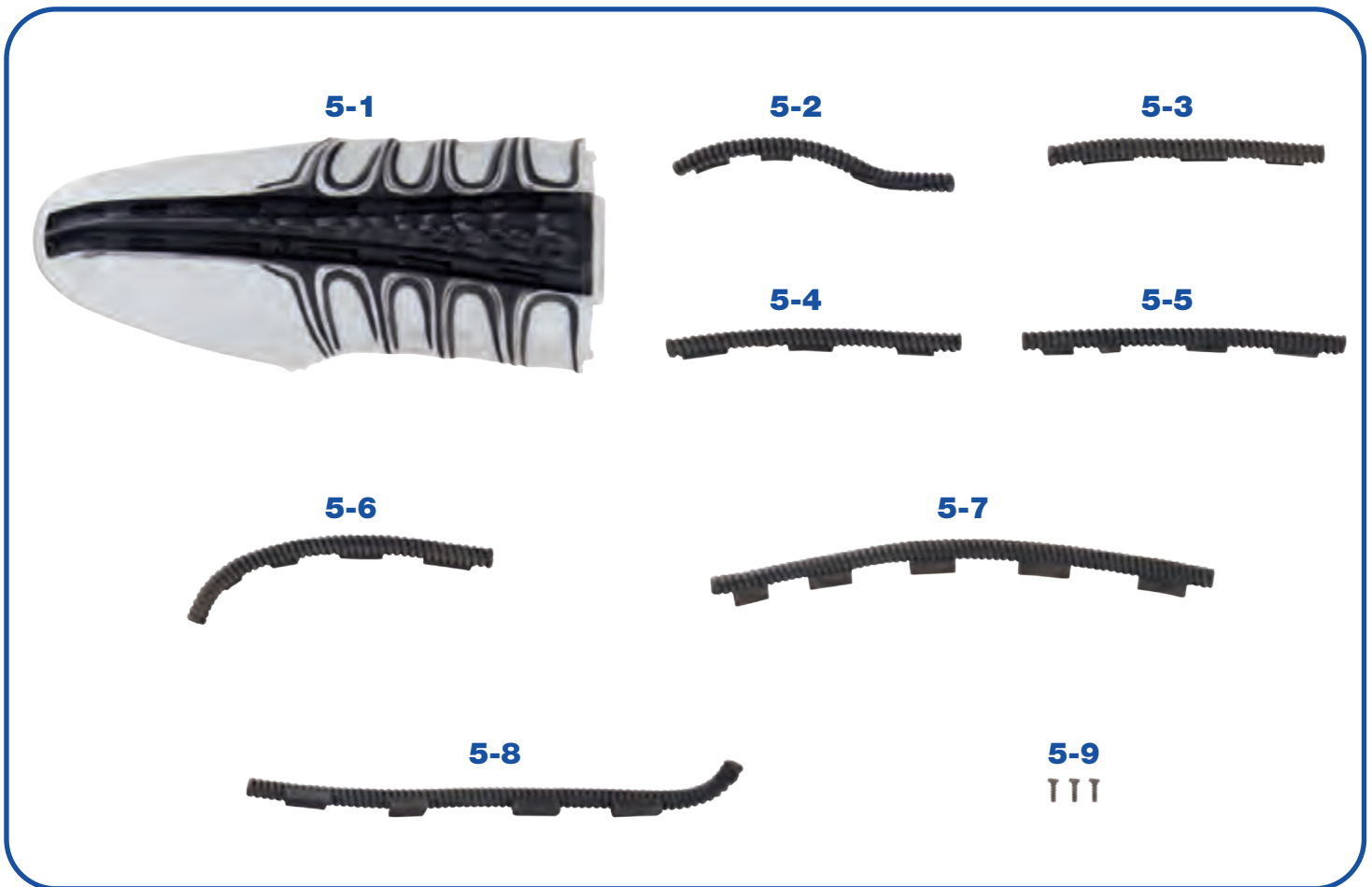

PARTS SUPPLIED

Ref.	Name	Qty.	Ref.	Name	Qty.
5-1	Skull C	1	5-6	Skull Pipe 5	1
5-2	Skull Pipe 1	1	5-7	Skull Pipe 6	1
5-3	Skull Pipe 2	1	5-8	Skull Pipe 7	1
5-4	Skull Pipe 3	1	5-9	2.3x6mm screws	3*
5-5	Skull Pipe 4	1			

*A spare screw is supplied in case of loss or damage.

KIT 5: SKULL & APPENDAGES

EXPERT TIP: Before starting the construction, study the parts photographed carefully to identify each of the skull pipes and lay them out in order.

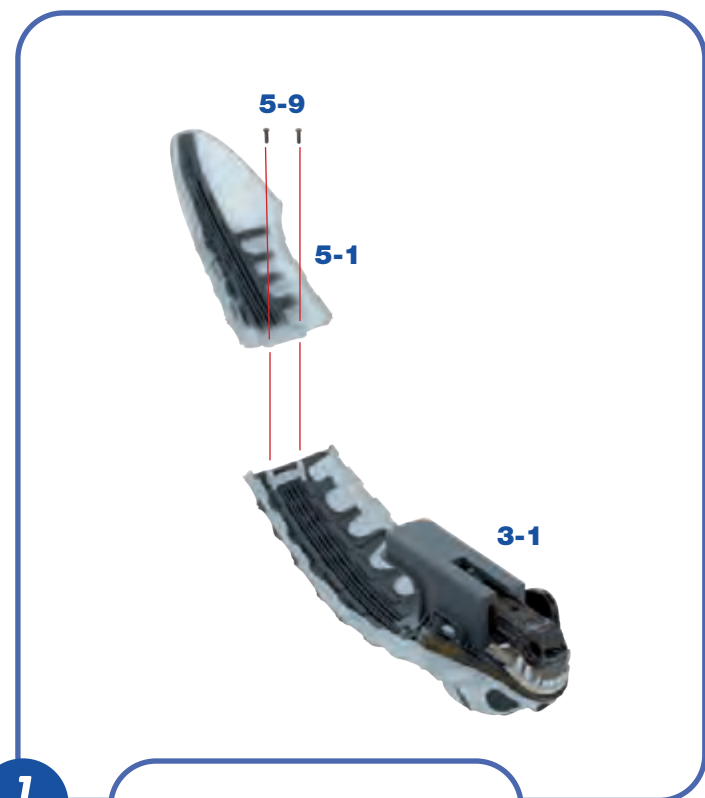

1

Take the skull assembly **3-1** which was worked on in a previous pack and Skull C **5-1**. Fit the screw holes in the Skull plate **5-1** over the raised screw sockets in Skull part **3-1**, as shown. Join the two parts together using two 2.3x6mm screws **5-9**.

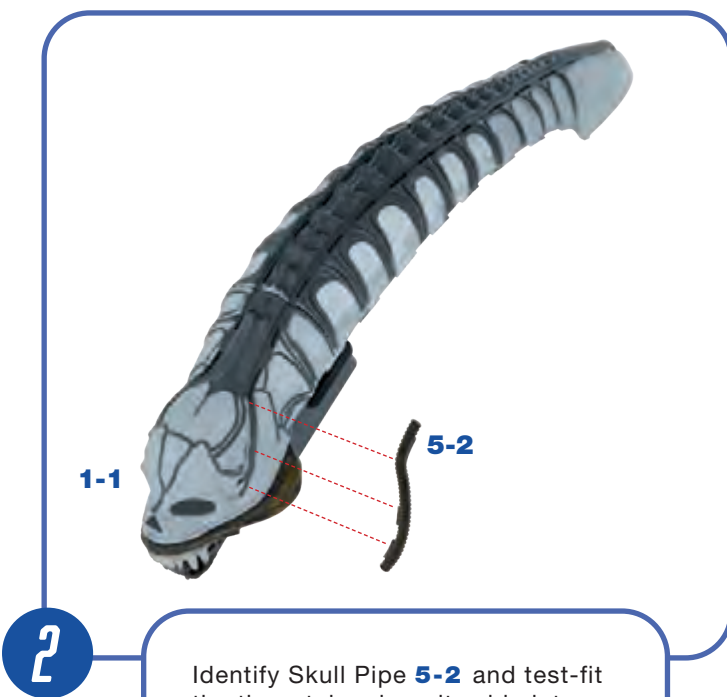

2

Identify Skull Pipe **5-2** and test-fit the three tabs along its side into the corresponding slots on the upper left side of the Skull part **1-1**. When sure of a good fit, apply a little glue to the tabs to secure the part firmly in place.

Next, identify Skull Pipes **5-3** and **5-4**; Pipe **5-3** is slightly longer than Pipe **5-4**. Take Pipe **5-3** and test-fit its three tabs into the corresponding slots in Skull parts **1-1** and **3-1**, as shown. Apply a little glue to the tabs and fit the part firmly in place.

3

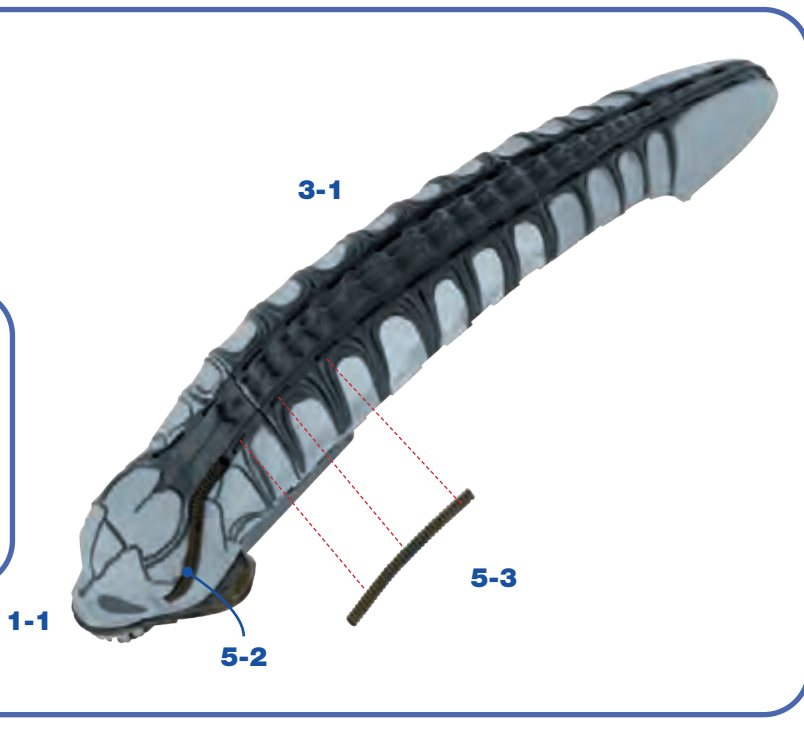

KIT 5: SKULL & APPENDAGES

4

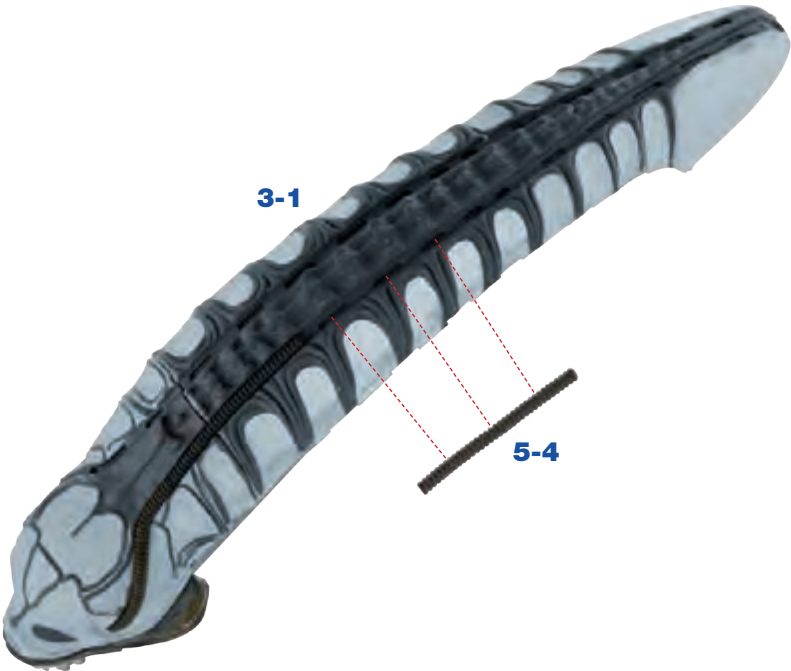

In a similar way, test-fit the three tabs on Pipe 5-4 into the slots in Skull part 3-1 so as to continue from Pipe 5-3. Apply a little glue to the tabs to hold the part firmly in place.

The pipes continue with the four tabs on Pipe 5-5 being fitted into the next four slots. Apply a little glue to the tabs and secure 5-5 firmly in place.

5

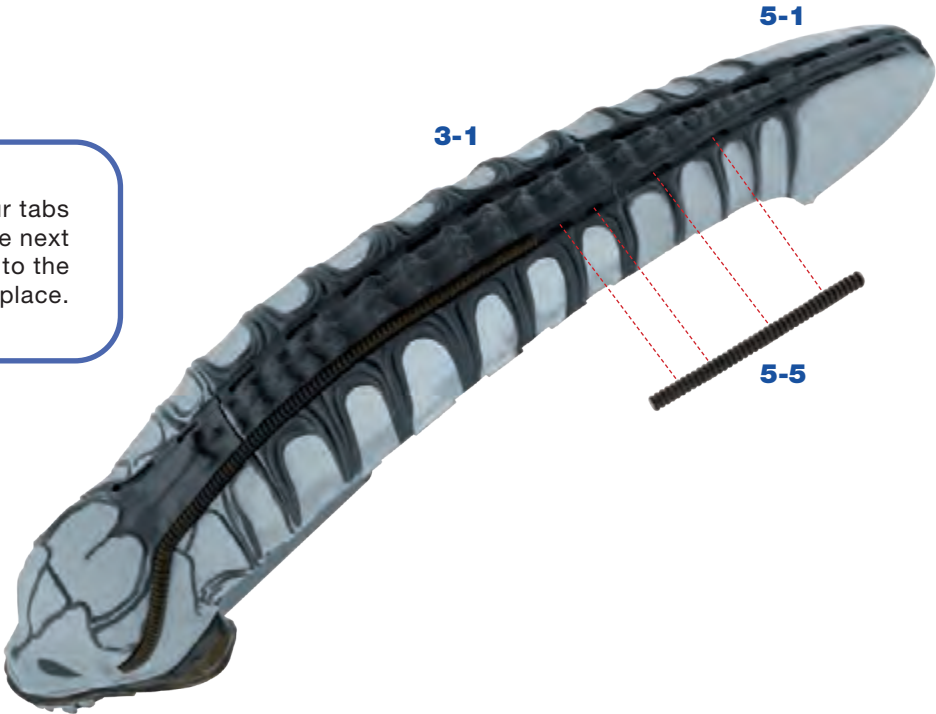

KIT 5: SKULL & APPENDAGE

6

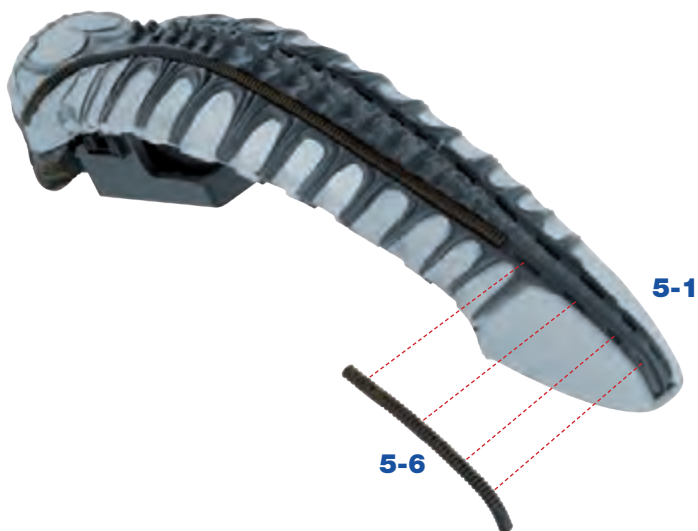

The line of pipes ends with the tabs on Pipe **5-6** fitting into the last four slots in Skull **5-1**. Again, apply a little glue to the tabs to secure the part firmly in place.

The last two Pipes **5-7** and **5-8** are fitted into the slots under the lower edge of the Skull **1-1**, **3-1** and **5-1**, as shown. Take time to test-fit these parts before applying a little glue to the tabs and securing them firmly in place.

7

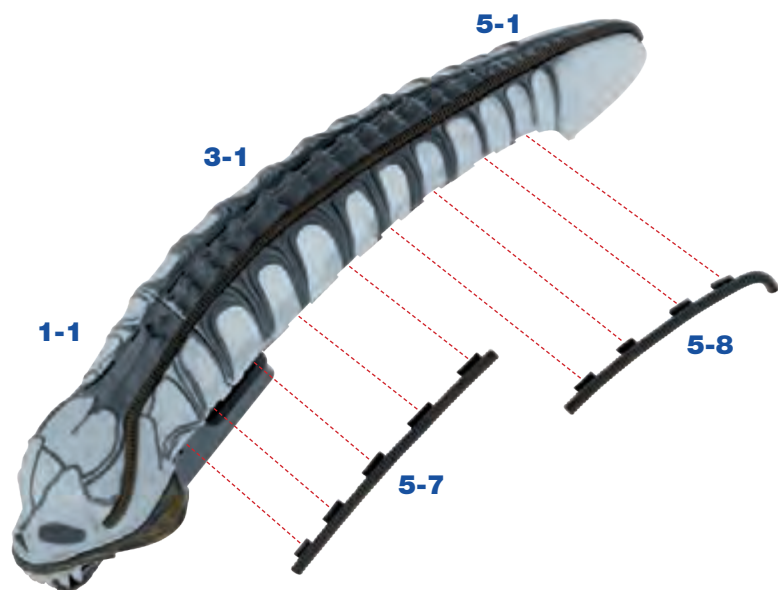

KIT 5 IS COMPLETE



*PIPES HAVE BEEN FITTED
ALONG THE LEFT-HAND SIDE
OF THE SKULL.*

KIT 6: FRONT-LEFT SECTION OF THE HEAD

In this kit you will start to assemble pieces of the front-left portion of the Xenomorph's head.



PARTS SUPPLIED

Ref.	Name	Qty.	Ref.	Name	Qty.
6-1	Front-left Section of the Head	1	6-5	Pipe 3 (front-left head section)	1
6-2	Washer	1	6-6	Pipe 4 (front-left head section)	1
6-3	Pipe 1 (front-left head section)	1	6-7	Pipe 5 (front-left head section)	1
6-4	Pipe 2 (front-left head section)	1			

KIT 6: FRONT-LEFT SECTION OF THE HEAD

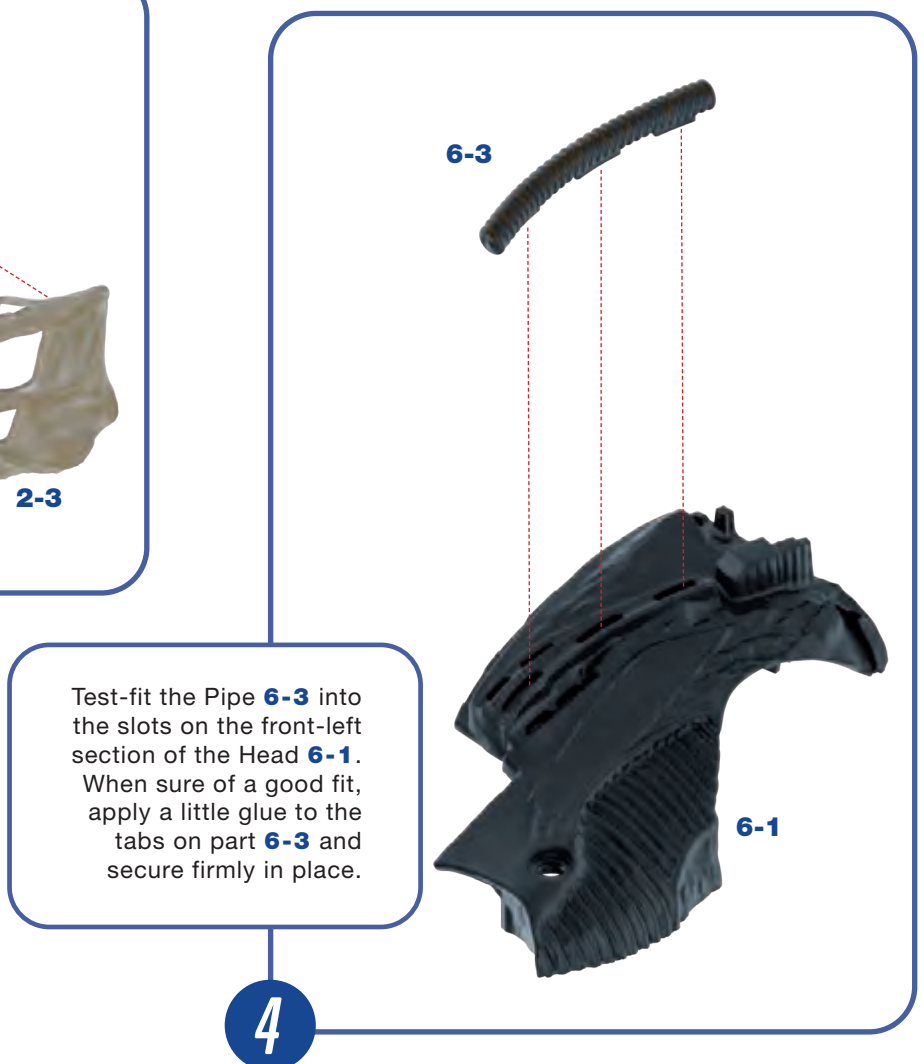
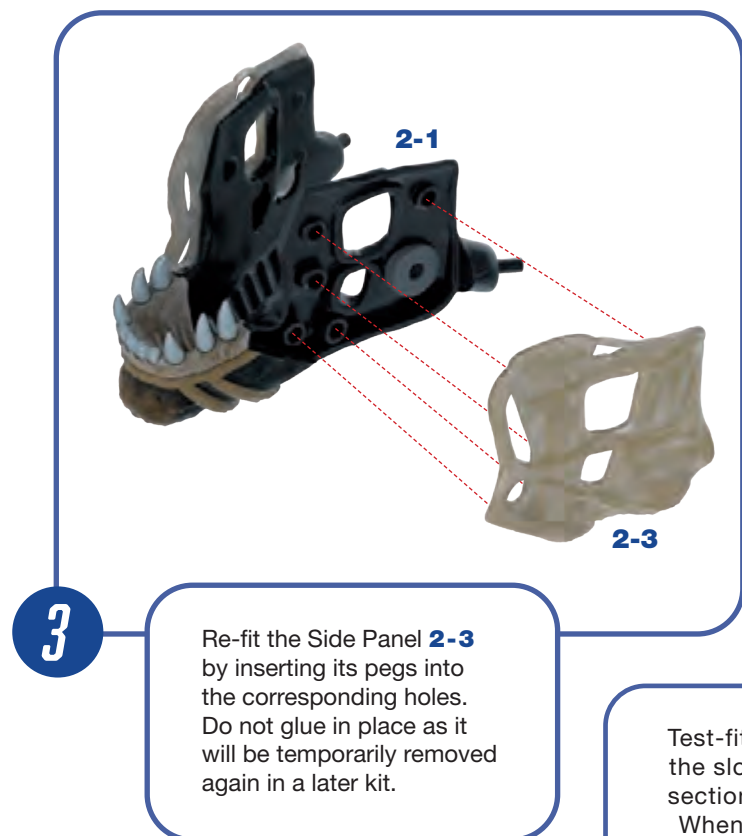
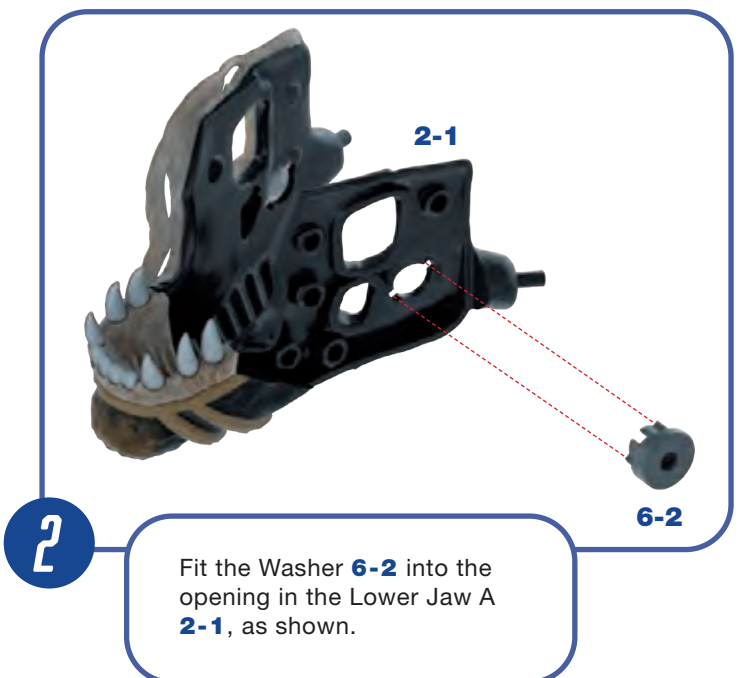
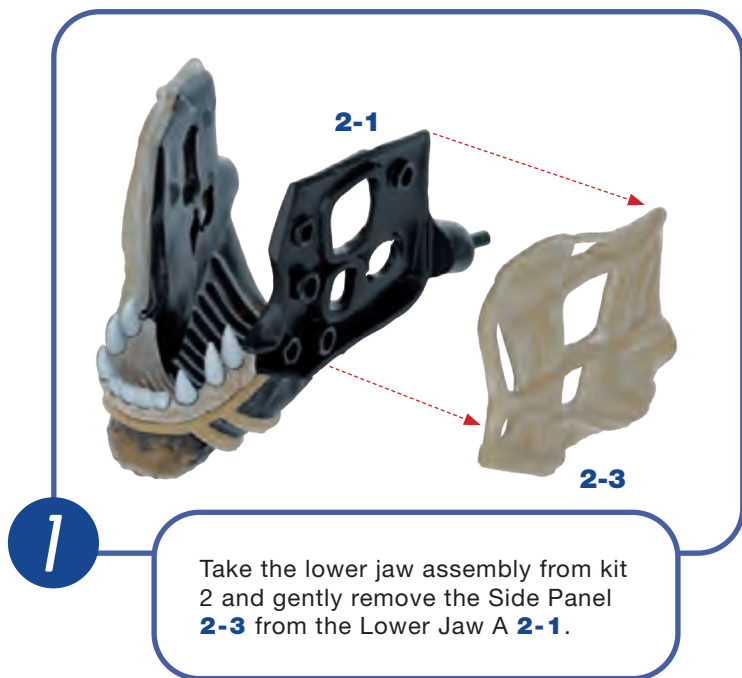

KIT 6: FRONT-LEFT SECTION OF THE HEAD

5

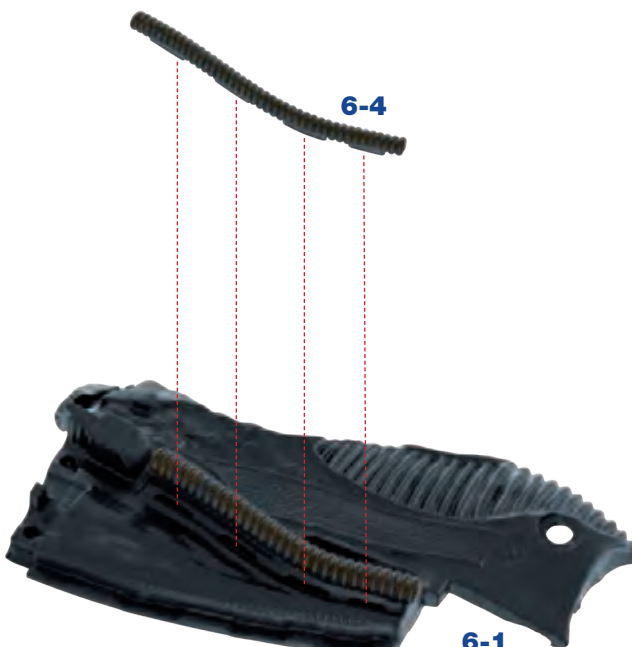

Turn the Head Section **6-1** around, as shown. After test-fitting, apply a little glue to the tabs on Pipe **6-4** and secure in place.

6



Finally, apply a little glue to the tabs on Pipe **6-5** and fit it into the slots in the front-left section of the Head **6-1**, as shown.

KIT 6 IS COMPLETE



PIPES AND OTHER PARTS HAVE BEEN FITTED TO THE FRONT-LEFT PORTION OF THE HEAD.



! Keep parts **6-6** and **6-7** safely aside until they are needed in the next kit.

KIT 7: CENTRE-LEFT SECTION OF THE HEAD

In this kit you will continue to assemble the centre-left side of the Xenomorph's head and add more appendages.



PARTS SUPPLIED

Ref.	Name	Qty.	Ref.	Name	Qty.
7-1	Centre-left Section of the Head	1	7-6	Pipe 5 (centre-left section)	1
7-2	Pipe 1 (centre-left section)	1	7-7	Pipe 6 (centre-left section)	1
7-3	Pipe 2 (centre-left section)	1	7-8	Pipe 7 (centre-left section)	1
7-4	Pipe 3 (centre-left section)	1	7-9	2.3x6mm screws	4*
7-5	Pipe 4 (centre-left section)	1			

* A spare screw is also supplied in case of loss or damage.

KIT 7: CENTRE-LEFT SECTION OF THE HEAD

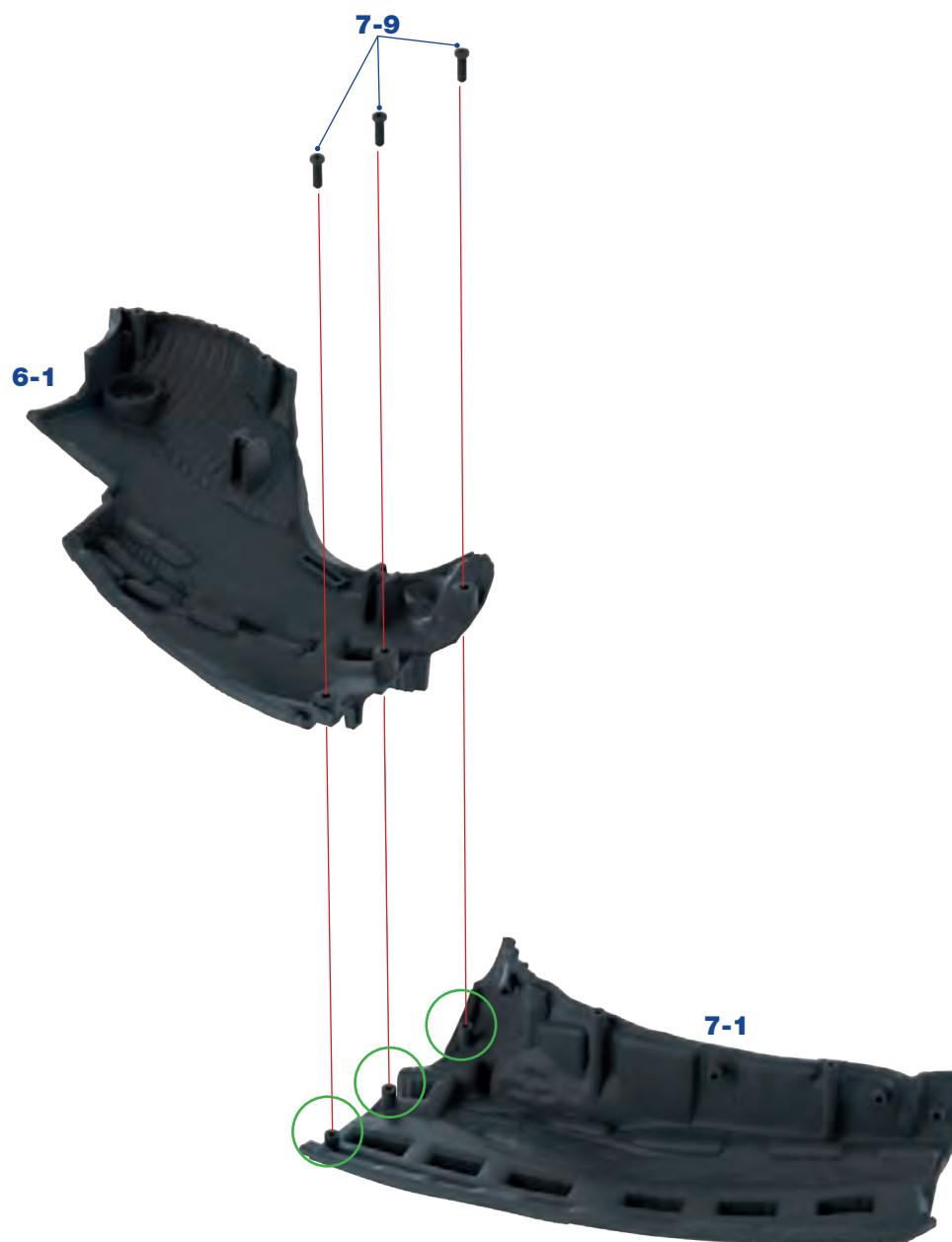

1

Take the Front-left Section of the Head **6-1** from the last kit along with part **7-1**. There are three raised screw sockets (circled) on **7-1** onto which the round recesses on part **6-1** fit. Join the two parts together using three 2.3x6mm screws **7-9**.

KIT 7: CENTRE-LEFT SECTION OF THE HEAD



Turn the assembly over and take the two Pipes **6-6** and **6-7** which were supplied with the previous kit. Test-fit these in position and when certain of a good fit, glue firmly in place. Part **6-7** fits across the join between Head parts **6-1** and **7-1**.

2

Examine the inset picture (right) to help you differentiate between parts **7-2**, **7-3** and **7-4**, each of which has a slightly different internal layout. After checking that each piece fits correctly in the place indicated on the Centre-left Section of the Head **7-1**, apply a dab of glue to Pipes 1 and 2 (**7-2** and **7-3**) and fit them over the rectangular blocks as shown in the photo.

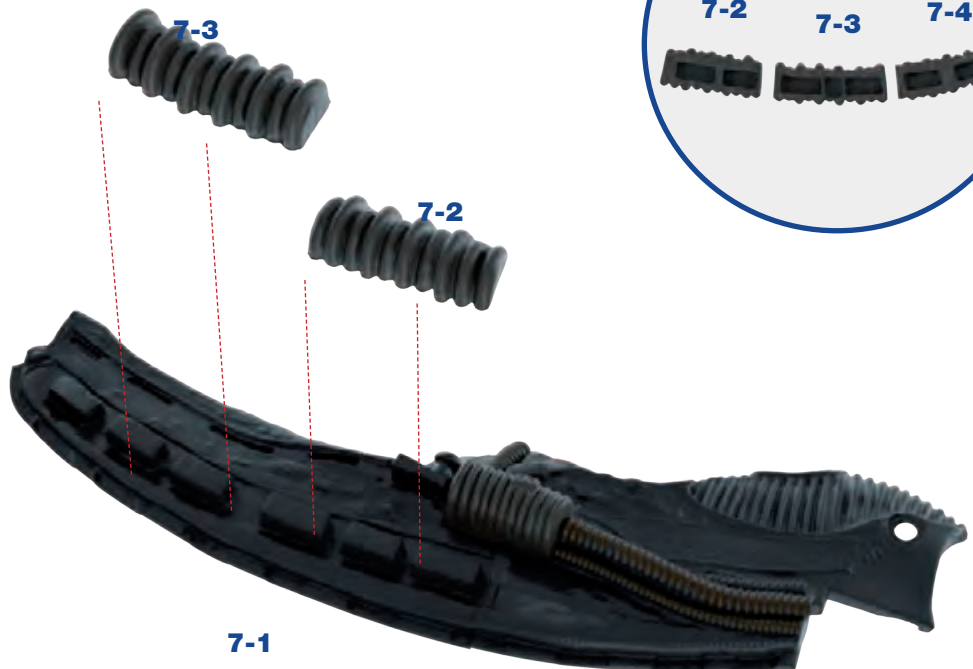

3

KIT 7: CENTRE-LEFT SECTION OF THE HEAD

After test-fitting, apply a little glue to Pipe **7-4** and attach by slotting it over the remaining two rectangular blocks on **7-1**.

4



Apply a little glue to the tabs on **7-5** and fit them into the first three slots along the lower edge of the Head Section **7-1**. In a similar way, attach Pipe **7-6** into the two remaining slots. As always, check the fit of pipes before glueing in place.

5

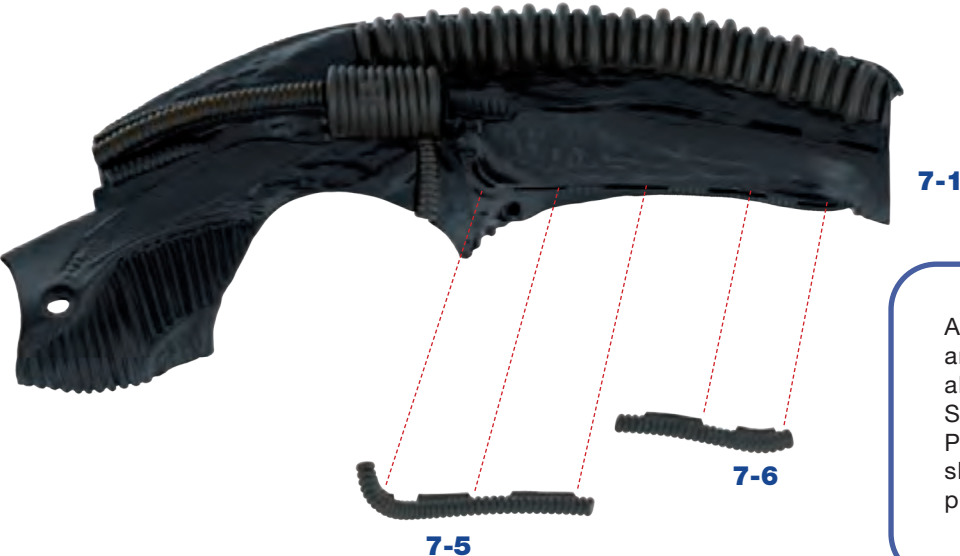

KIT 7: CENTRE-LEFT SECTION OF THE HEAD

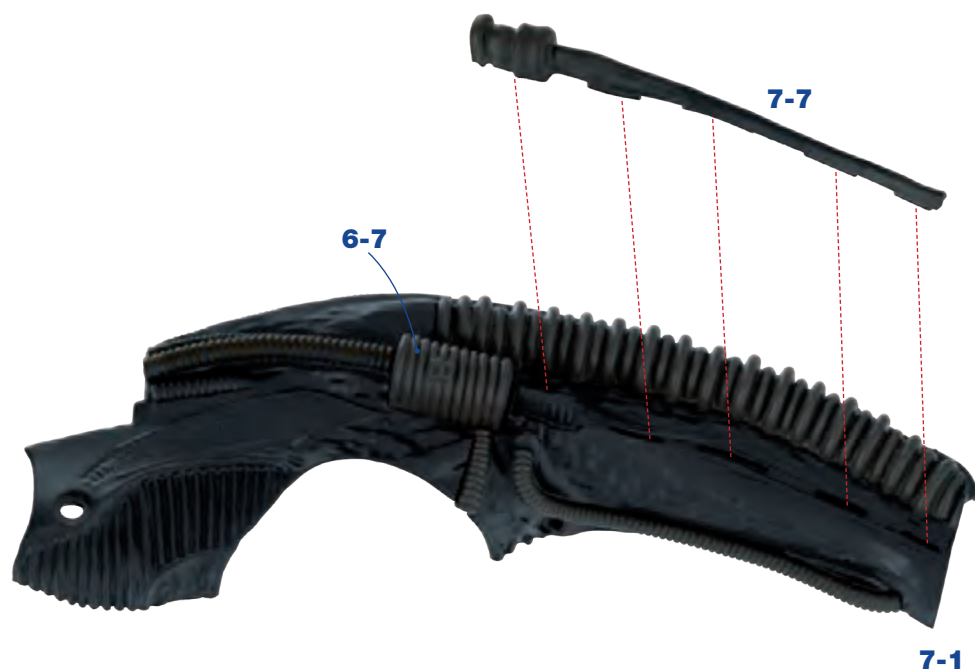

Finally, apply a little glue to the tabs on Pipe **7-7**. Noting that the widest end of the Pipe **7-7** sits next to Pipe **6-7**, fit the tabs into the slots, as shown.

6

KIT 7 IS COMPLETE

ANOTHER SECTION OF THE HEAD HAS BEEN COMPLETED BY ATTACHING PIPES TO IT.



! Keep Pipe **7-8** safely aside until it is needed in a later kit.

KIT 8: FRONT-RIGHT SECTION OF THE HEAD

In this kit you will start to assemble the parts of the front-right section of the Xenomorph's head.



PARTS SUPPLIED

Ref.	Name	Qty.	Ref.	Name	Qty.
8-1	Front-right Section of the Head	1	8-5	Pipe 3 (front-right head section)	1
8-2	Washer	1	8-6	Pipe 4 (front-right head section)	1
8-3	Pipe 1 (front-right head section)	1	8-7	Pipe 5 (front-right head section)	1
8-4	Pipe 2 (front-right head section)	1			

KIT 8: FRONT-RIGHT SECTION OF THE HEAD

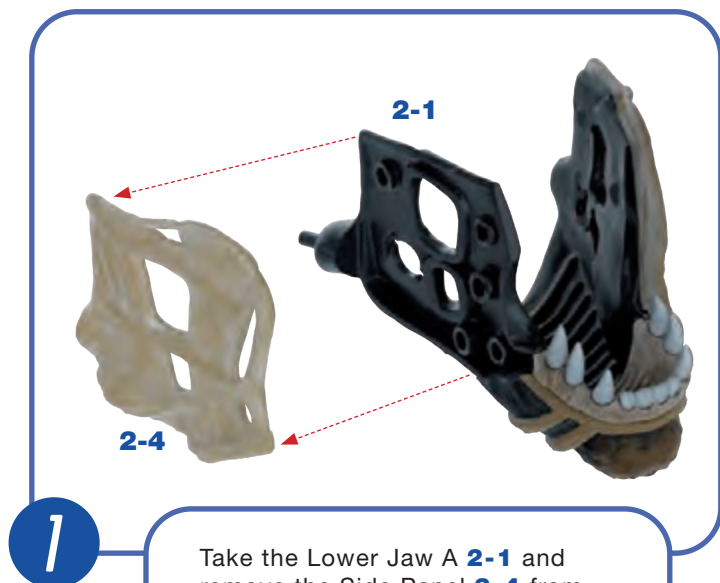

1

Take the Lower Jaw A **2-1** and remove the Side Panel **2-4** from **2-1** by pulling gently on it.

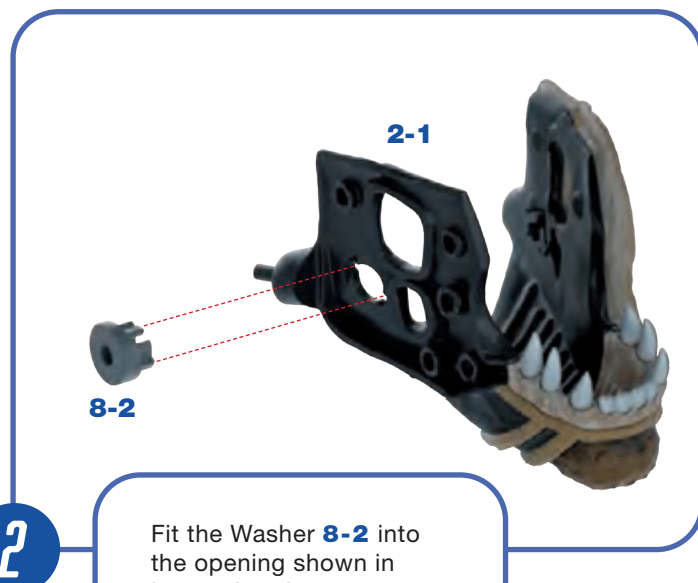

2

Fit the Washer **8-2** into the opening shown in Lower Jaw A **2-1**.

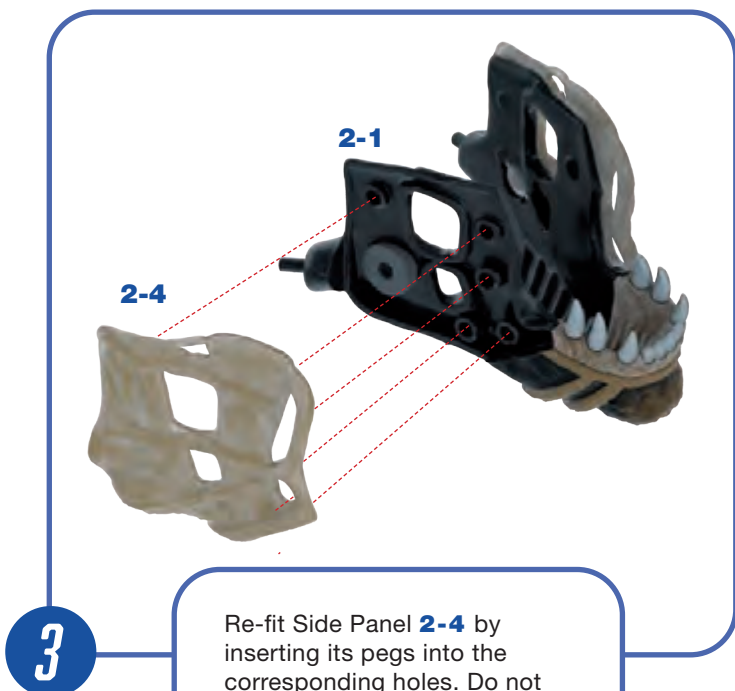

3

Re-fit Side Panel **2-4** by inserting its pegs into the corresponding holes. Do not glue in place as it will be temporarily removed again in kit 12. If necessary, use masking tape to hold the part in place.

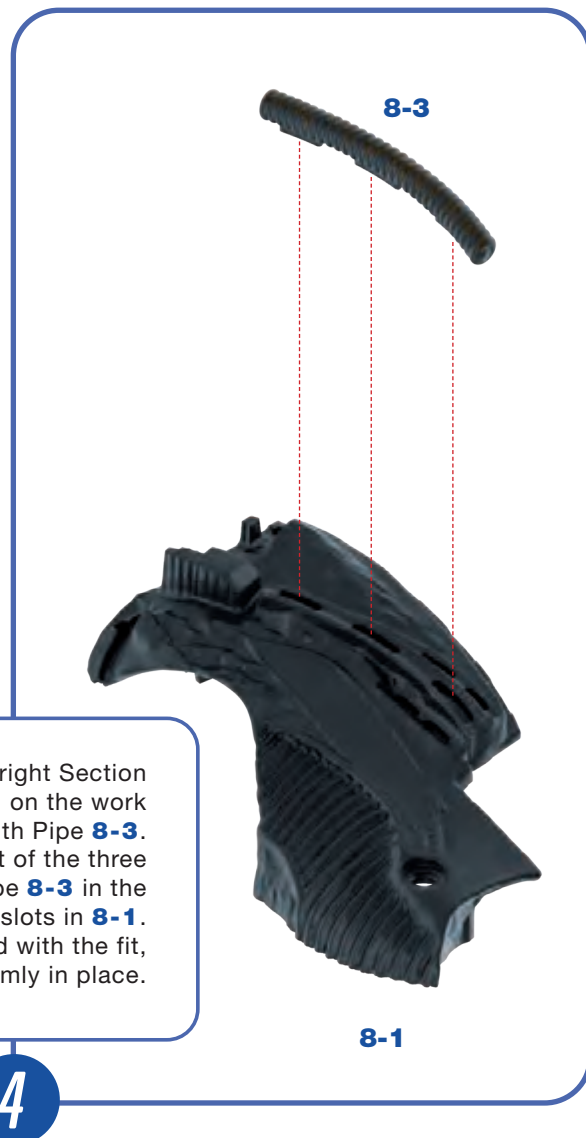

4

Place the Front-right Section of the Head **8-1** on the work surface along with Pipe **8-3**. Check the fit of the three tabs on Pipe **8-3** in the corresponding slots in **8-1**. When satisfied with the fit, glue firmly in place.

KIT 8: FRONT-RIGHT SECTION OF THE HEAD

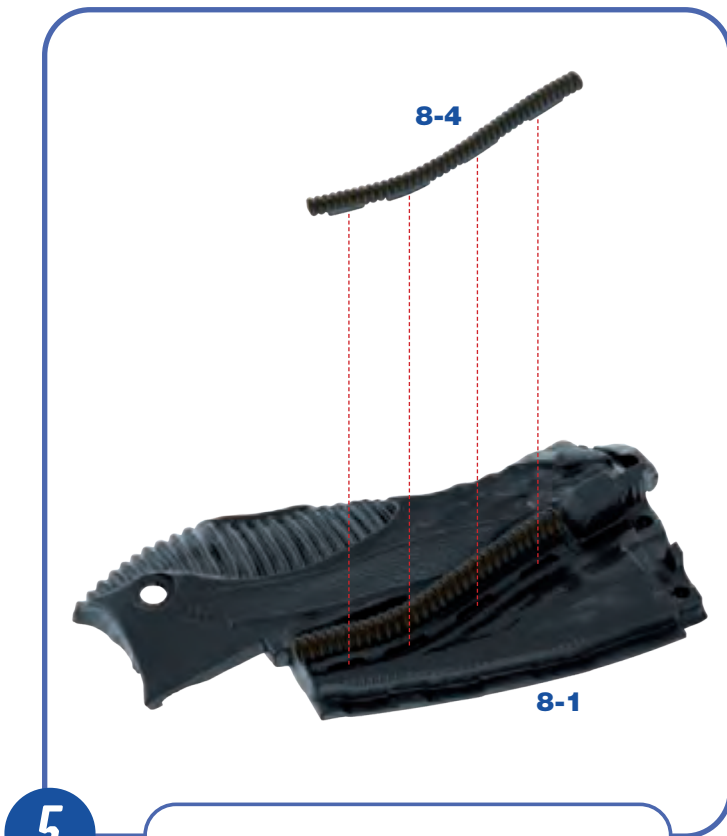

Turn the Front-right Section of the Head **8-1** around so that it is positioned as shown. Test-fit the four tabs on Pipe **8-4** into the corresponding slots on head section **8-1**. As before, apply a little glue to secure the part in place.

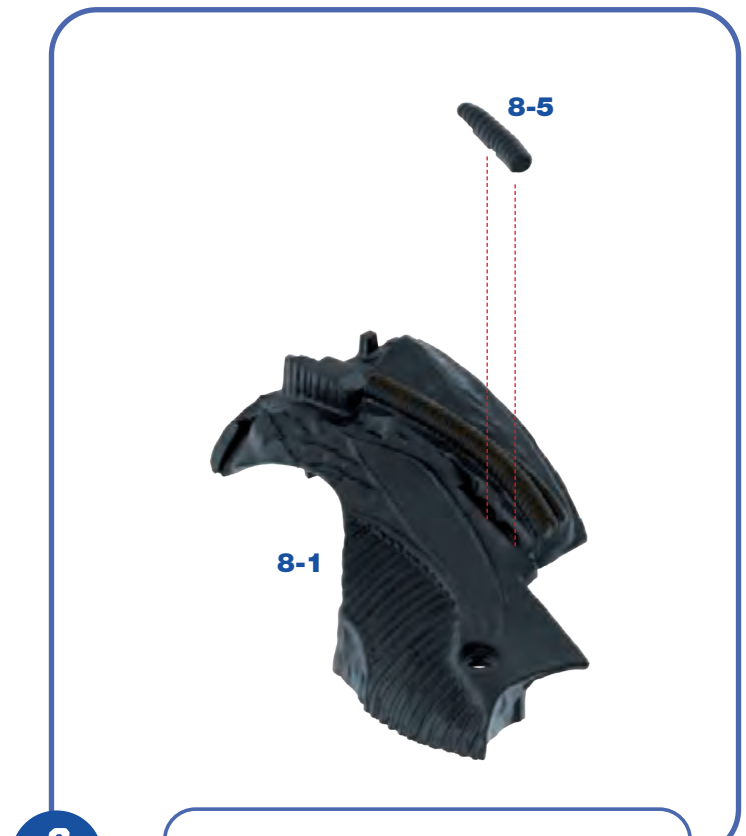

Finally, check that the tabs on Pipe **8-5** fit properly in the slots indicated in the Head section **8-1**. Apply a little glue and secure firmly in place.

KIT 8 IS COMPLETE



*MORE PARTS HAVE BEEN
FITTED TO THE HEAD.*

! Keep the Pipes **8-6** and **8-7** safely aside until they are needed in a future kit.

KIT 9: CENTRE-RIGHT SECTION OF THE HEAD

In this kit you'll continue building the centre right side of the Xenomorph's head and adding appendages.

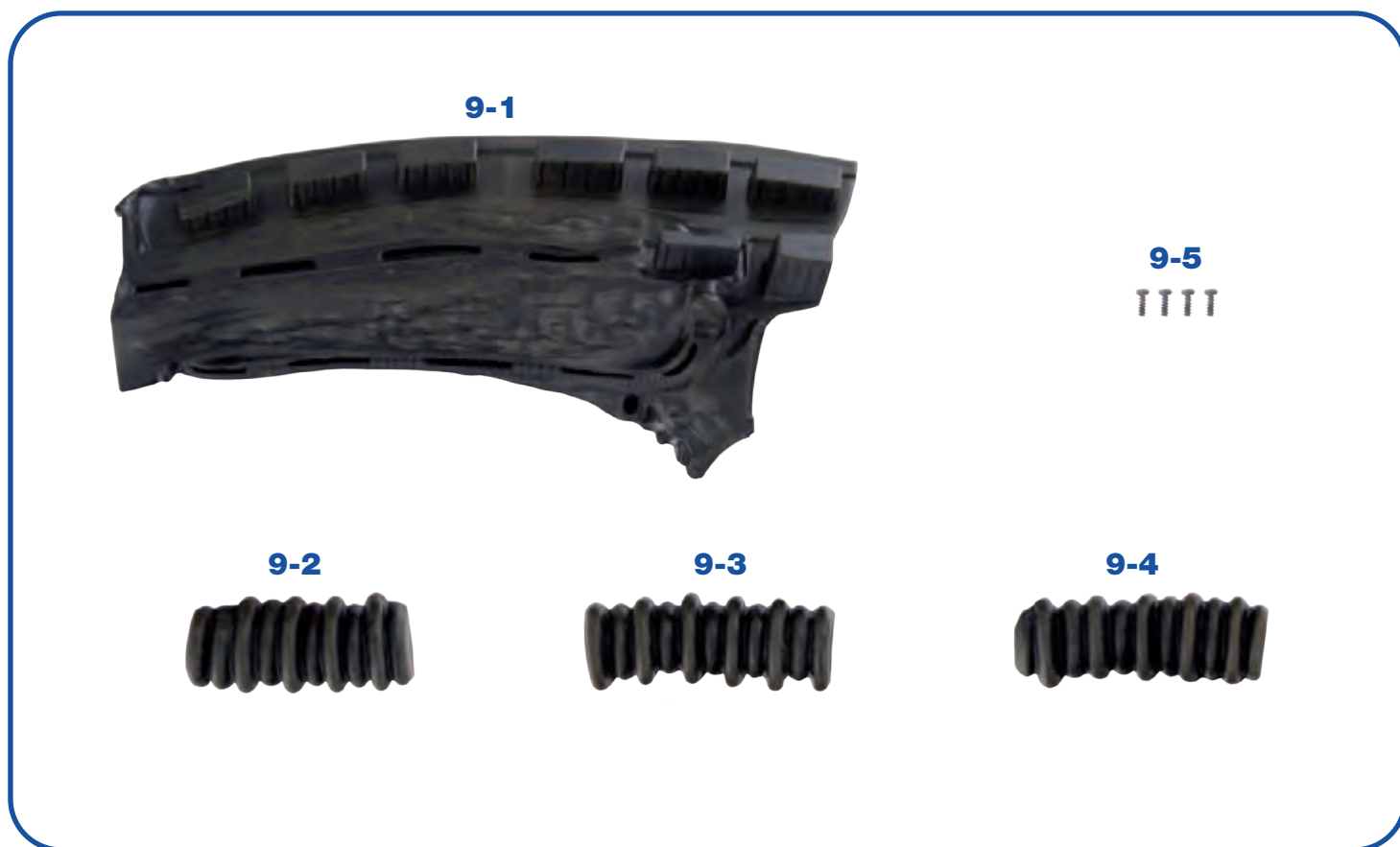

PARTS SUPPLIED

Ref.	Name	Qty.	Ref.	Name	Qty.
9-1	Centre-right Section of the Head	1	9-4	Pipe 3 (centre-right head section)	1
9-2	Pipe 1 (centre-right head section)	1	9-5	2.3x6 mm screws	4
9-3	Pipe 2 (centre-right head section)	1			

*A spare screw is supplied in case of loss or damage.

KIT 9: CENTRE-RIGHT SECTION OF THE HEAD

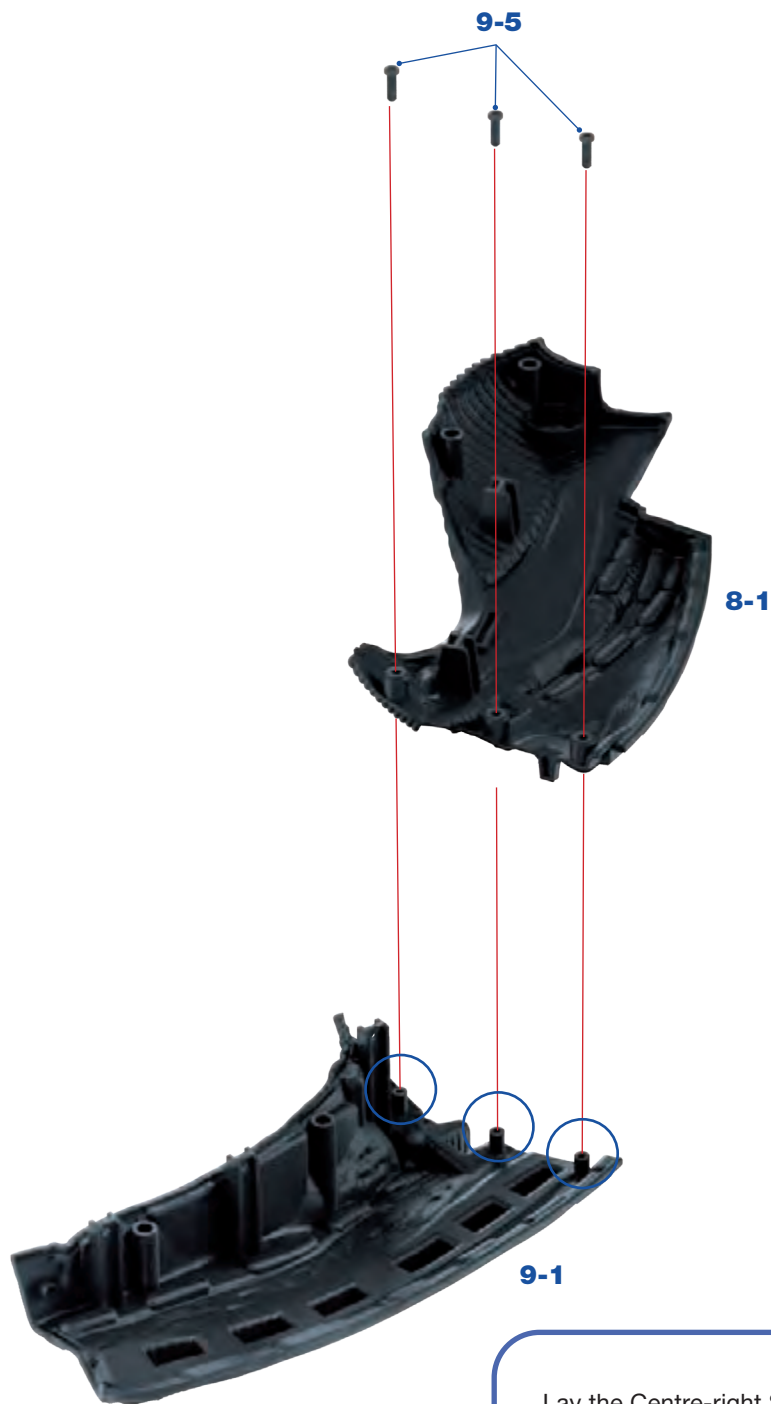

Lay the Centre-right Section of the Head **9-1** upside down on the work surface and note the three raised screw sockets at one end (circled). Take the Front-right Section of the Head **8-1** from the previous kit. To join the parts together, fit the three sockets on part **8-1** over the raised screw sockets on part **9-1**, as shown and secure in place with three 2.3x6mm screws **9-5**.

KIT 9: CENTRE-RIGHT SECTION OF THE HEAD

Turn the assembly over and take the two Pipes **8-6** and **8-7** from the previous kit. Test fit Pipe **8-7** over the join between the two parts and when certain of a good fit, apply a little glue and secure firmly in place. Repeat the same with Pipe **8-6**, fitting it as shown in the diagram.



2

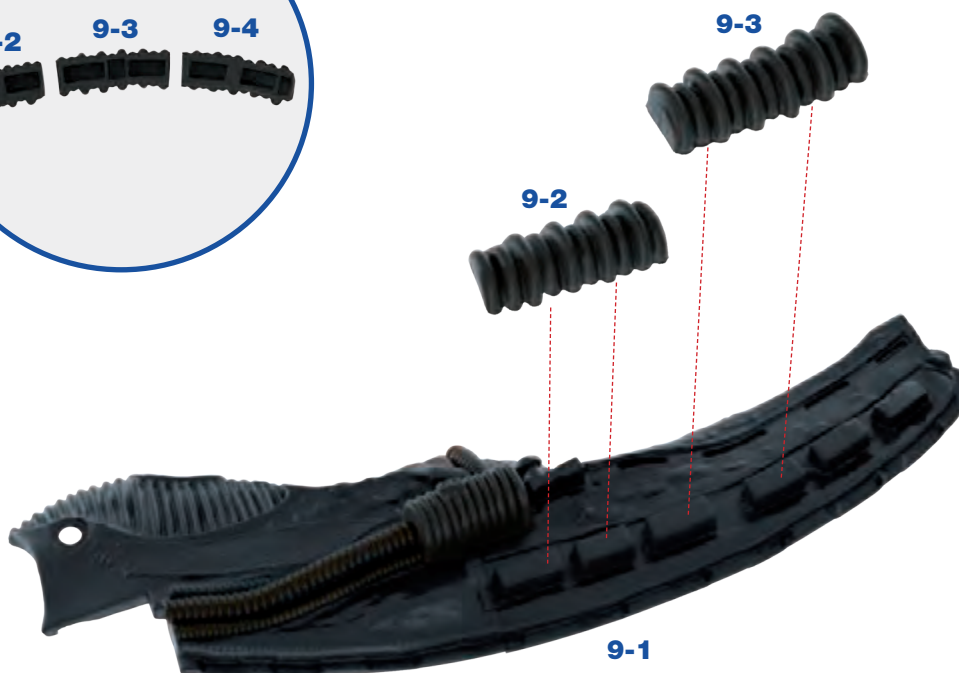

Study the inset picture (left) to differentiate between parts **9-2**, **9-3** and **9-4**. Note how the underside of each part has a slightly different layout. When certain that **9-2** and **9-3** fit neatly over the rectangular blocks on **9-1**, apply a little glue and secure the parts firmly in place.

3

KIT 9: CENTRE-RIGHT SECTION OF THE HEAD

Repeat the previous step to fit the remaining Pipe **9-4** over the rectangular blocks at the end of Head Section **9-1**.



4

KIT 9 IS COMPLETE



*MORE OF THE HEAD HAS BEEN
CONSTRUCTED AND PIPES HAVE
BEEN FITTED TO THE SIDES.*

KIT 10: THE HEAD AND NECK

In this kit you will continue the assembly of the head and its appendages and start to assemble the first parts of the neck.



PARTS SUPPLIED

Ref.	Name	Qty.	Ref.	Name	Qty.
10-1	Pipe 4 (centre-right head section)	1	10-4	Pipe 7 (centre-right head section)	1
10-2	Pipe 5 (centre-right head section)	1	10-5	Washer	1
10-3	Pipe 6 (centre-right head section)	1	10-6	Neck (part 2)	1

KIT 10: THE HEAD AND NECK

1

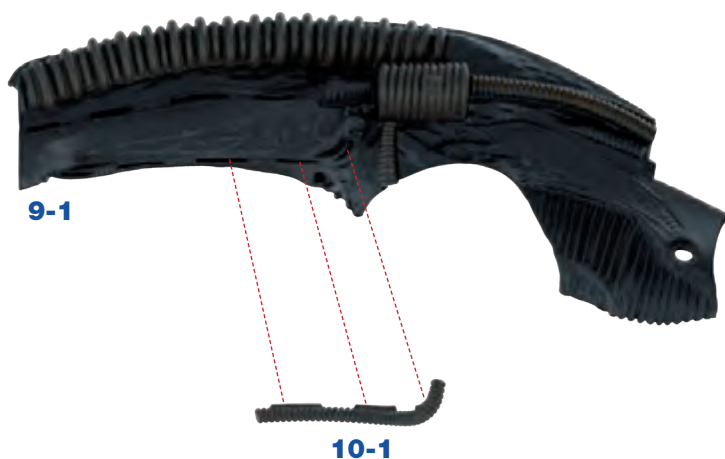

Take the Centre-right Head assembly **9-1** from the previous kit. After checking the fit, apply a little glue to the tabs of Pipe **10-1** and fit them, as shown, into the slots in the Head section **9-1**. Hold firmly in place until the glue has set.

2

In a similar way, test-fit Pipe **10-2** in place on the Head **9-1** before applying glue to the tabs and securing in place.

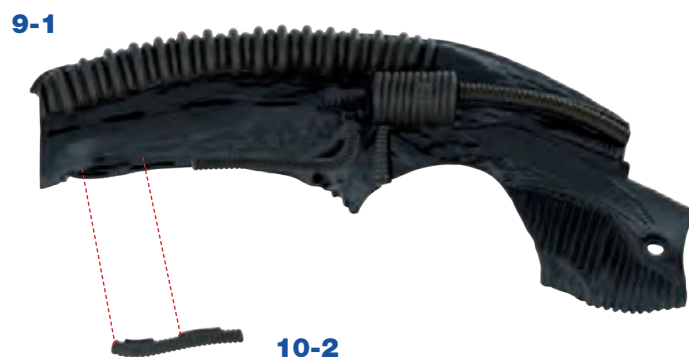

3

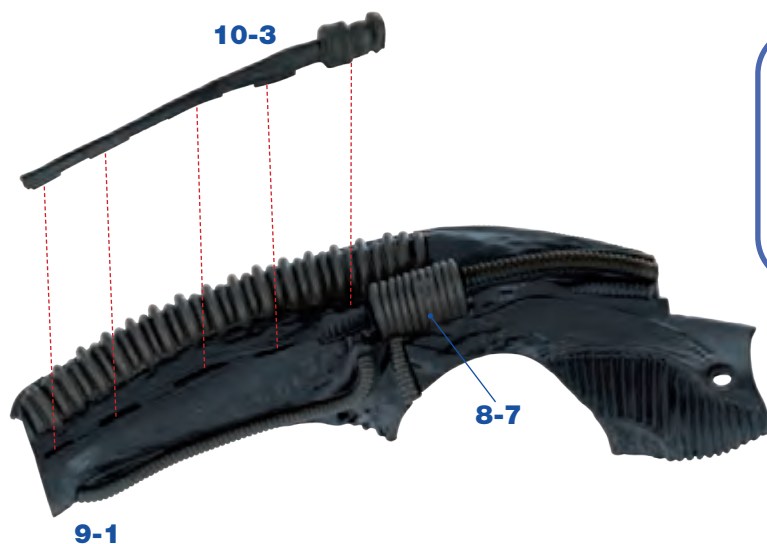

Take Pipe **10-3** and check that it fits correctly onto the Head section **9-1**. Apply a little glue to the tabs and secure the part in place by slotting them into the grooves, as shown.

KIT 10: THE HEAD AND NECK

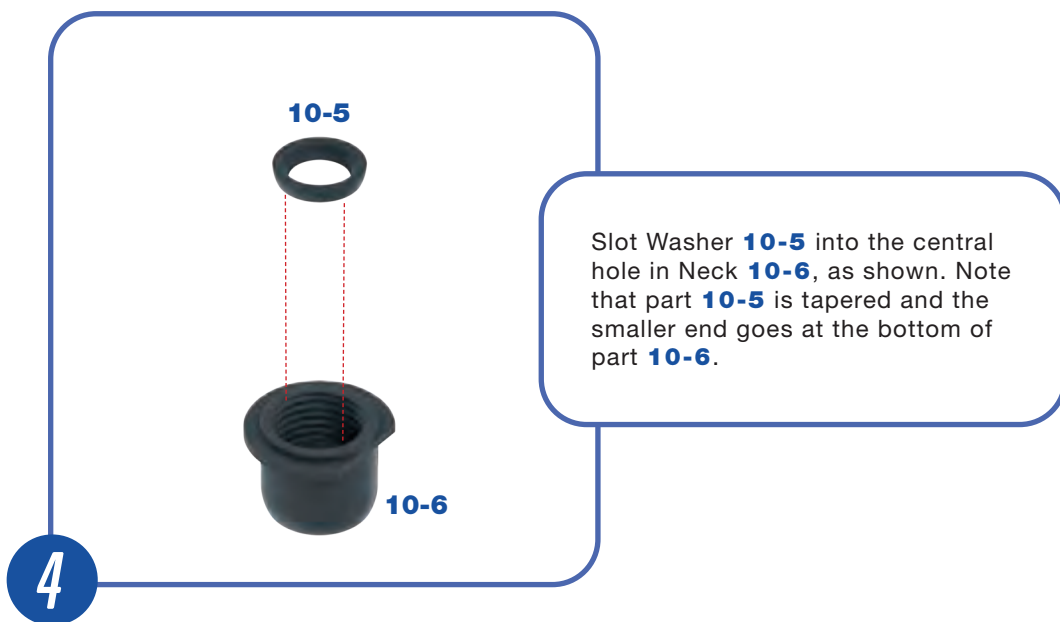

KIT 10 IS COMPLETE

*FURTHER PARTS HAVE BEEN
FIXED TO THE HEAD AND WORK
HAS STARTED ON THE NECK.*



! Keep parts **10-4**, **10-5** and **10-6** safely aside until they are needed in a future kit.

KIT 11: THE NECK

In this kit you will continue to assemble the pieces that form the neck of the Xenomorph.

11-1



11-2



11-3



11-4



11-5



PARTS SUPPLIED

Réf.	Nom	Qté.		Réf.	Nom	Qté.
11-1	Skull Attachment Plate	1		11-4	Rod	1
11-2	Cap	1		11-5	Pin	1
11-3	Cover	1				

KIT 11: THE NECK

11-4



10-5

10-6

1

Take Neck parts **10-5** and **10-6** which were prepared in the previous kit. Insert the thin end of Rod **11-4** into the hole in the assembly **10-5/10-6**, as shown. Observe how the ball on the Rod **11-4** moves within the Washer **10-5**.

11-2

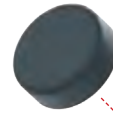

10-5

10-6

11-4

2

With the ball end of Rod **11-4** inside the assembly **10-5/10-6**, fully insert Cap **11-2** with the flat side at the top.

11-3



10-6

3

Screw the Cover **11-3** into Neck **10-6** and tighten with a large screwdriver. It screws onto an internal thread inside part **10-6**. The ball joint will need to be stiff so that it can hold the head in place when adjusted.

KIT 11 IS COMPLETE



THE BALL JOINT OF THE NECK HAS BEEN ASSEMBLED.



! Keep parts **11-1** and **11-5** safely aside until they are needed in the next kit.

KIT 12: THE HEAD AND SKULL

In this kit you will continue to assemble different parts of the head and skull.

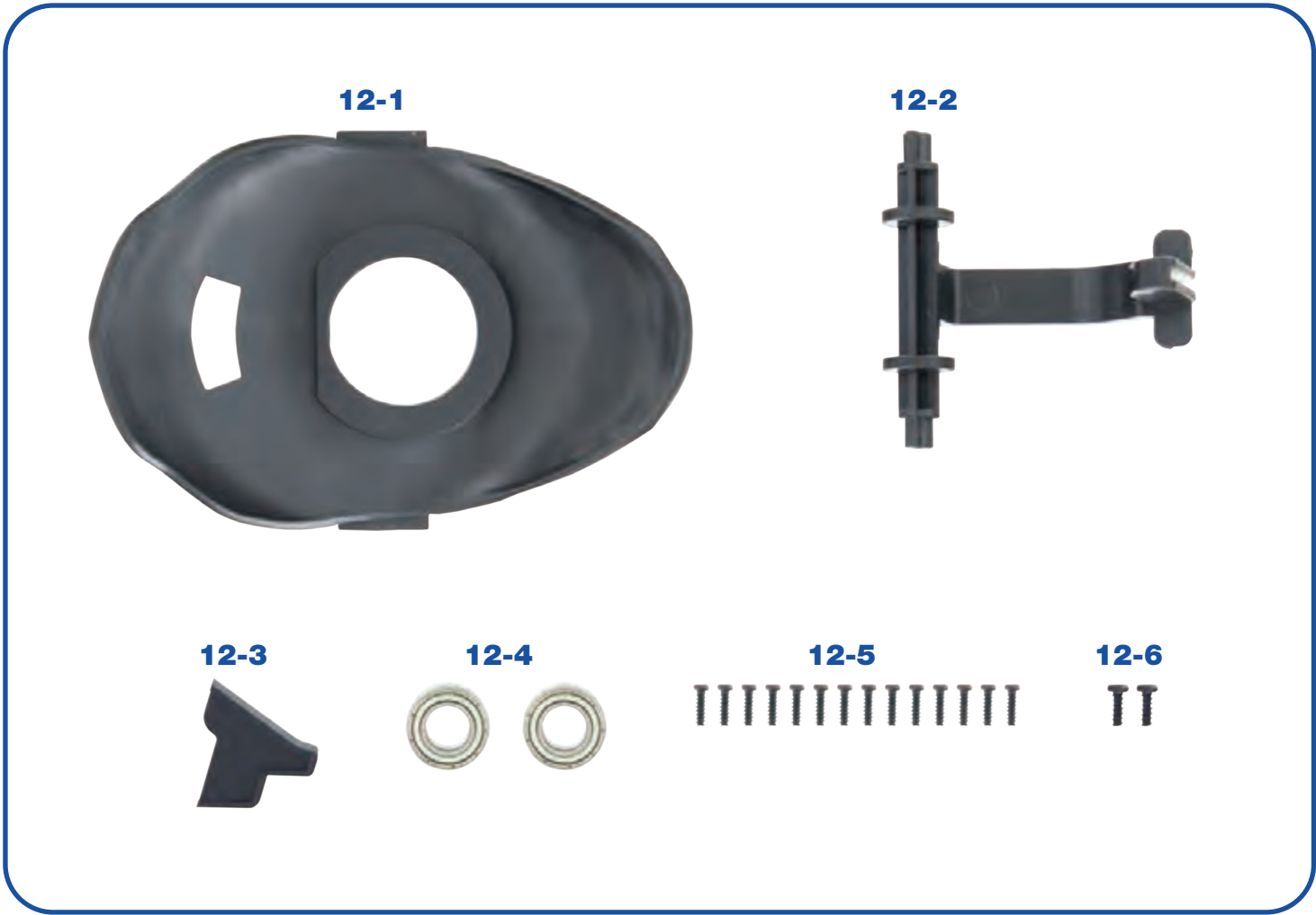

PARTS SUPPLIED

Ref.	Name	Qty.	Ref.	Name	Qty.
12-1	Underside of Head	1	12-4	Bearings	2
12-2	Lower Jaw 1	1	12-5	2.3x6mm screws	14*
12-3	Lower Jaw 2	1	12-6	2x6mm screws	2*

*A spare screw of each type is supplied in case of loss or damage.

KIT 12: THE HEAD AND SKULL

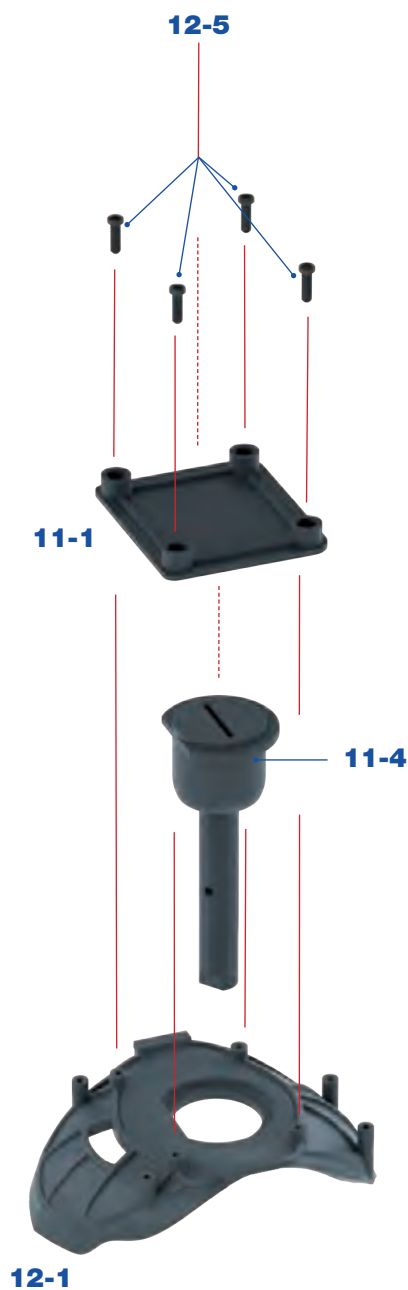

Take the ball joint assembly **11-4** and the Skull Attachment Plate **11-1** from the previous kit along with Head **12-1**. Take note of the flat side at the top of the ball joint assembly **11-4** which fits into a correspondingly shaped recess in part **12-1**. Insert the ball joint assembly **11-4** through part **12-1**. Next, the Skull Attachment Plate **11-1** is fitted in place using four 2.3x6mm screws **12-5**. There is a shaped rib on the underside of the plate (inset) to match the shaped recess in part **12-1**. The screw sockets on part **11-1** face upwards, as shown.



Fit a Bearing **12-4** onto each end of the Lower Jaw 2 pieces **12-2**, as shown.

KIT 12: THE HEAD AND SKULL

3



Take the left head assembly **6-1/7-1** which was constructed in kit 7. Insert the tab at the side of Head **12-1** (circled) into the slot in the head section **6-1** (arrow). Orientate the Lower Jaw 1 **12-2** as shown and fit the end into the hole at the front of the head assembly **6-1/7-1**, as shown.

4

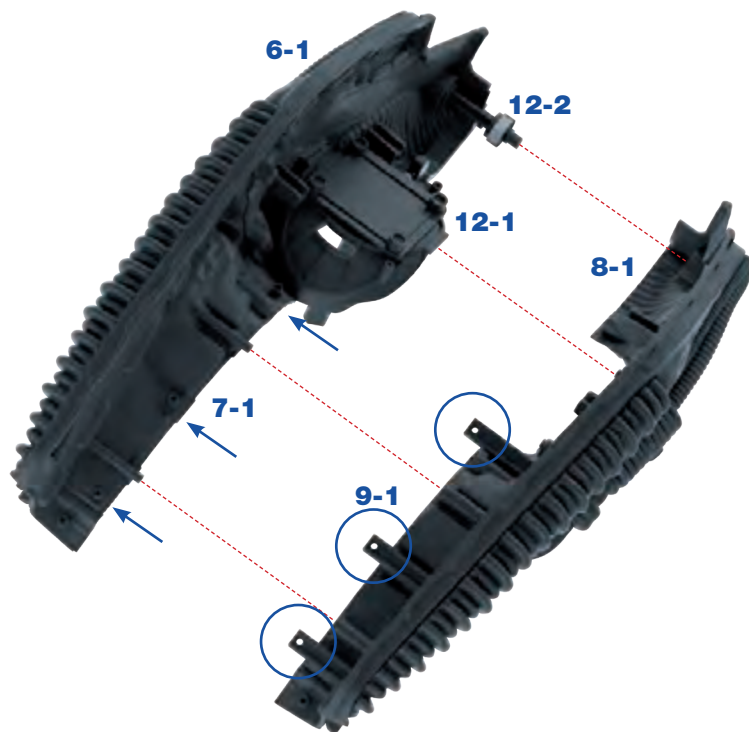

The right head assembly **8-1/9-1**, which was last worked upon in kit 10, is now joined to the left head assembly **6-1/7-1**. Bring the two sections together, firstly by inserting the free end of the Jaw **12-2** into the hole at the front of head part **8-1**. Next, insert the tab at the side of the Head **12-1** into the corresponding slot in the right head assembly part **8-1**. Lastly, align the tabs on **9-1** (circled) with the screw sockets on **7-1** (arrows). These actions are completed at the same time.

5



After making sure that the left and right sections are flush together, secure the parts together with seven 2.3x6mm screws **12-5**.

KIT 12: THE HEAD AND SKULL

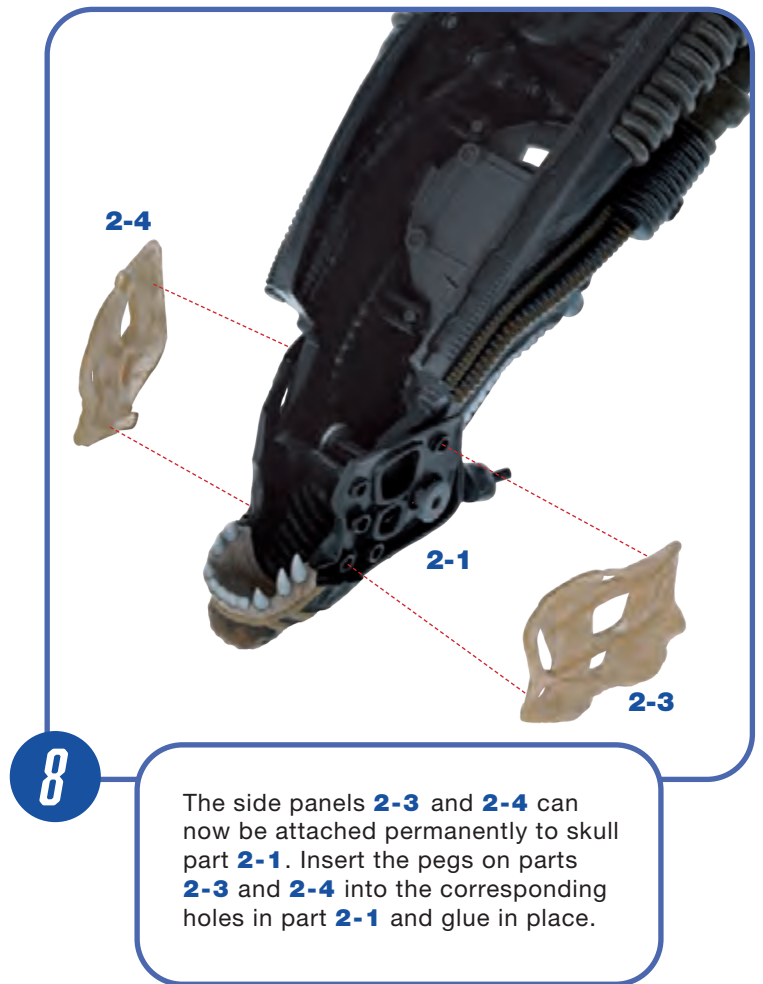
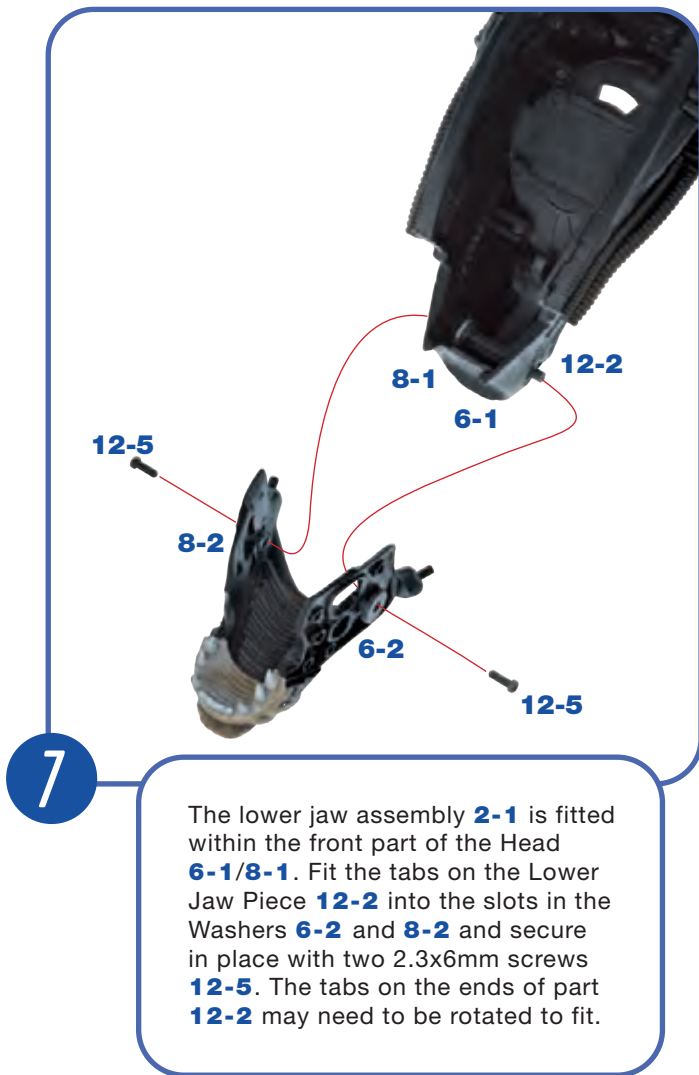
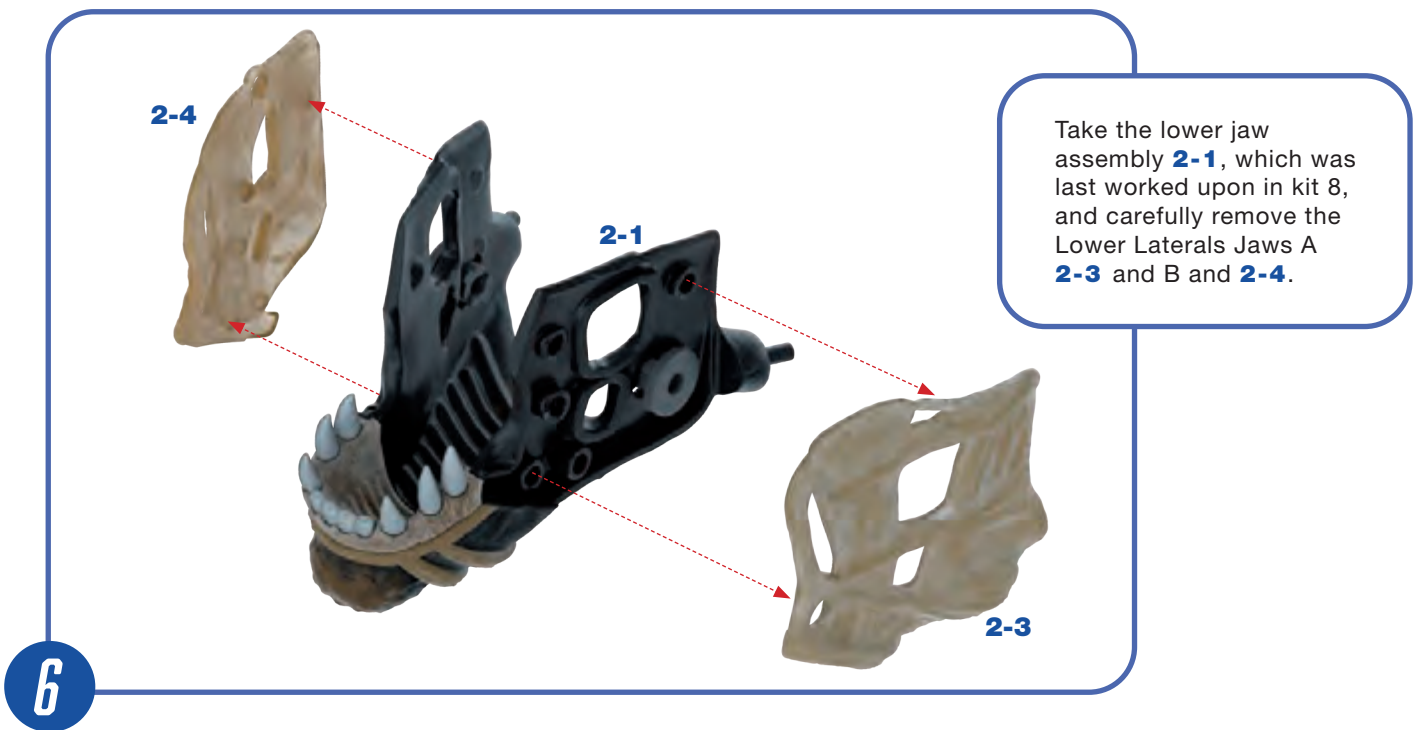

KIT 12: THE HEAD AND SKULL

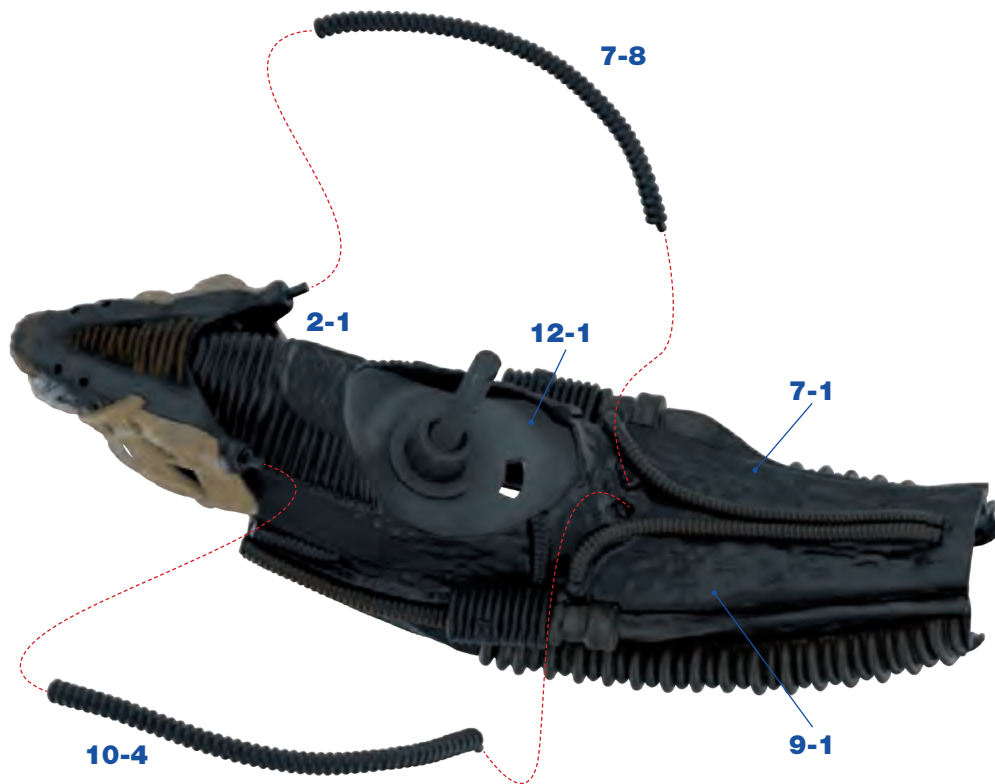

9

Turn the head assembly upside down and take Pipes **7-8** and **10-4** which were supplied with kits 7 and 10 respectively. One end of part **7-8** has a peg which inserts into a hole in part **7-1**. The other end fits onto the peg on part **2-1**, as shown. Glue in place. Repeat the process to fit the right hand Pipe **10-4**.

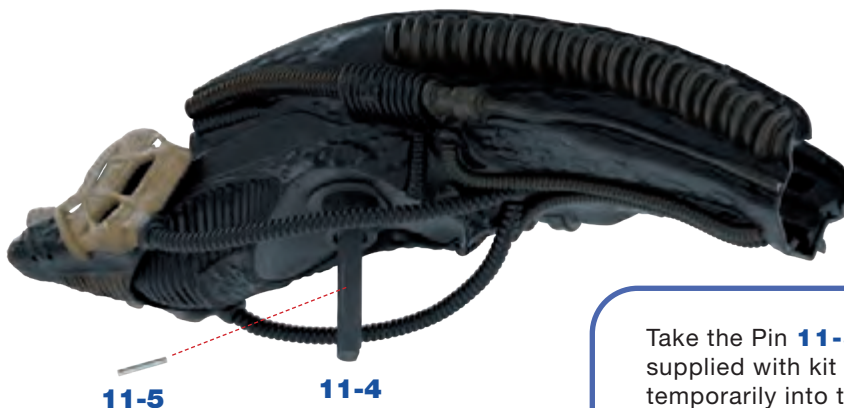

10

Take the Pin **11-5** which was supplied with kit 11. Insert it temporarily into the central hole of the ball joint Rod **11-4**. The smooth end of the pin should be inserted first. Use masking tape, or similar, to hold it in place.

KIT 12: THE HEAD AND SKULL

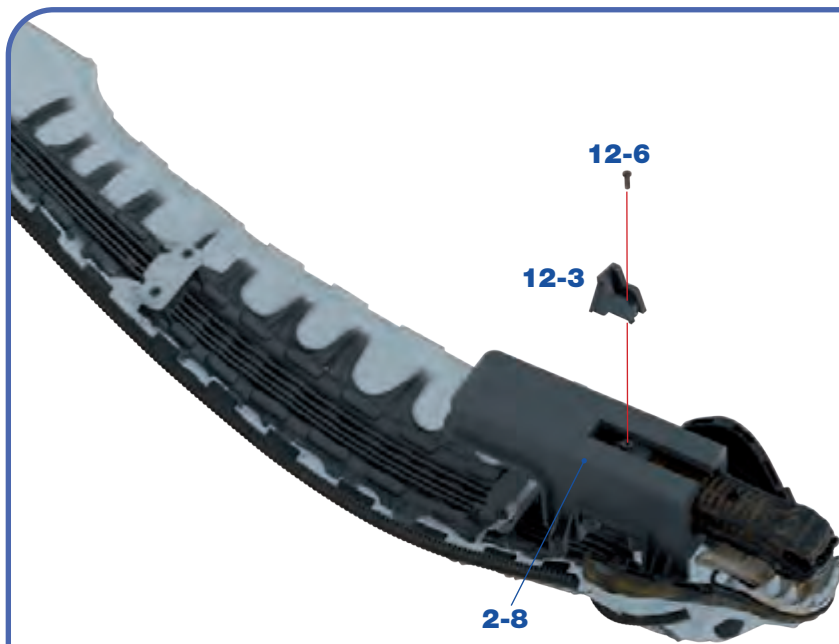

Lastly, position the skull assembly, last worked on in kit 5, on the work surface. Study the photograph carefully and note how the Lower Jaw Piece **12-3** aligns with a raised screw socket on Gearbox **2-8**. Fix in place using a 2x6mm screw **12-6**.

11

KIT 12 AND PACK 2 IS NOW COMPLETE

SECTIONS OF THE HEAD HAVE BEEN JOINED TOGETHER. ALSO, FURTHER PARTS HAVE BEEN FITTED TO THE HEAD AND SKULL.

