

# ALIEN

SPECTACULAR

**1:2**  
SCALE

**EASY**  
ASSEMBLY

BUILD THE  
TERRIFYING  
XENOMORPH  
FROM ALIEN

**PACK 5**  
KITS 29 - 36

NON CONTRACTUAL VISUAL

# ALIEN

## PACK 5 | BUILD INSTRUCTIONS

### KIT 29

THE RIGHT RIBS  
AND THE RIGHT THIGH (I)

### KIT 30

THE RIGHT RIBS  
AND THE RIGHT THIGH (II)

### KIT 31

THE RIGHT THIGH

### KIT 32

THE LEFT RIBS AND  
THE RIGHT FEMUR (I)

### KIT 33

THE LEFT RIBS AND  
THE RIGHT FEMUR (II)

### KIT 34

THE LEFT RIBS AND  
THE RIGHT FEMUR (III)

### KIT 35

THE LEFT RIBS AND  
THE RIGHT FEMUR (IV)

### KIT 36

THE LEFT RIBS AND  
THE RIGHT THIGH (I)

**WARNING:** Some parts are assembled using magnets. These magnets can cause serious injury if they are swallowed. Keep away from children. If you suspect a magnet has been swallowed, seek medical help straight away.

Some parts may have sharp edges, please handle them with care.

The installation of electronic parts must always be carried out by an adult. When replacing batteries, use the same type of batteries.

Please ensure that the battery compartment is securely fastened before you use the model.

Used batteries should be recycled.

Please make sure to check with your local council how batteries should be disposed of in your area. Batteries can present a choking danger to small children and may cause serious harm if ingested. Do not leave them lying around and keep any spare batteries locked away at all times.



*STEPS & TIPS ONLINE*

**Hachette Partworks Ltd**, 4th Floor, Jordan House,  
47 Brunswick Place, London N1 6EB

[www.hachettepartworks.com](http://www.hachettepartworks.com)

© 2023/2024 Hachette Partworks Ltd.

© 2023 20th Century Studios.

ALL RIGHTS RESERVED

All parts belong to a kit. Collectors item for adults.

Not suitable for children under 14.





# KIT 29: THE RIGHT RIBS AND THE RIGHT THIGH (I)

In this kit you will continue to work on the Xenomorph's right ribs and begin assembly of the right thigh and its attachments.



## PARTS SUPPLIED

Ref.	Name	Qty.	Ref.	Name	Qty.
29-1	Right Rib	1	29-4	Pipe B2 (right thigh)	1
29-2	Right Thigh Outer Skin	1	29-5	Magnets	4
29-3	Pipe B1 (right thigh)	1	29-6	2.3x6mm screws (1 spare)	2

**KIT 29: THE RIGHT RIBS AND THE RIGHT THIGH (I)**

1



29-6

27-2

19-3

29-1

Take the rib support assembly **19-3** from the previous kit. Fit the raised screw socket on the Rib **29-1** into the hole next to Rib **27-2**. Fix in place with a 2.3x6mm screw **29-6**. Put the assembly aside until the next kit.

2



29-3 (B1)

29-2

Take the Outer Skin **29-2** and test-fit the Pipe B1 **29-3** into the slots, as shown. There is also a peg at one end which fits into a corresponding hole. When sure of a good fit, glue firmly in place. Remember to remove the label on the pipe before fitting.

3

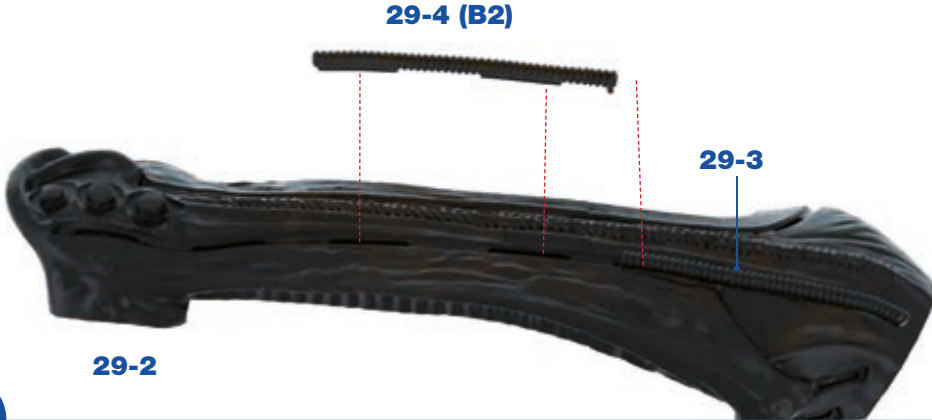

29-4 (B2)

29-3

29-2

Test fit the tabs on Pipe B2 **29-4** in the slots on Skin **29-2**, which continue along from pipe **29-3**. Again, there is a peg at one end which fits into a corresponding hole. After checking the fit, glue firmly in place.

## KIT 29: THE RIGHT RIBS AND THE RIGHT THIGH (I)

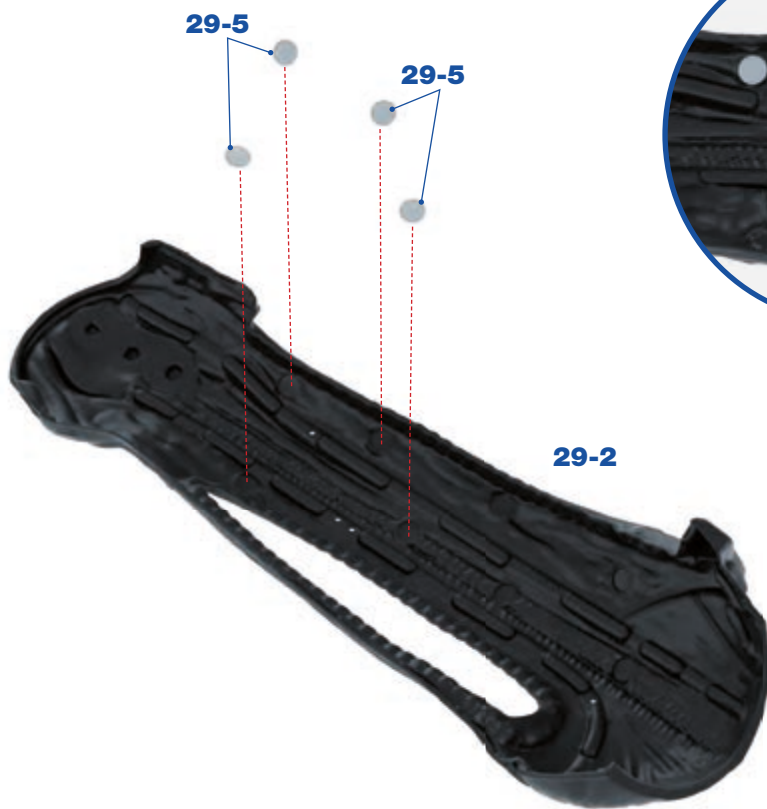

Study the diagram carefully and note the position of the four Magnets **29-5**. Glue the Magnets **29-5** into the circular recesses on the inside of the Outer Skin **29-2**. It doesn't matter which way round the magnets are fitted.

4

### KIT 29 IS COMPLETE



*ANOTHER RIB HAS BEEN ADDED TO THE FRAME AND WORK HAS BEGUN ON THE RIGHT THIGH.*

# KIT 30: THE RIGHT RIBS AND THE RIGHT THIGH (II)

In this kit you will continue to work on the Xenomorph's right ribs and thigh.

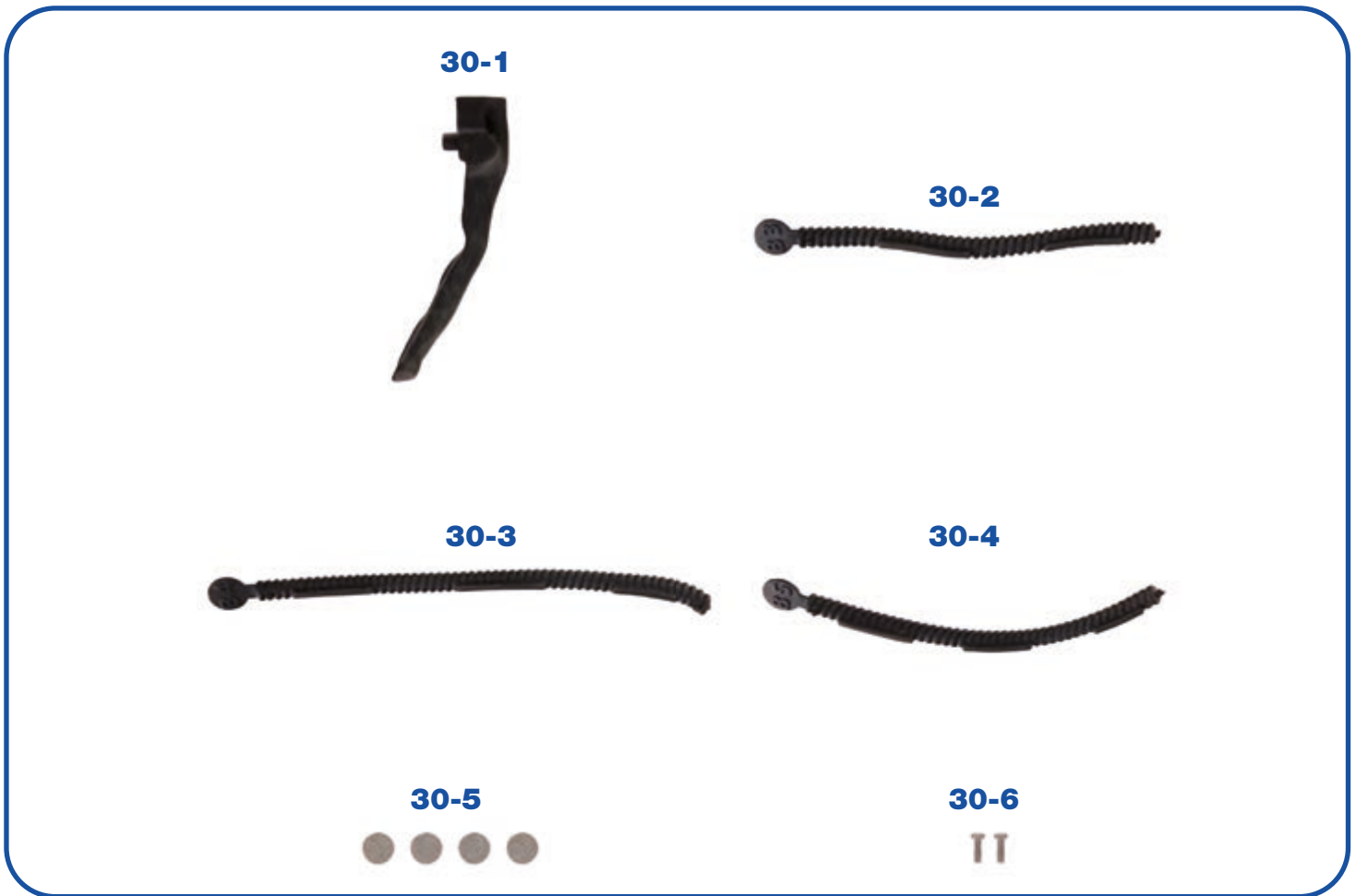

## PARTS SUPPLIED

Ref.	Name	Qty.	Ref.	Name	Qty.
30-1	Right Rib	1	30-4	Pipe (right thigh) B5	1
30-2	Pipe (right thigh) B3	1	30-5	Magnets	4
30-3	Pipe (right thigh) B4	1	30-6	2.3x6mm screws (1 spare)	2

## KIT 30: THE RIGHT RIBS AND THE RIGHT THIGH (II)



1

Take the rib assembly **19-3** from the previous kit and fit the raised screw socket on Rib **30-1** into the remaining hole. Fix in place with a 2.3x6mm screw **30-6**. Keep the assembly safely aside.



## KIT 30: THE RIGHT RIBS AND THE RIGHT THIGH (II)

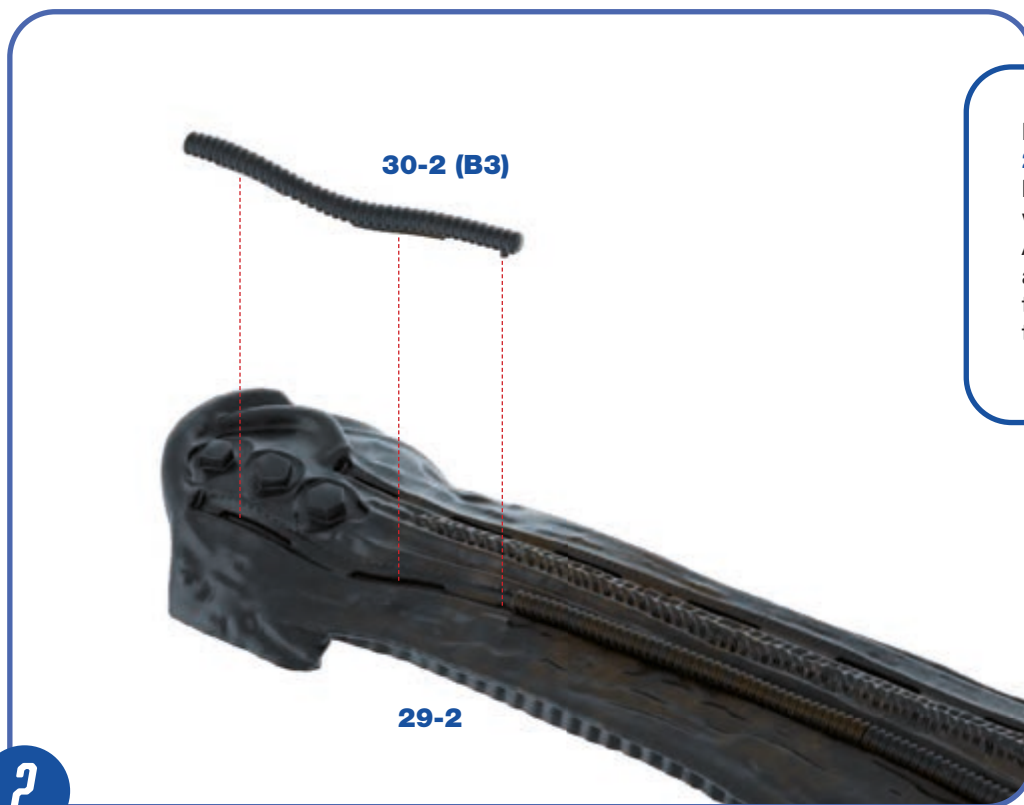

Next, take the Thigh Outer Skin **29-2** which was worked on in the last kit. The line of pipes continues with the fitting of Pipe B3 **30-2**. After test-fitting the Pipe **30-2**, as shown, apply a little glue to the tabs and hold firmly in place until the glue sets.



Repeat the previous step to fit Pipe B4 **30-3** onto the Thigh Outer Skin **29-2**. Note that this pipe is fitted to the middle of the skin and there is a peg at each end.

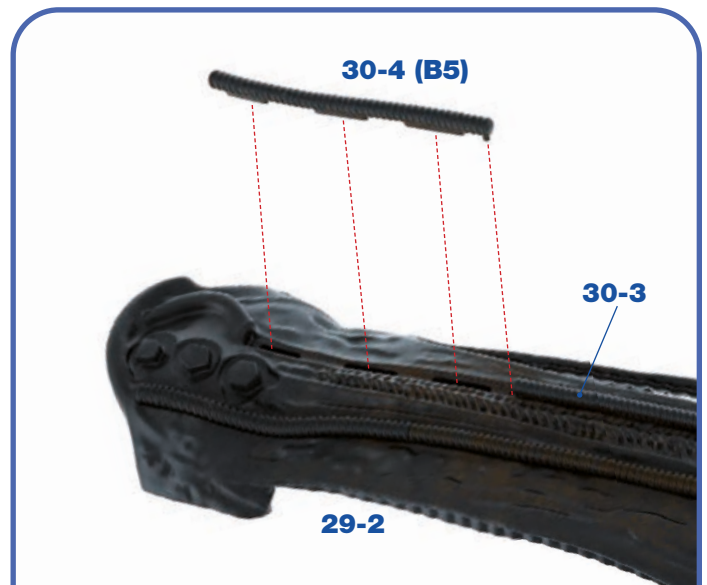

Pipe B5 **30-4** fits next to Pipe **30-3**, as shown. Check the fit of Pipe B5 **30-4** on the outer skin **29-2** and glue firmly in place. Note that there is a peg at one end of the pipe. Allow the glue to dry before continuing.



## KIT 30: THE RIGHT RIBS AND THE RIGHT THIGH (II)

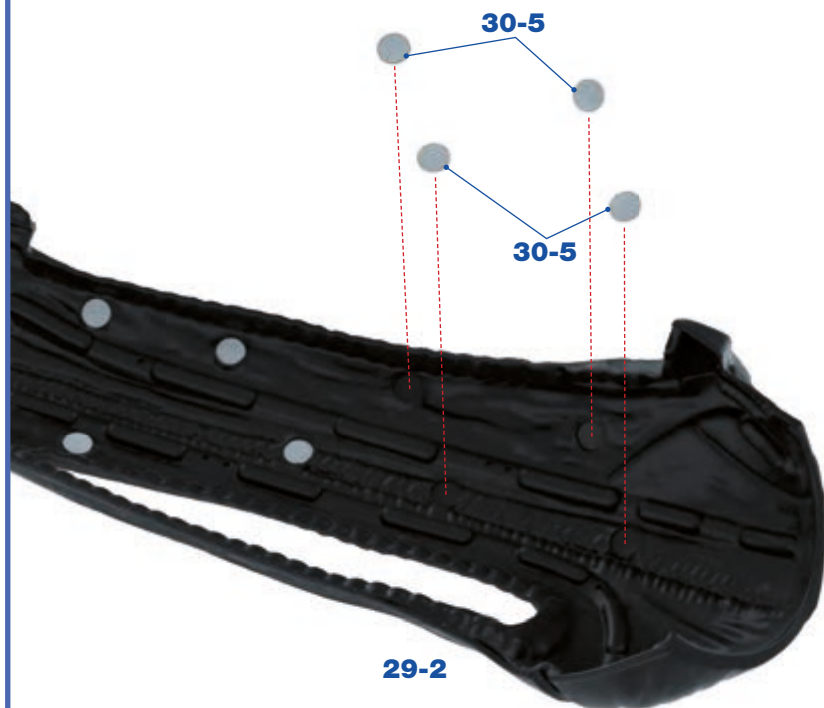

Turn the outer skin **29-2** over and glue four Magnets **30-5** into the remaining four circular recesses. It doesn't matter which way round the magnets are fitted.

5

### KIT 30 IS COMPLETE



*A RIB AND MORE PIPES HAVE BEEN FITTED AS WELL AS FURTHER MAGNETS.*

# KIT 31:THE RIGHT THIGH

In this kit you will continue to assemble the component parts of the Xenomorph’s right thigh.

31-1



31-2



31-3



31-4



31-5



31-6



## PARTS SUPPLIED

Ref.	Name	Qty.	Ref.	Name	Qty.
31-1	Pipe (right thigh) B6	1	31-4	Skin Detail (right thigh) C2	1
31-2	Pipe (right thigh) B7	1	31-5	Skin Detail (right thigh) C3	1
31-3	Skin Detail (right thigh) C1	1	31-6	Magnets	8

**KIT 31: THE RIGHT THIGH**



**31-1 (B6)**

**29-2**

**1** Take the right thigh assembly **29-2** from the last kit. After test-fitting, secure Pipe B6 **31-1** in place with a little glue.



**29-2**

**31-1**

**31-2 (B7)**

**2** Repeat the previous step to fit Pipe B7 **31-2** onto the thigh assembly **29-2**. Pipe **31-2** is located just above Pipe **31-1**, as shown.



**31-3 (C1)**

**31-4 (C2)**

**31-5 (C3)**

**29-2**



Fit the Skin Details C1 **31-3**, C2 **31-4** and C3 **31-5** over the shaped studs at the other end of Thigh Skin **29-2**. Check that their orientation matches the recess in the skin. Secure each in place with a little glue.



## KIT 31: THE RIGHT THIGH

Take the femur assembly **28-2** which was last worked on in pack 4 - kit 28 and fit it inside the Thigh Skin **29-2**. Make sure that the magnets on the thigh skin are still firmly in place.

4

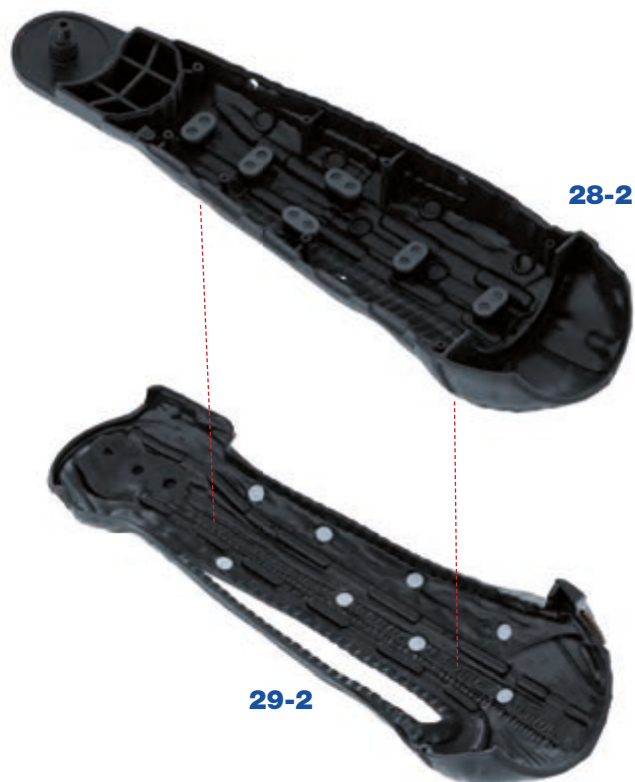

Four magnets **31-6** are now fitted to the femur assembly **26-2/28-2**. Before glueing in place check that the polarity of each Magnet **31-6** is orientated so that it is attracted to the magnet underneath. After glueing, make sure the magnets are pushed firmly into place.

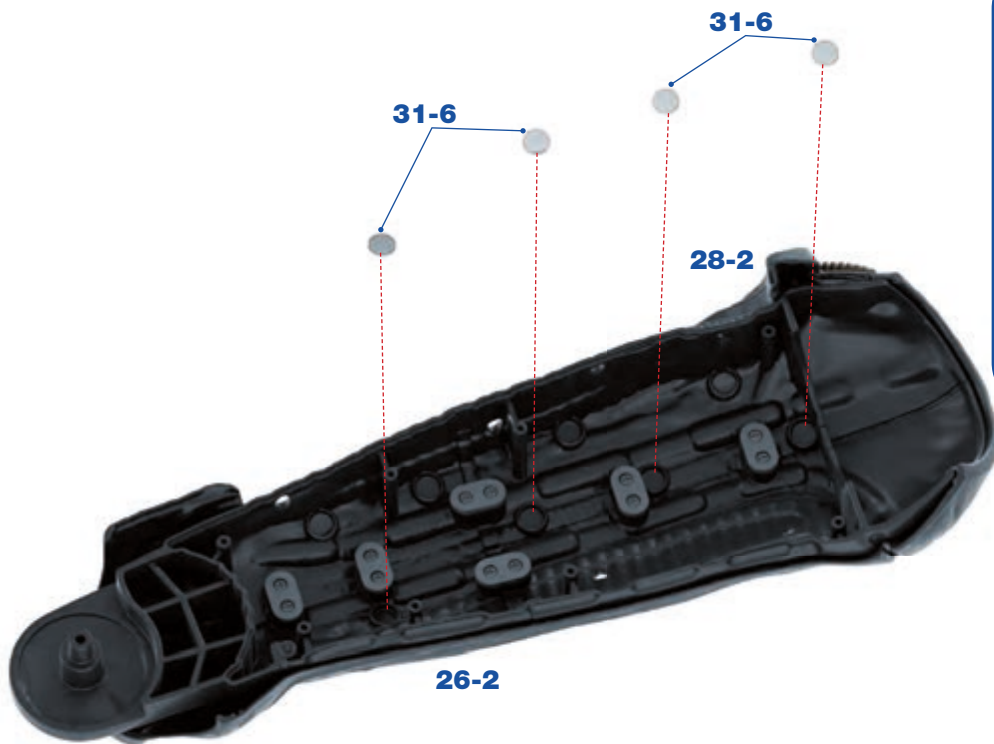

5

**KIT 31: THE RIGHT THIGH**

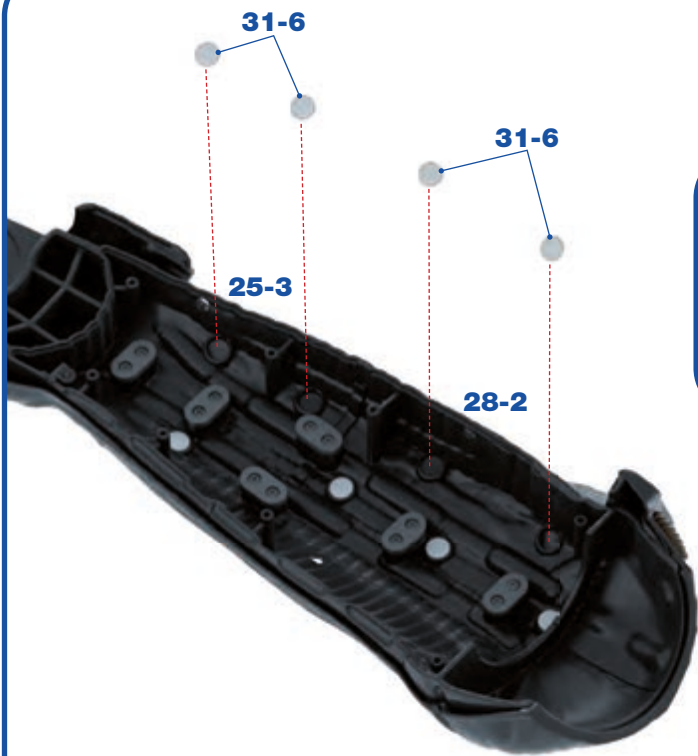

Repeat the previous step to glue the remaining four Magnets **31-6** to the femur assembly **25-3/28-2**. Again, make sure the magnets are pushed firmly into place.

**6**

**KIT 31 IS COMPLETE**



*SKIN PARTS HAVE BEEN  
ADDED AND MAGNETS  
FITTED TO THE FEMUR.*

# KIT 32: THE LEFT RIBS AND RIGHT FEMUR (I)

In this kit you will start to assemble the left ribs plus you will continue to build the right femur.



## PARTS SUPPLIED

Ref.	Name	Qty.	Ref.	Name	Qty.
32-1	Left Rib	1	32-5	Connector	1
32-2	Left Rib	1	32-6	2.3x6mm screw (1 spare)	2
32-3	Left Rib Support	1	32-7	2.3x4mm screw (1 spare)	3
32-4	Right Femur	1			



## KIT 32: THE LEFT RIBS AND THE RIGHT FEMUR (I)

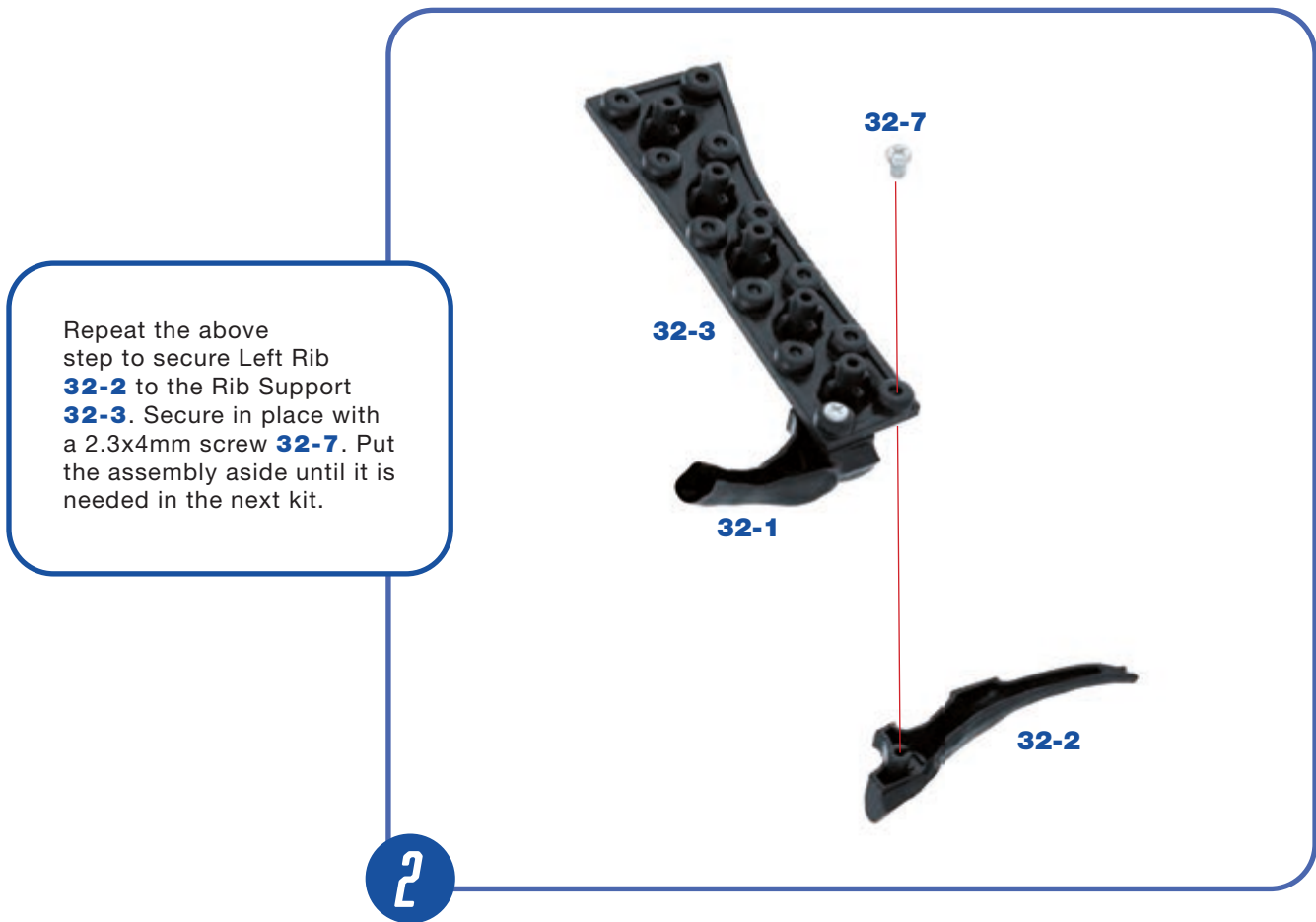
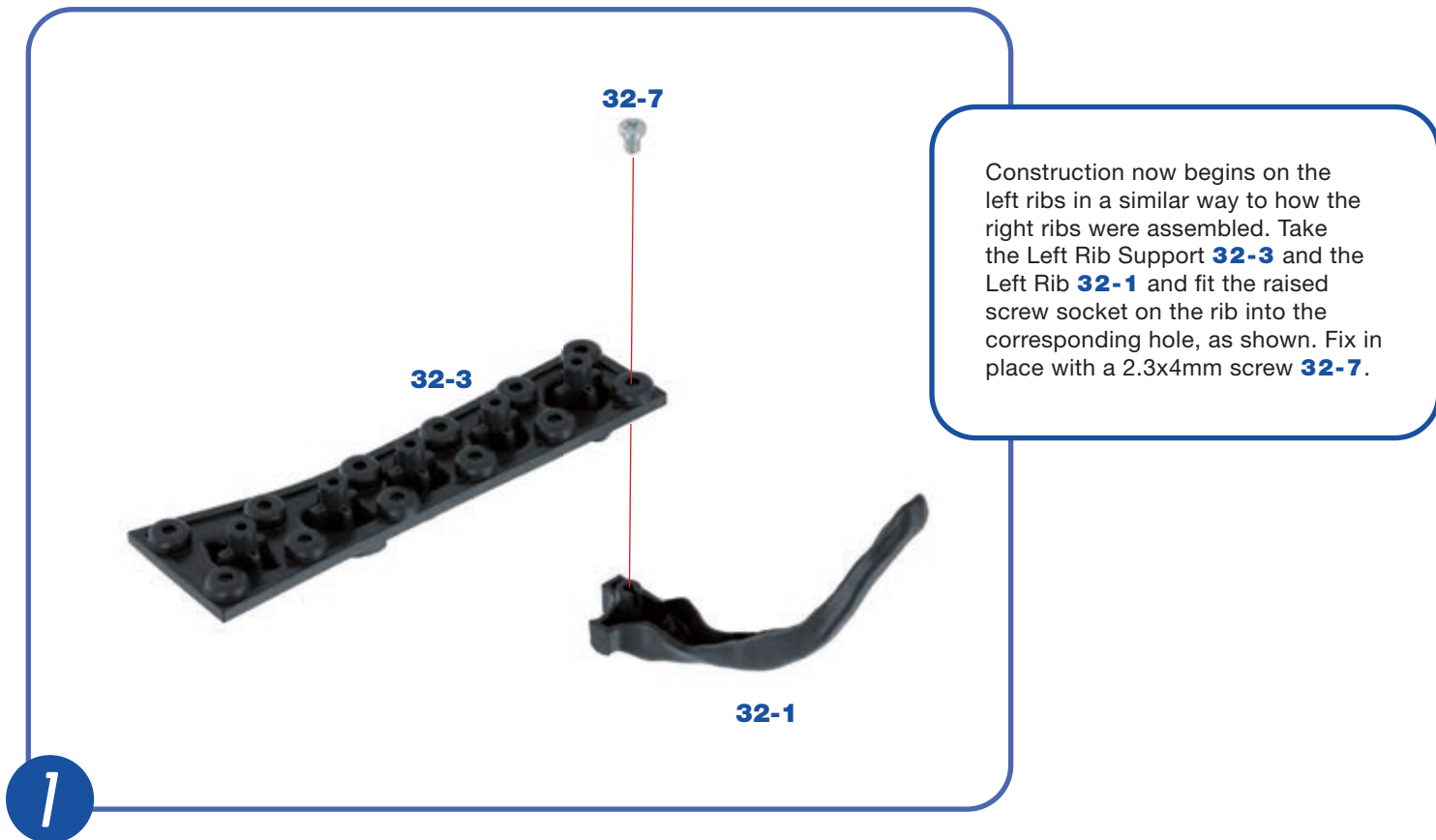

## KIT 32: THE LEFT RIBS AND THE RIGHT FEMUR (I)

32-5

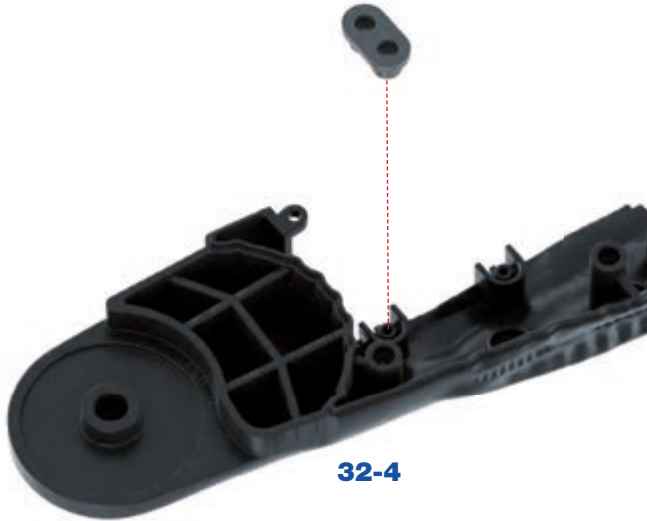

32-4

3

The Connector **32-5** is now fitted to the Right Femur **32-4**, as shown above. Note that the free end of the Connector **32-5** overhangs the edge.

32-6

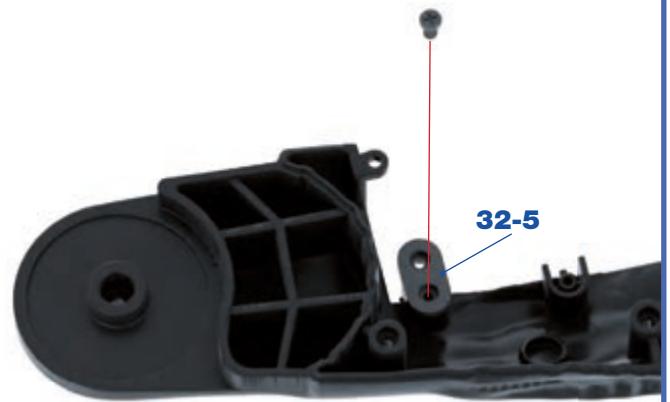

32-5

32-4

4

Fix the Connector **32-5** in place with a 2.3x6mm screw **32-6**.

### KIT 32 IS COMPLETE



*WORK HAS BEGUN ON THE LEFT RIBS AND A CONNECTOR ADDED TO THE RIGHT FEMUR.*

# KIT 33: THE LEFT RIBS AND RIGHT FEMUR (II)

In this kit you will continue to work on the Xenomorph's left ribs  
and right femur.



## PARTS SUPPLIED

Ref.	Name	Qty.	Ref.	Name	Qty.
33-1	Left Rib	1	33-5	Connector	1
33-2	Left Rib	1	33-6	2.3x6mm screws (1 spare)	4
33-3	Left Rib	1	33-7	2.3x4mm screws (1 spare)	4
33-4	Right Femur	1			



## KIT 33: THE LEFT RIBS AND RIGHT FEMUR (II)

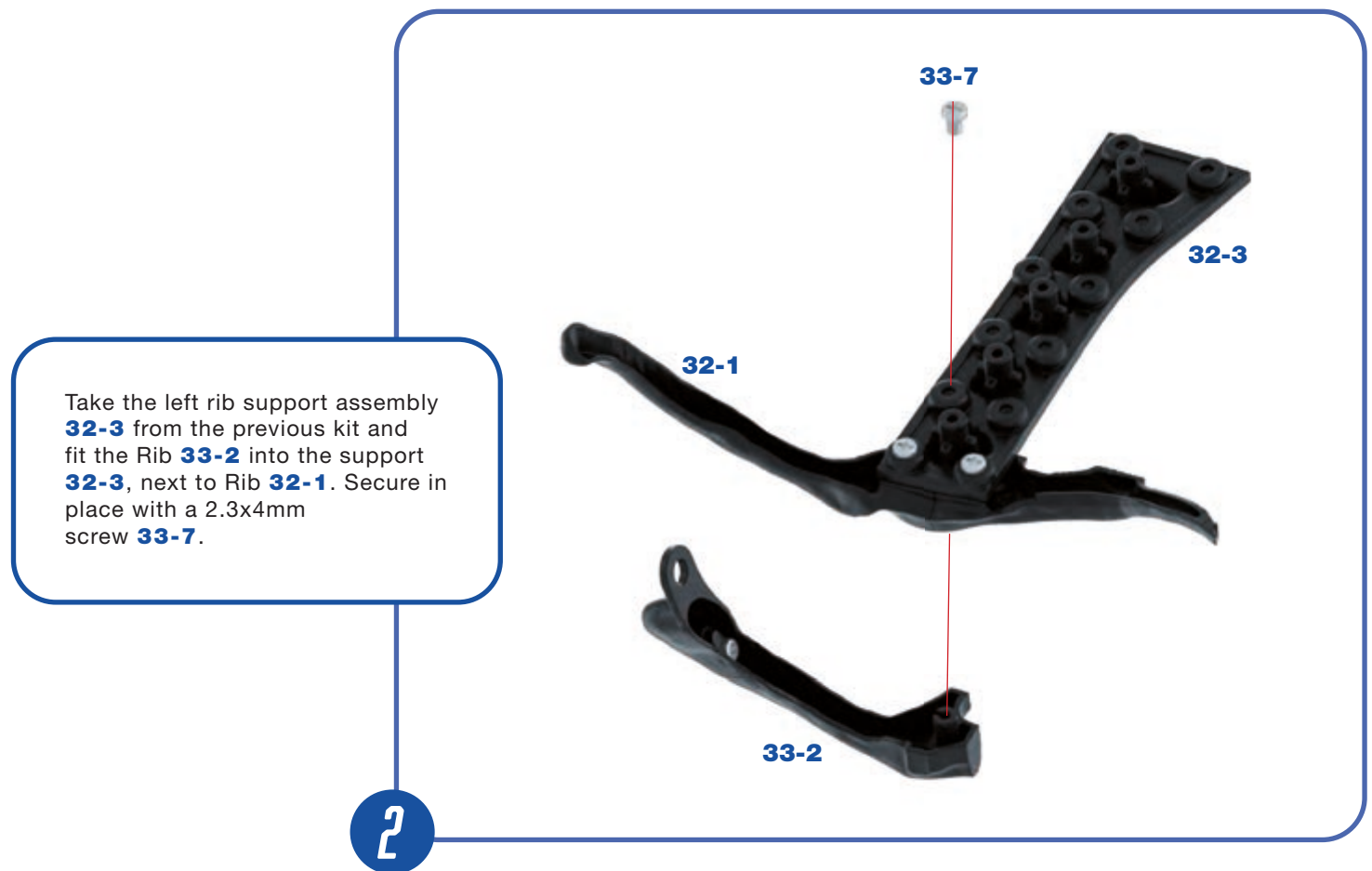
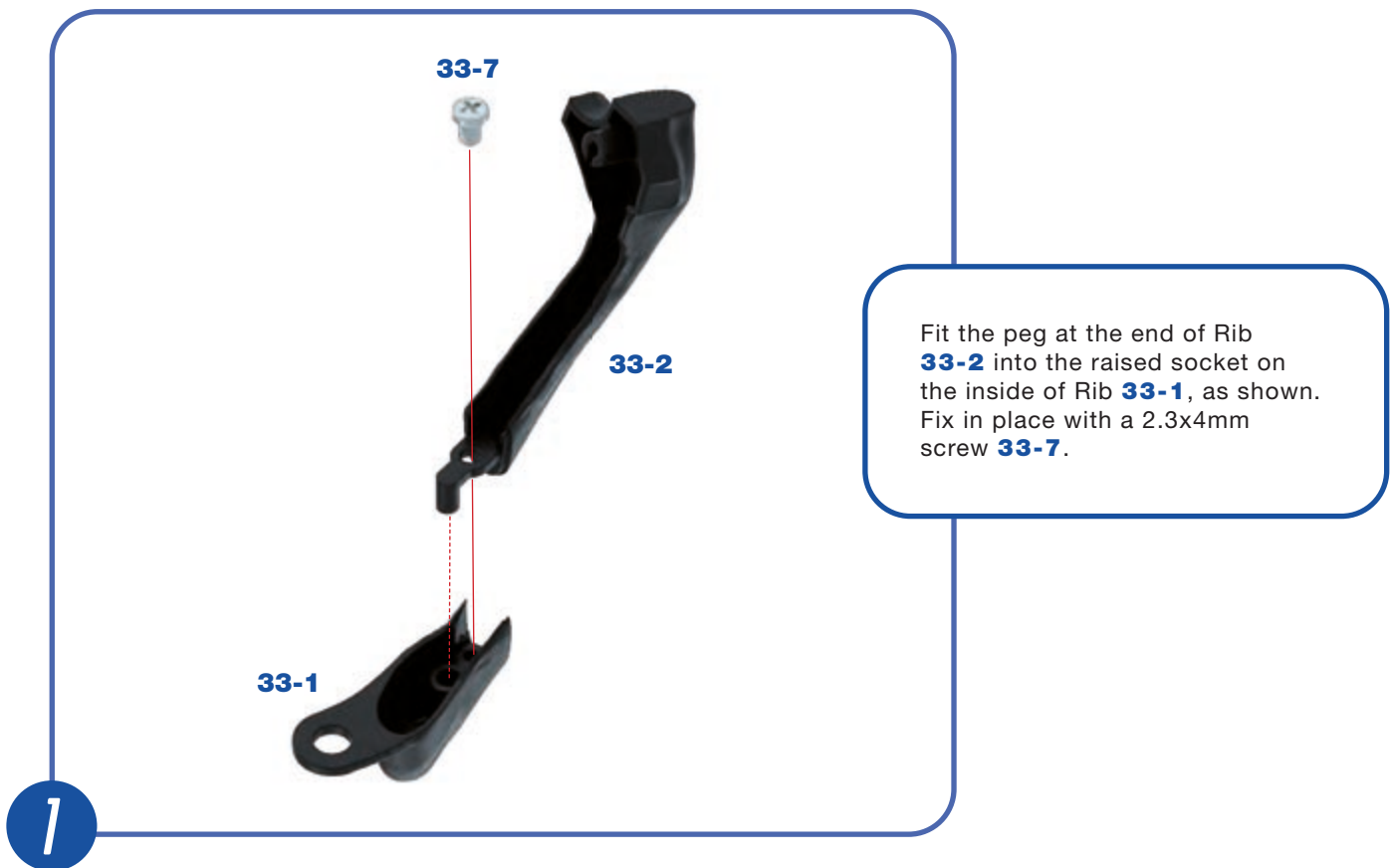

## KIT 33: THE LEFT RIBS AND RIGHT FEMUR (II)

The raised screw socket on Rib **33-3** fits into the support **32-3** opposite to Rib **33-2**. Fix in place with a 2.3x4mm screw **33-7**. Put the rib assembly safely aside until it is needed in the next kit.



3

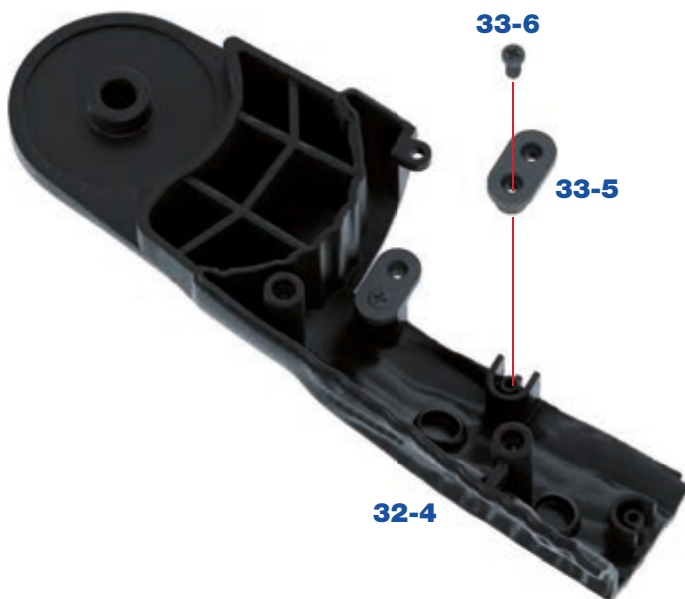

Take the Right Femur **32-4** from the previous kit and fit one half of the Connector **33-5**, as shown. Fix in place with a 2.3x6mm screw **33-6**.

4

## KIT 33: THE LEFT RIBS AND RIGHT FEMUR (II)

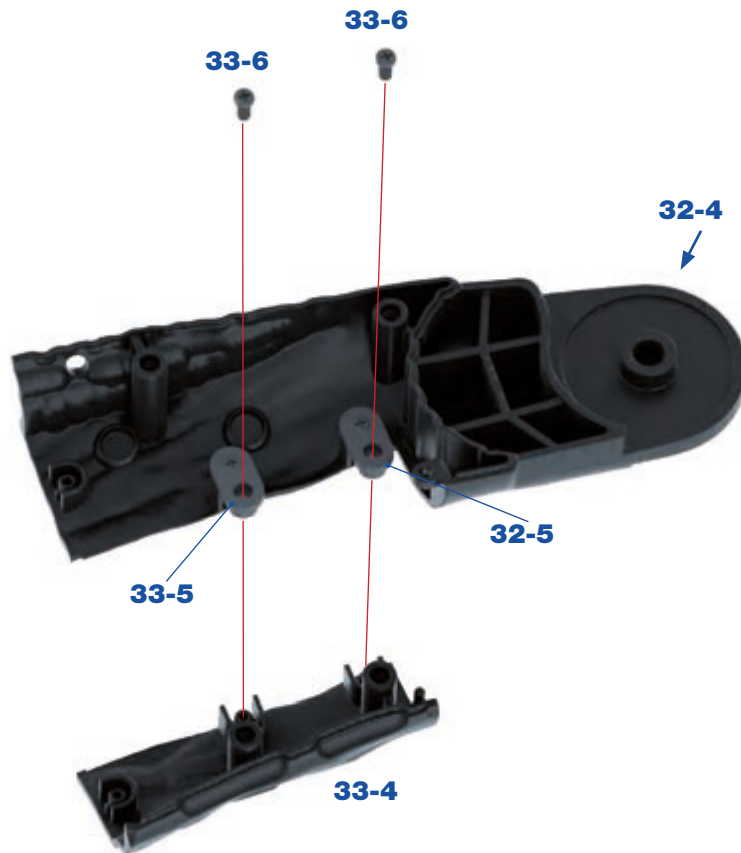

The Right Femur **33-4** is now joined to the femur part **32-4**. Fit the Connectors **32-5/33-5** into **33-4**, as shown, and secure in place with two 2.3x6mm screws **33-6**. It may help to temporarily loosen the screws on Connectors **32-5** and **33-5** whilst the part is being fitted.

## KIT 33 IS COMPLETE



*TWO MORE RIBS HAVE BEEN FITTED AS WELL AS A SECTION OF THE RIGHT FEMUR.*



# KIT 34: THE LEFT RIBS AND RIGHT FEMUR (III)

In this kit you will continue to work on the left ribs and right femur.



## PARTS SUPPLIED

Ref.	Name	Qty.	Ref.	Name	Qty.
34-1	Left Rib	1	34-4	Connector	2
34-2	Left Rib	1	34-5	2.3x6mm (1 spare)	3
34-3	Right Femur	1	34-6	2.3x4mm (1 spare)	3

## KIT 34: THE LEFT RIBS AND RIGHT FEMUR (III)

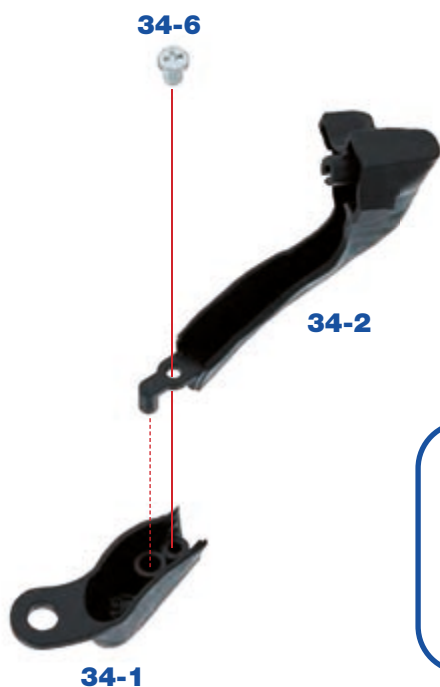

The peg at the end of Rib **34-2** is fitted into the raised socket inside Rib **34-1** and secured in place using a 2.3x4mm screw **34-6**.

1



Take the rib support assembly **32-3** which was worked on in the previous kit. Fit the raised screw socket on Left Rib **34-2** into the hole in rib support **32-3**, next to Rib **33-2**. Fix in place with a 2.3x4mm screw **34-6**. Keep the assembly safely aside until it is needed in the next kit.

2

## KIT 34: THE LEFT RIBS AND RIGHT FEMUR (III)

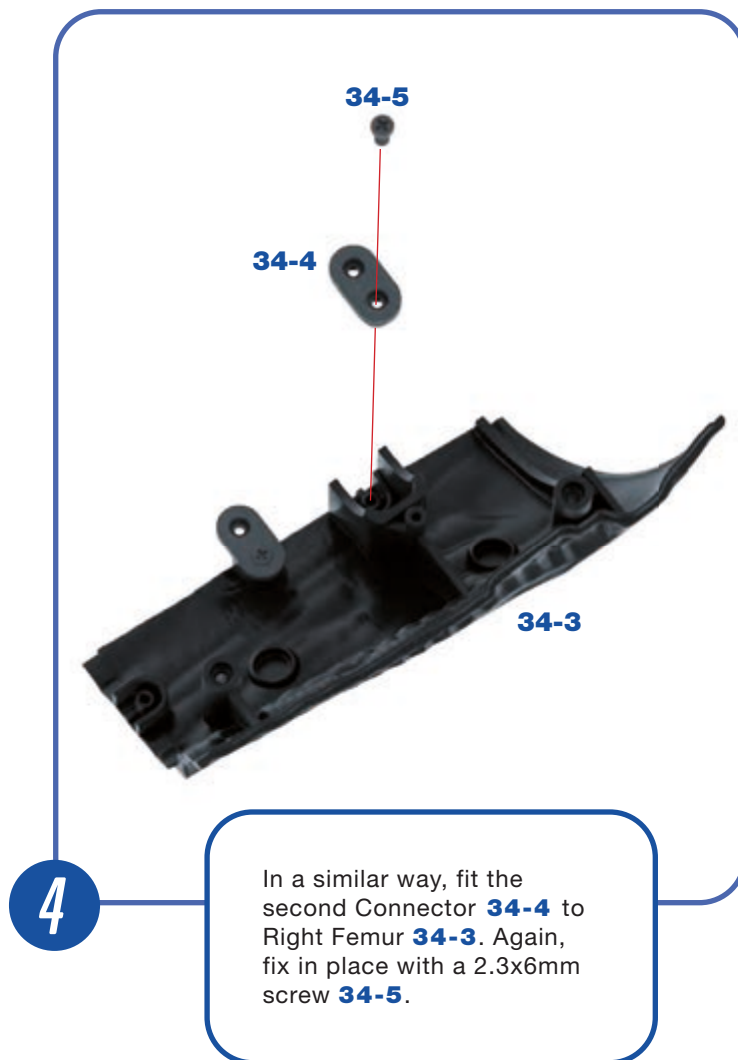
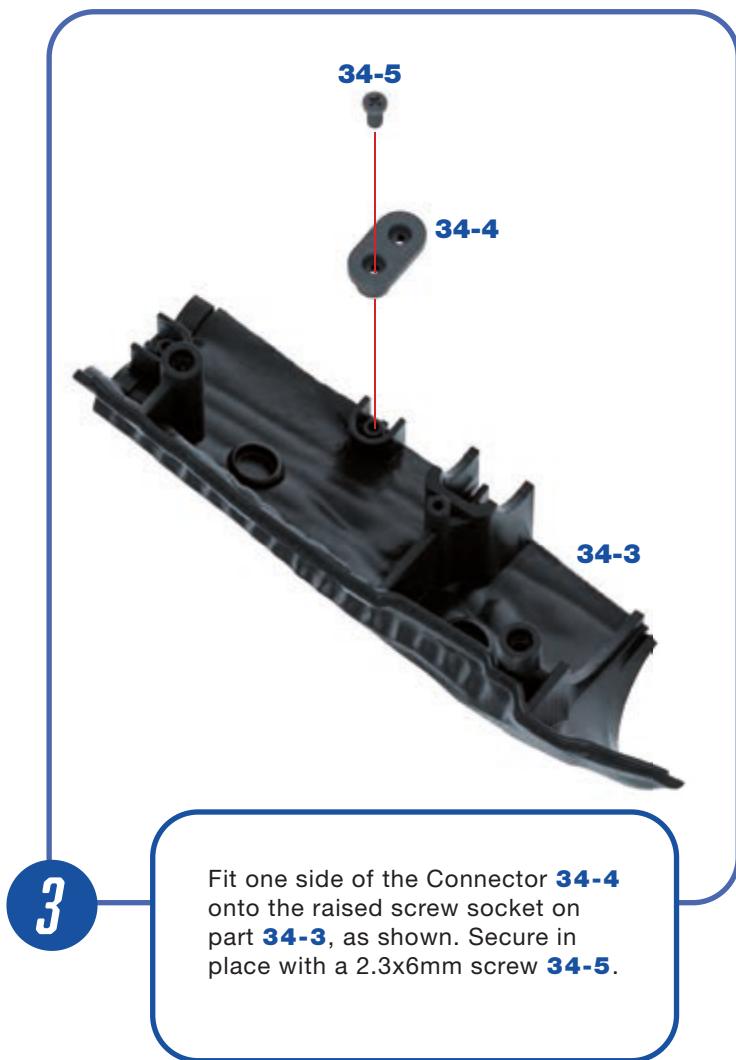

### KIT 34 IS COMPLETE



*FURTHER WORK HAS BEEN DONE ON THE LEFT RIB CAGE AND CONNECTORS FITTED TO THE RIGHT FEMUR.*



# KIT 35: THE LEFT RIBS AND RIGHT FEMUR (IV)

In this kit you will continue to build the left ribs and start to join together the different parts of the right femur.



PARTS SUPPLIED

Ref.	Name	Qty.	Ref.	Name	Qty.
35-1	Left Rib	1	35-5	Connectors	2
35-2	Left Rib	1	35-6	2.3x6mm (1 spare)	7
35-3	Left Rib	1	35-7	2.3x4mm (1 spare)	4
35-4	Right Femur	1			



## KIT 35: THE LEFT RIBS AND RIGHT FEMUR (IV)

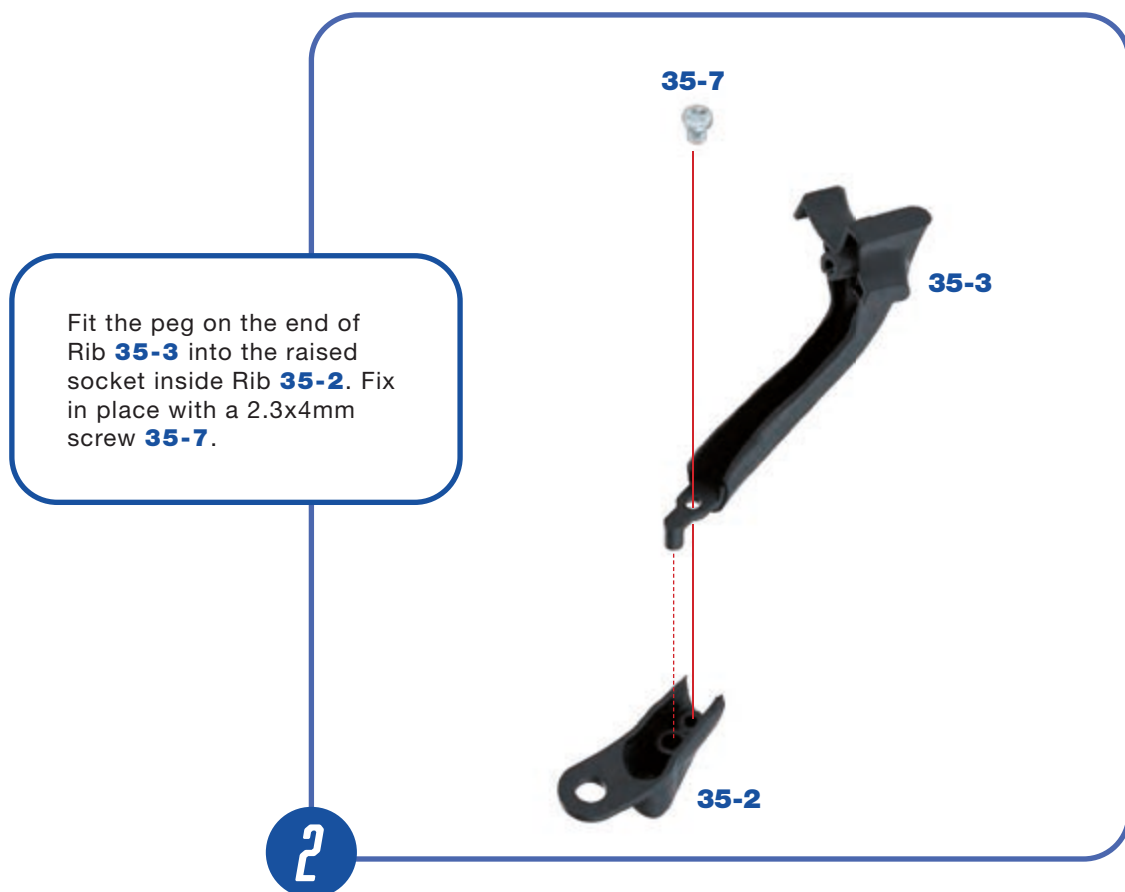
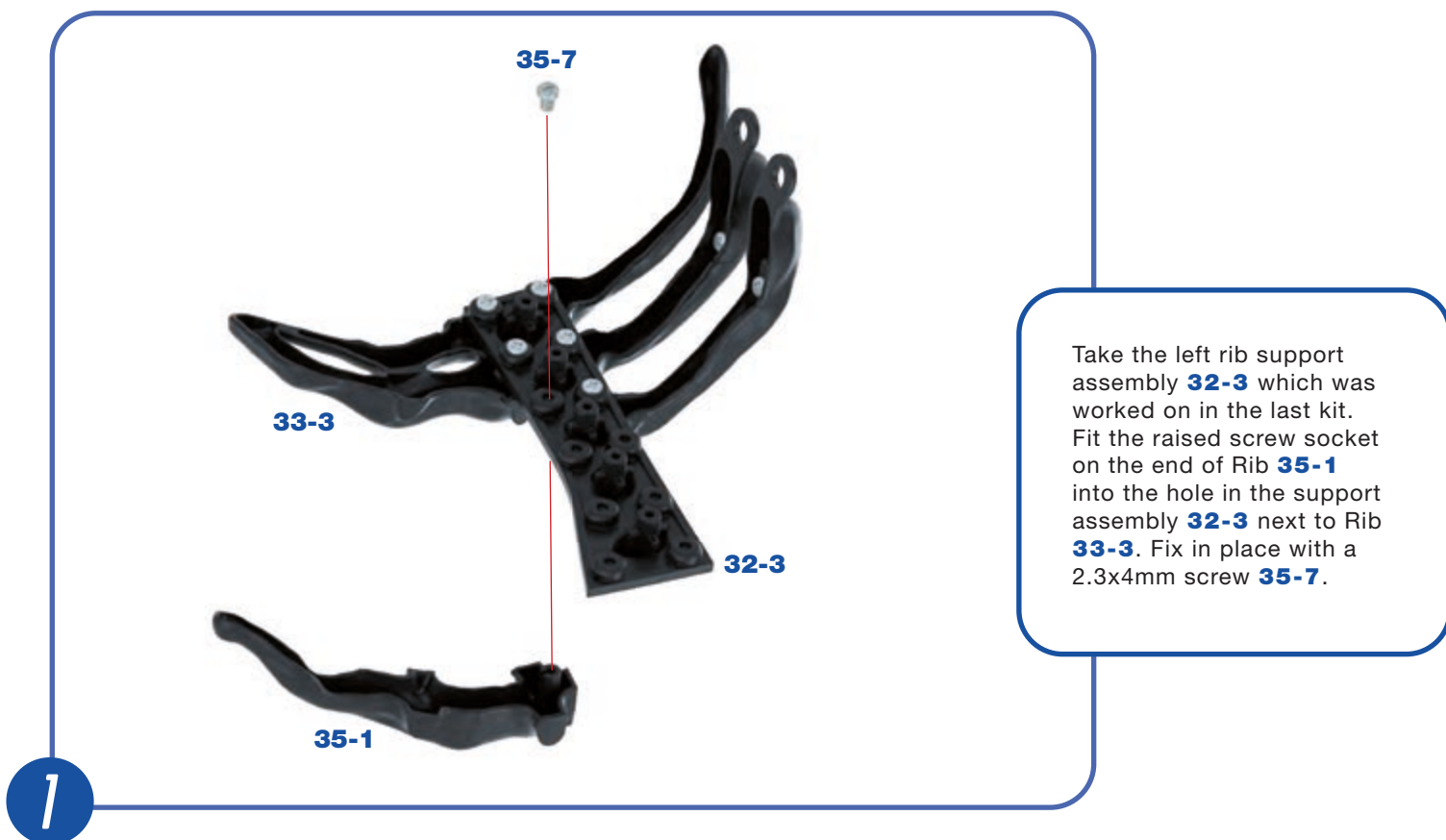

## KIT 35: THE LEFT RIBS AND RIGHT FEMUR (IV)

Fit the rib assembly **35-3** into the rib support **32-3** next to Rib **34-2**. Fix in place with a 2.3x4mm screw **35-7**. Keep the assembly safely aside.



3



Next, take the right femur part **34-3** from the last kit. Join Right Femur **35-4** to this using the previously fitted Connectors **34-4**, as shown. It may help to temporarily loosen the screws on the connectors.

4

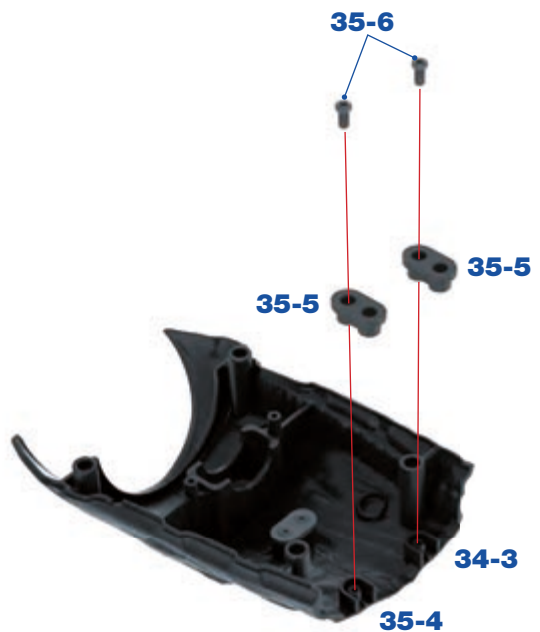

Fit the Connectors **35-5** over the raised screw sockets on Right Femur parts **34-3** and **35-4**, as shown. Fix in place using two 2.3x6mm screws **35-6**.

5

## KIT 35: THE LEFT RIBS AND RIGHT FEMUR (IV)

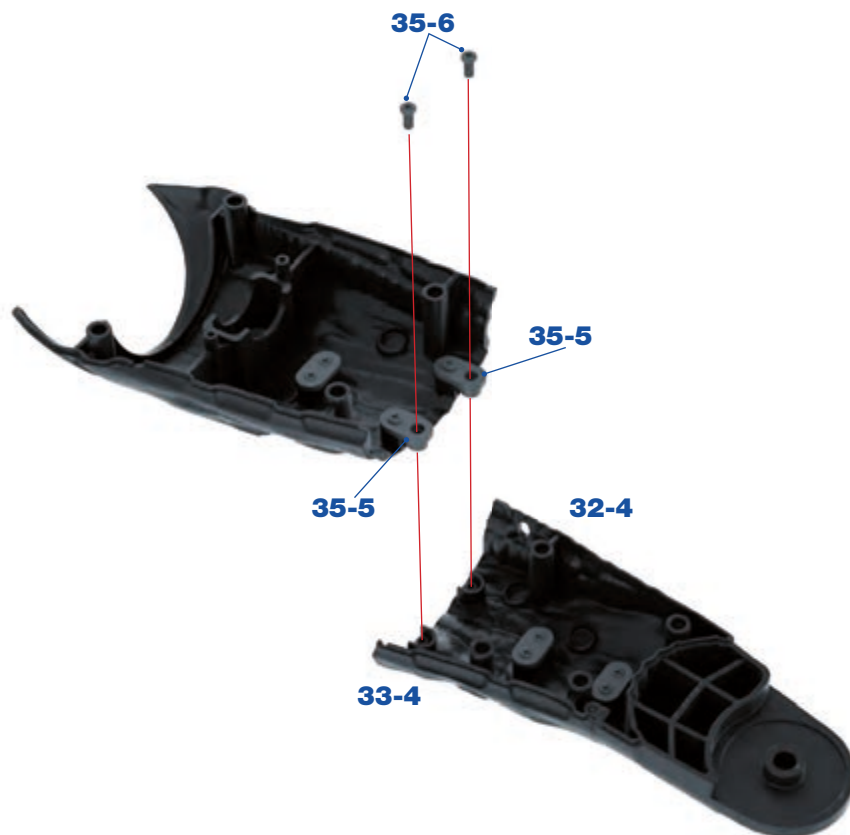

Take the femur assembly **32-4/33-4** which was last worked on in kit 33. Join the assembly **34-3/35-4** to this using the previously fitted Connectors **35-5**. Fix in place using two 2.3x6mm screws **35-6**. As before, it may help to temporarily loosen the screws on the connectors whilst doing this.

6

### KIT 35 IS COMPLETE



*A SIXTH AND SEVENTH LEFT RIB HAVE BEEN FITTED AND RIGHT FEMUR PARTS JOINED TOGETHER.*

# KIT 36: THE LEFT RIBS AND RIGHT THIGH (I)

In this kit you will continue to build the left ribs and work on parts of the Xenomorph's right thigh.

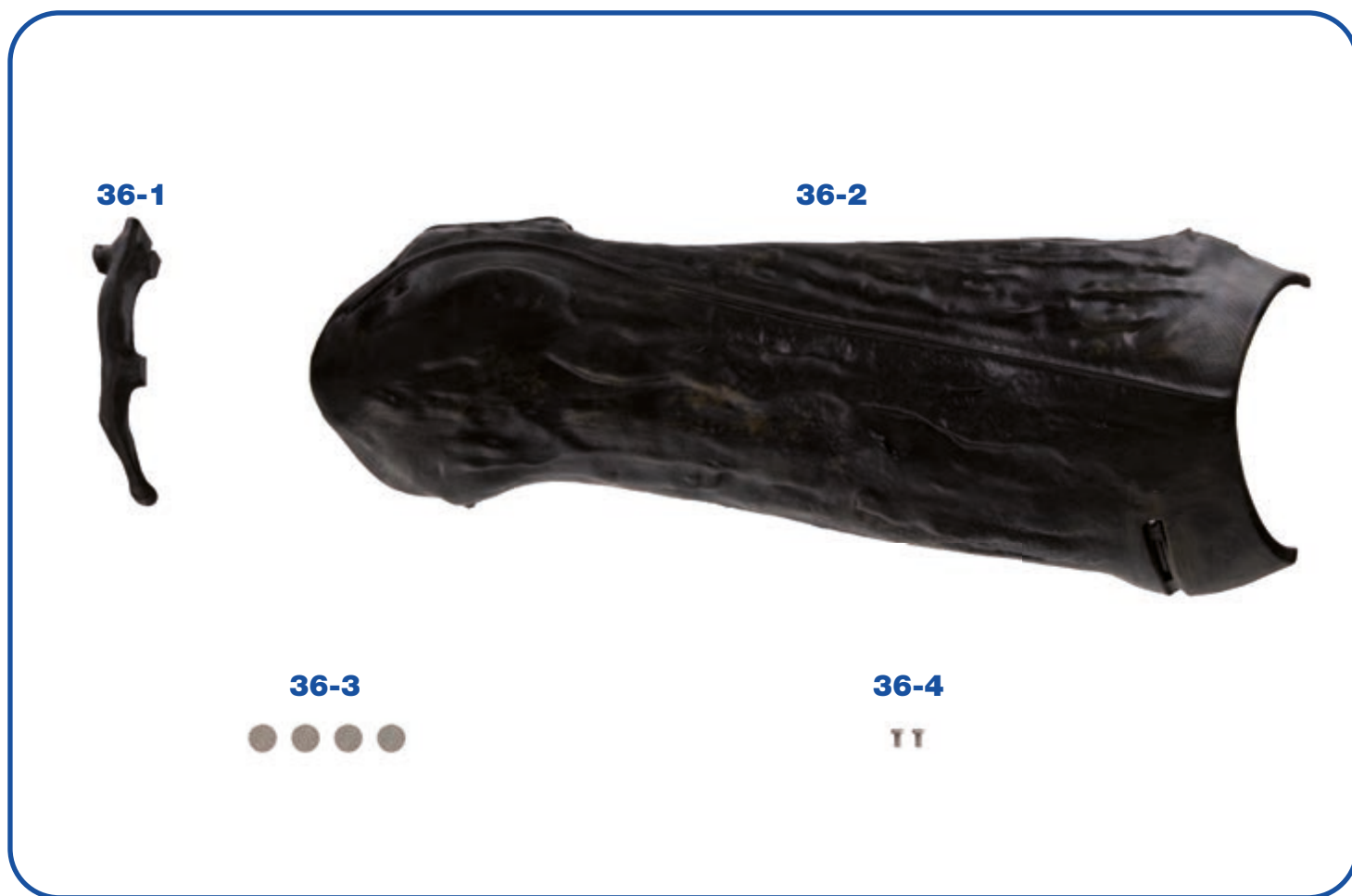

## PARTS SUPPLIED

Ref.	Name	Qty.	Ref.	Name	Qty.
36-1	Left Rib	1	36-3	Magnets	4
36-2	Right Thigh Skin	1	36-4	2.3x4mm screws (1 spare)	2



## KIT 36: THE LEFT RIBS AND RIGHT THIGH (I)



Take the left rib support **32-3** and fit Rib **36-1** into the hole opposite rib **35-3**.

1

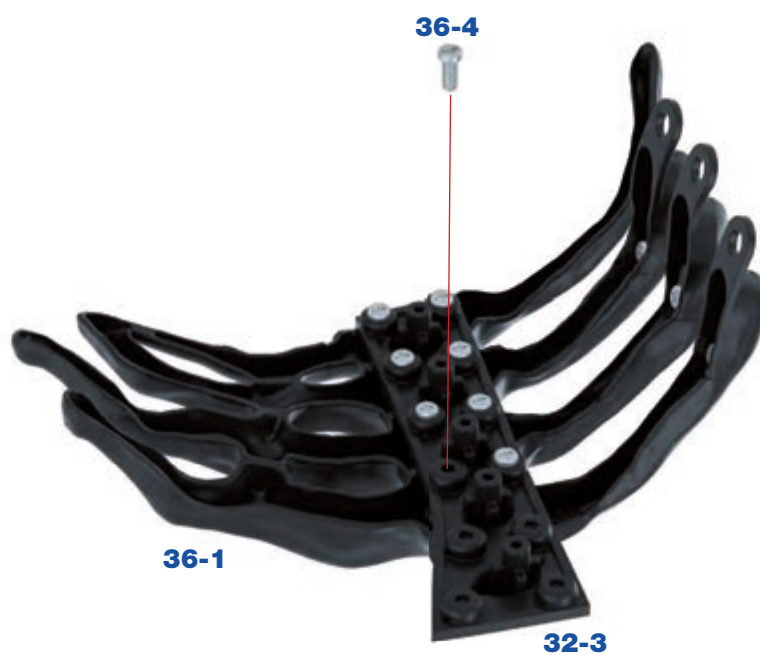

Turn the assembly over and secure Rib **36-1** in place with a 2.3x4mm screw **36-4**. Put the assembly aside until the next kit.

2

## KIT 36: THE LEFT RIBS AND RIGHT THIGH (I)

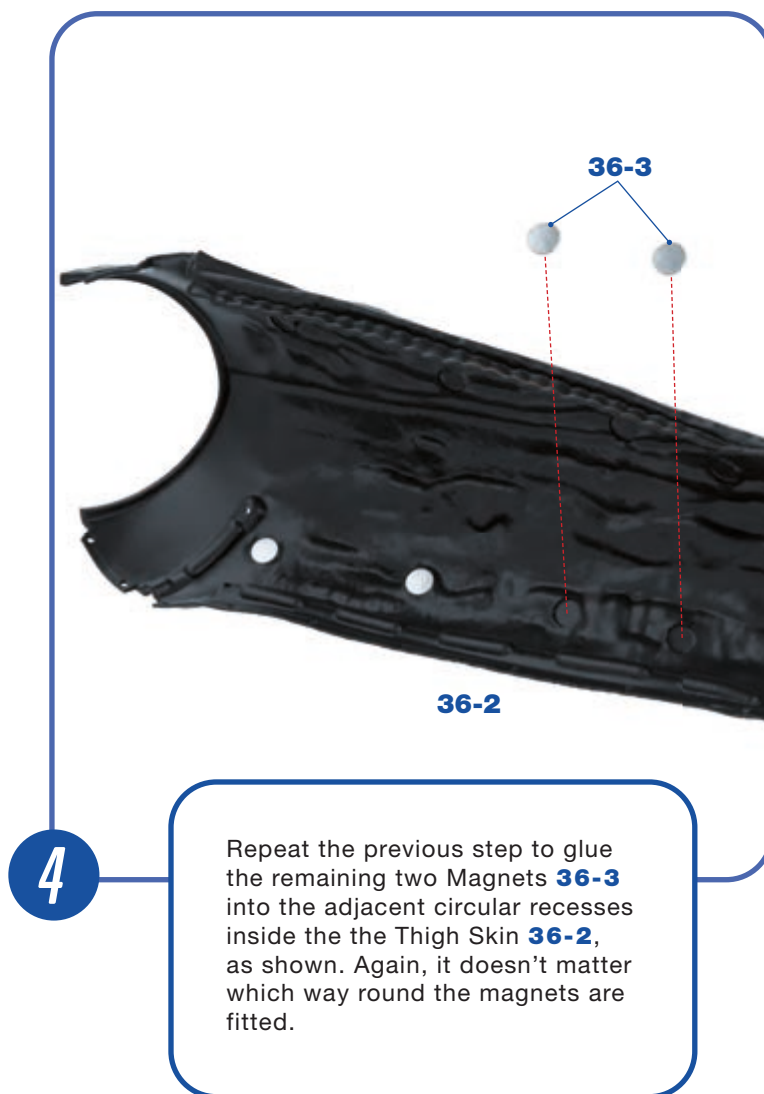

### PACK 5 AND KIT 36 IS NOW COMPLETE



*AN EIGHTH LEFT RIB HAS BEEN FITTED AND MAGNETS GLUED IN PLACE ON THE RIGHT THIGH SKIN.*