

ALIEN

SPECTACULAR

1:2
SCALE

EASY
ASSEMBLY

BUILD THE
TERRIFYING
XENOMORPH
FROM ALIEN

PACK 4
KITS 21 - 28

NON CONTRACTUAL VISUAL

ALIEN

PACK 4 | BUILD INSTRUCTIONS

KIT 21

THE RIGHT LEG (III)

KIT 22

THE RIGHT RIBS AND
THE LEG (II)

KIT 23

THE RIGHT RIBS AND
THE LEG (III)

KIT 24

THE RIGHT RIBS AND
THE LEG (IV)

KIT 25

THE RIGHT RIBS AND
THE RIGHT FEMUR (I)

KIT 26

THE RIGHT RIBS AND
THE RIGHT FEMUR (II)

KIT 27

THE RIGHT RIBS AND
THE RIGHT FEMUR (III)

KIT 28

THE RIGHT RIBS AND
THE RIGHT FEMUR (IV)



WARNING: Some parts are assembled using magnets. These magnets can cause serious injury if they are swallowed. Keep away from children. If you suspect a magnet has been swallowed, seek medical help straight away.

Some parts may have sharp edges, please handle them with care.

The installation of electronic parts must always be carried out by an adult. When replacing batteries, use the same type of batteries.

Please ensure that the battery compartment is securely fastened before you use the model.

Used batteries should be recycled.

Please make sure to check with your local council how batteries should be disposed of in your area.

Batteries can present a choking danger to small children and may cause serious harm if ingested. Do not leave them lying around and keep any spare batteries locked away at all times.



STEPS & TIPS ONLINE

Hachette Partworks Ltd, 4th Floor, Jordan House,
47 Brunswick Place, London N1 6EB

www.hachettepartworks.com

© 2023/2024 Hachette Partworks Ltd.

© 2023 20th Century Studios.

ALL RIGHTS RESERVED

All parts belong to a kit. Collectors item for adults.

Not suitable for children under 14.



KIT 21: THE RIGHT LEG (III)

In this kit you will continue to assemble parts of the Xenomorph’s right leg.

21-1



21-2



21-3



21-4



PARTS SUPPLIED

Ref.	Name	Qty.	Ref.	Name	Qty.
21-1	Right Tibia	1	21-3	Magnets	8
21-2	Connectors	4	21-4	2.3x6mm screws	10*

*A spare screw is supplied in case of loss or damage.

KIT 21: THE RIGHT LEG (III)

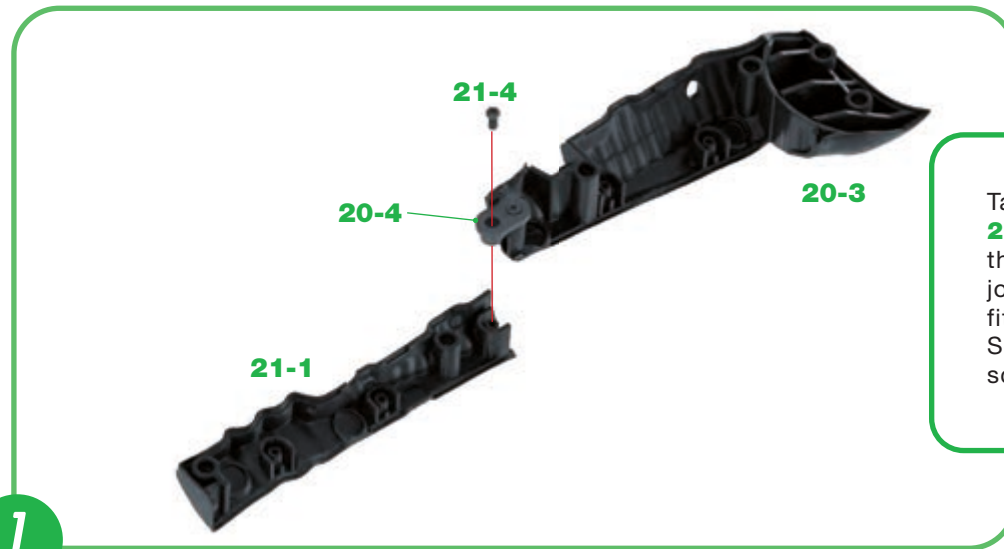

Take the Right Tibia assembly **20-3** which was worked on in the last kit. Tibia part **21-1** is joined to this using the previously fitted Connector **20-4**, as shown. Secure in place with a 2.3x6mm screw **21-4**.

1



Next, take the Right Calf assembly **14-1** which was last worked on in pack 3 - kit 16 and remove the inner parts **15-1/16-1**.

2

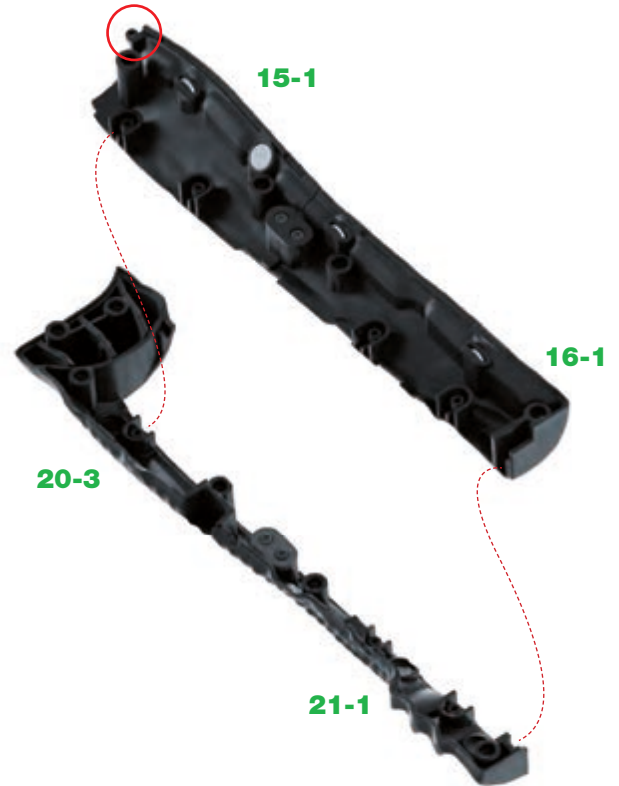

The Tibia assembly **15-1/16-1** is now joined to the assembly **20-3/21-1**. There is a tab with a hole at the end of part **15-1** (circled) which fits over a peg on part **20-3** (arrow).

3

KIT 21: THE RIGHT LEG (III)

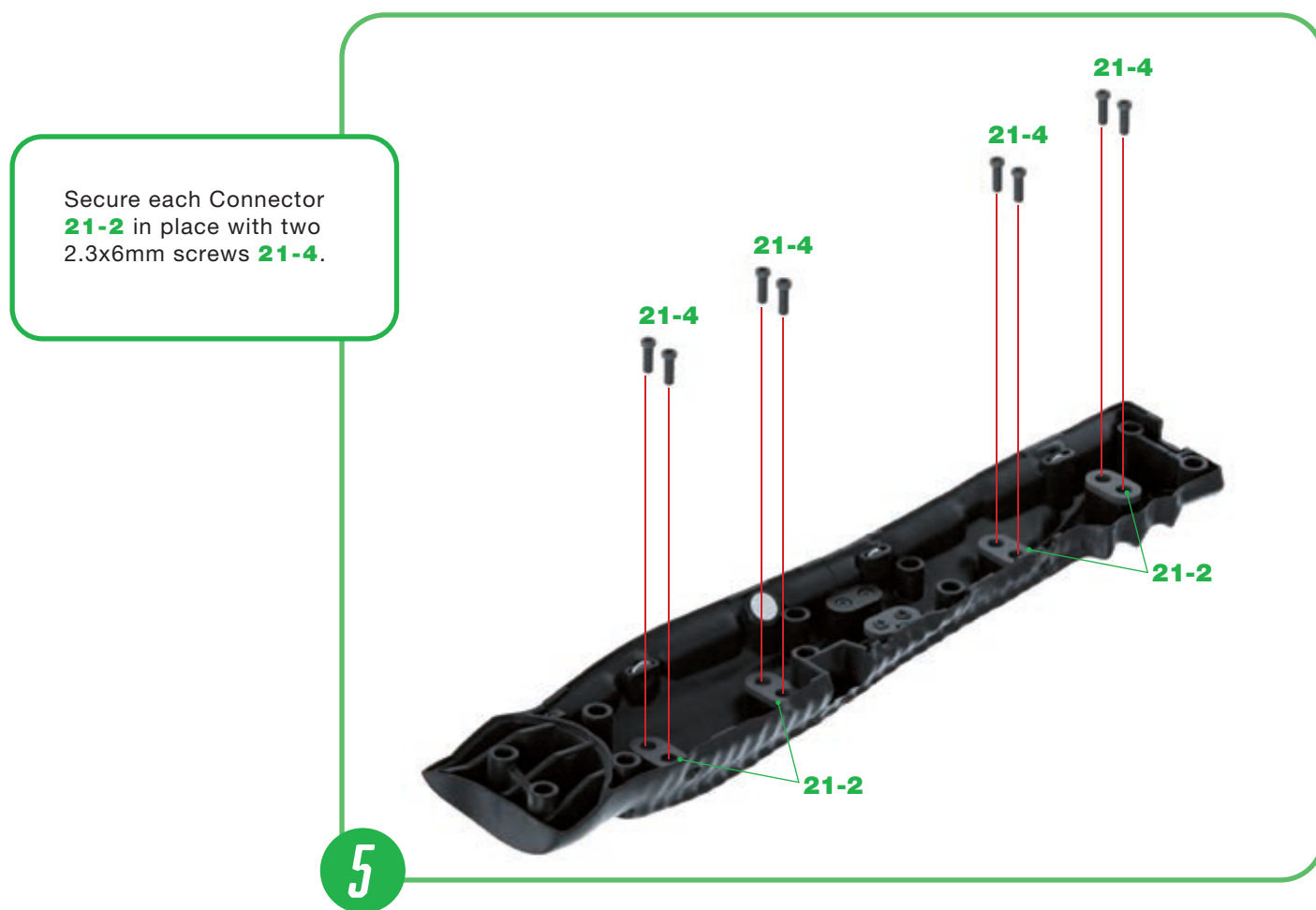
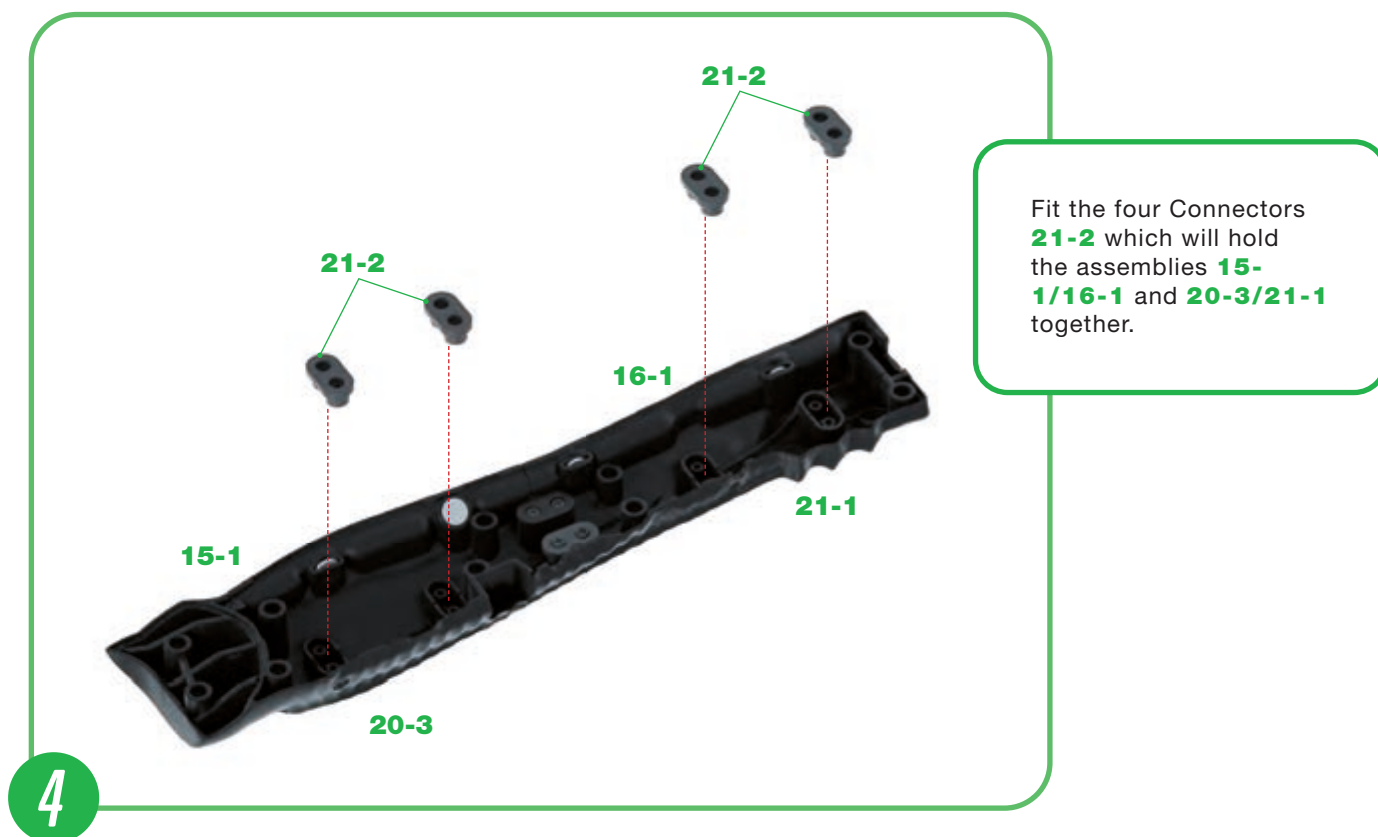

KIT 21: THE RIGHT LEG (III)



Take the Outer Calf Skin **14-1** and glue four Magnets **21-3** firmly into the circular recesses as shown on the left. It doesn't matter which way round the magnets are fitted.

6



Place the assembly **15-1/16-1/20-3/21-1** over the calf assembly **14-1**.

7

KIT 21: THE RIGHT LEG (III)

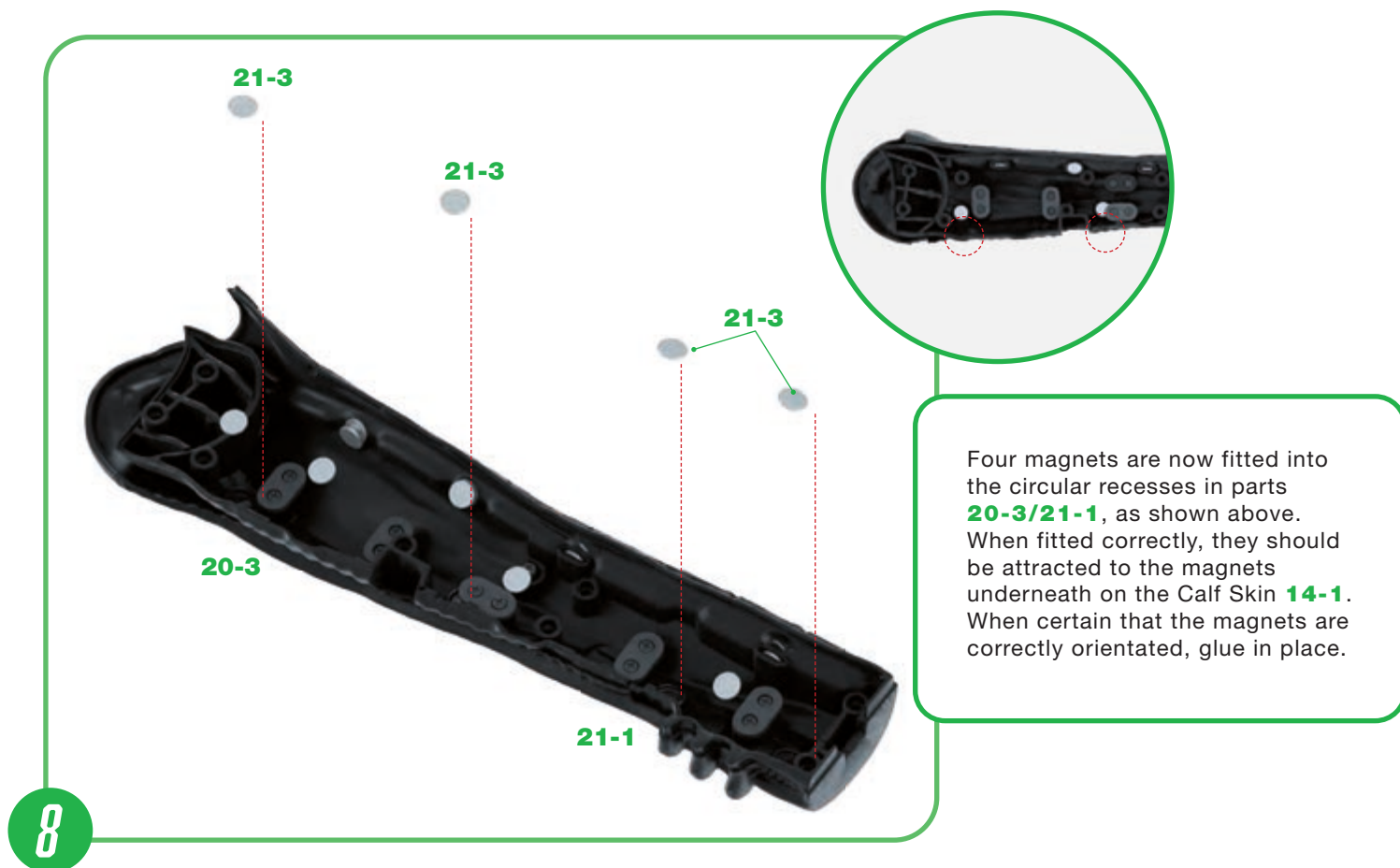

KIT 21 IS COMPLETE

FURTHER PARTS INCLUDING A SET OF MAGNETS HAVE BEEN FITTED TO THE RIGHT LEG.



KIT 22: THE RIGHT RIBS AND THE LEG (II)

In this kit you will continue to work on the right ribs
and leg of the Xenomorph.

22-1



22-2



22-3



22-4



PARTS SUPPLIED

Ref.	Name	Qty.	Ref.	Name	Qty.
22-1	Calf Protector	1	22-3	Pipe A1	1
22-2	Right Rib	1	22-4	2.3x6mm screws	4*

*A spare screw is supplied in case of loss or damage.

KIT 22: THE RIGHT RIBS AND THE LEG (II)

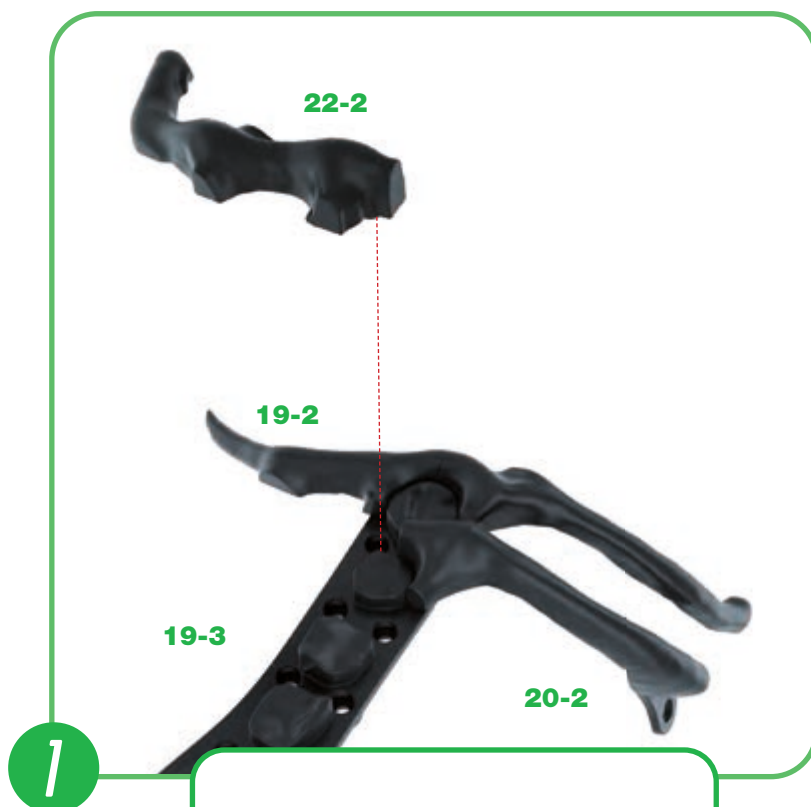

1

Take the rib support assembly **19-3** which was worked on in pack 3 - kit 20. Fit the raised screw socket on Right Rib **22-2** into the corresponding hole on rib support **19-3**, as shown.



2

Turn the assembly over and fix Right Rib **22-2** in place with a 2.3x6mm screw **22-4**. Put the assembly aside.

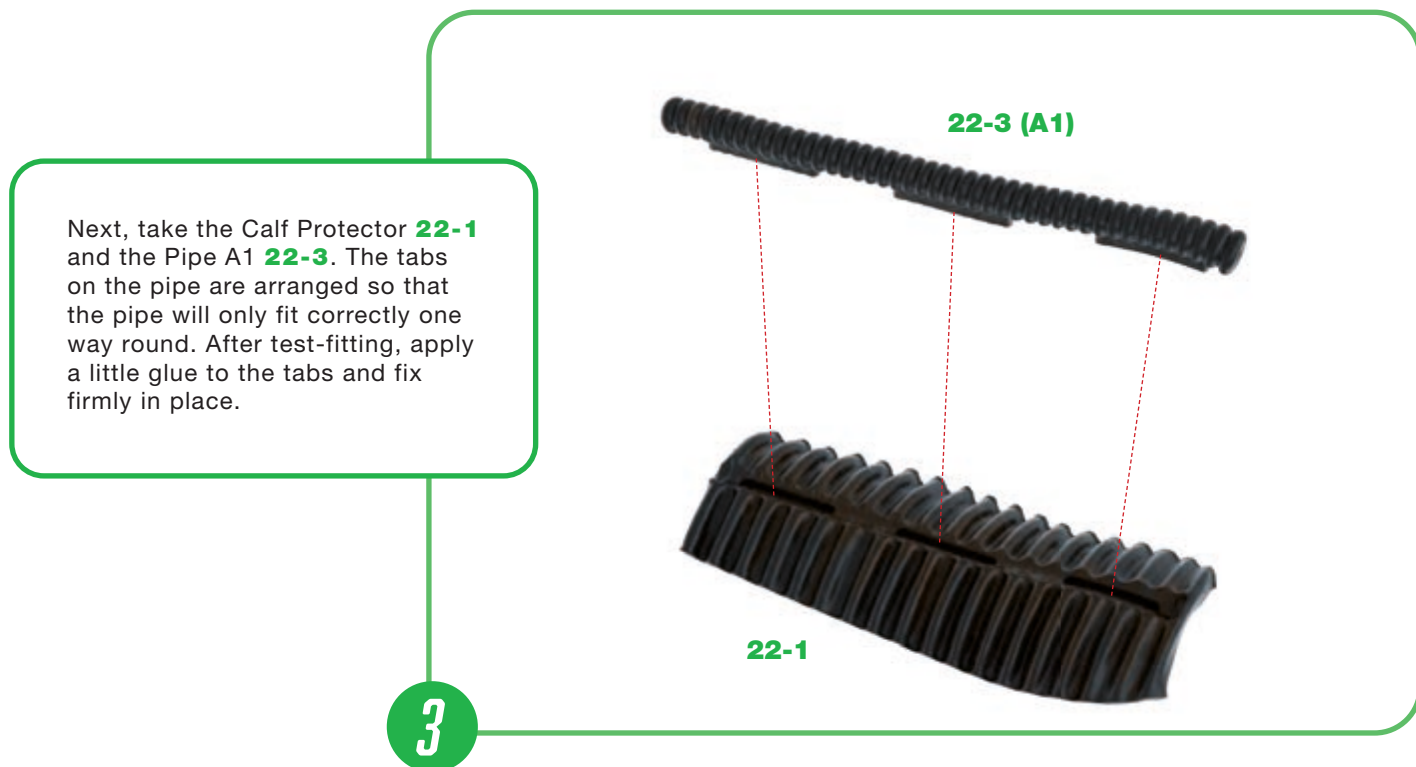

Next, take the Calf Protector **22-1** and the Pipe A1 **22-3**. The tabs on the pipe are arranged so that the pipe will only fit correctly one way round. After test-fitting, apply a little glue to the tabs and fix firmly in place.

3

KIT 22: THE RIGHT RIBS AND THE LEG (II)

4

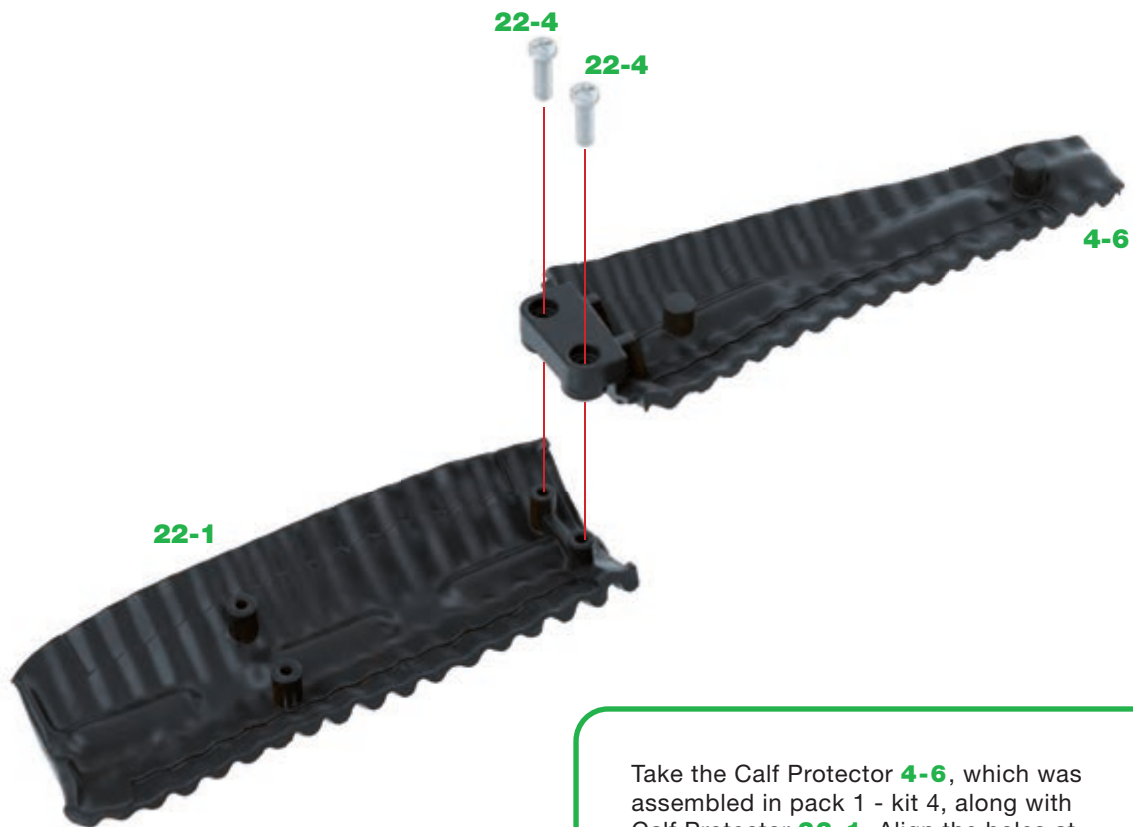

Take the Calf Protector **4-6**, which was assembled in pack 1 - kit 4, along with Calf Protector **22-1**. Align the holes at one end of part **4-6** over the raised screw sockets on part **22-1**, as shown. Secure the parts together using two 2.3x6mm screws **22-4**.

KIT 22 IS COMPLETE



ANOTHER RIB HAS BEEN CONNECTED AS WELL AS FURTHER WORK ON THE CALF PROTECTOR.



KIT 23: THE RIGHT RIBS AND THE LEG (III)

In this kit you will continue to work on the right ribs and leg of the Xenomorph.

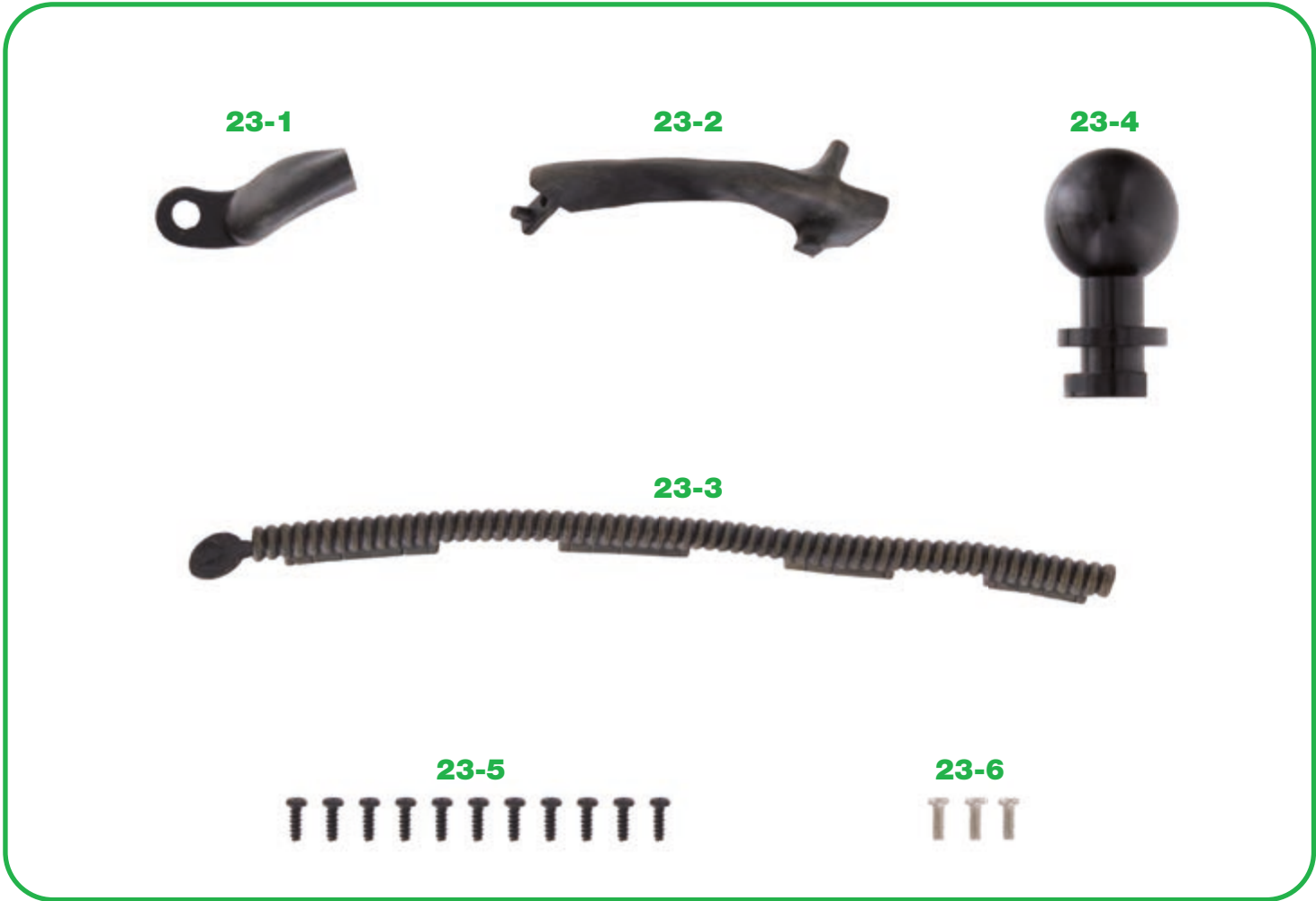

PARTS SUPPLIED

Ref.	Name	Qty.	Ref.	Name	Qty.
23-1	Right Rib	1	23-4	Ball Joint	1
23-2	Right Rib	1	23-5	2.3x6mm screws	11*
23-3	Pipe A2	4	23-6	2.3x4mm screws	3*

*A spare screw of each type is supplied in case of loss or damage.

KIT 23: THE RIGHT RIBS AND THE LEG (III)

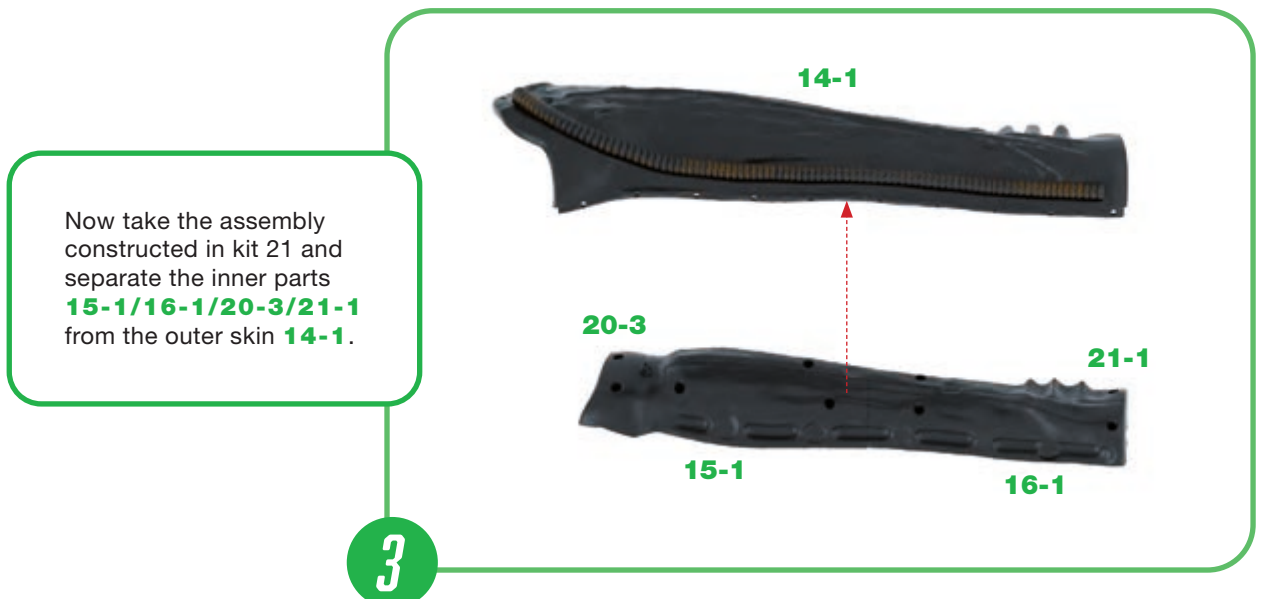
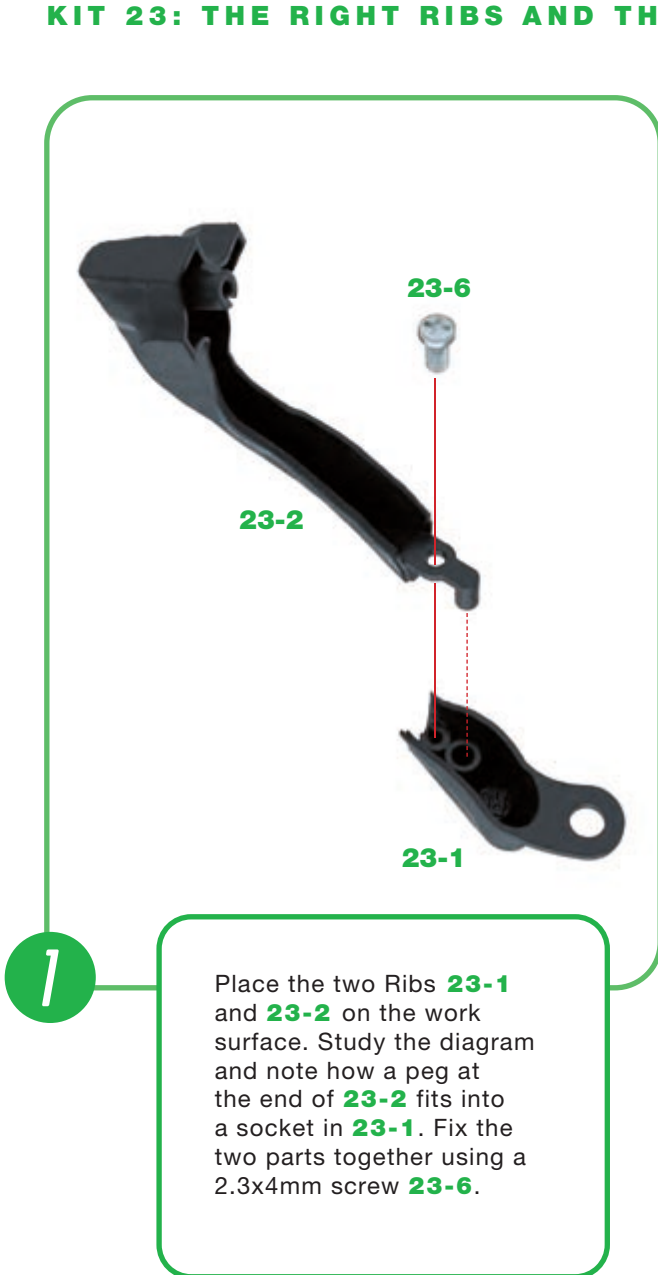

KIT 23: THE RIGHT RIBS AND THE LEG (III)

Next take the second tibia assembly **4-1/4-2/17-1/18-1** which was worked on in pack 3 - kit 18. Fit the Ball Joint **23-4** into the slot at the end of part **4-1** and **18-1**. Check the orientation to ensure a good fit. This assembly is now covered with the other half of the tibia **15-1/16-1/20-3/21-1**. There are raised screw sockets on the assembly **4-1** which fit into matching recesses on assembly **16-1**.

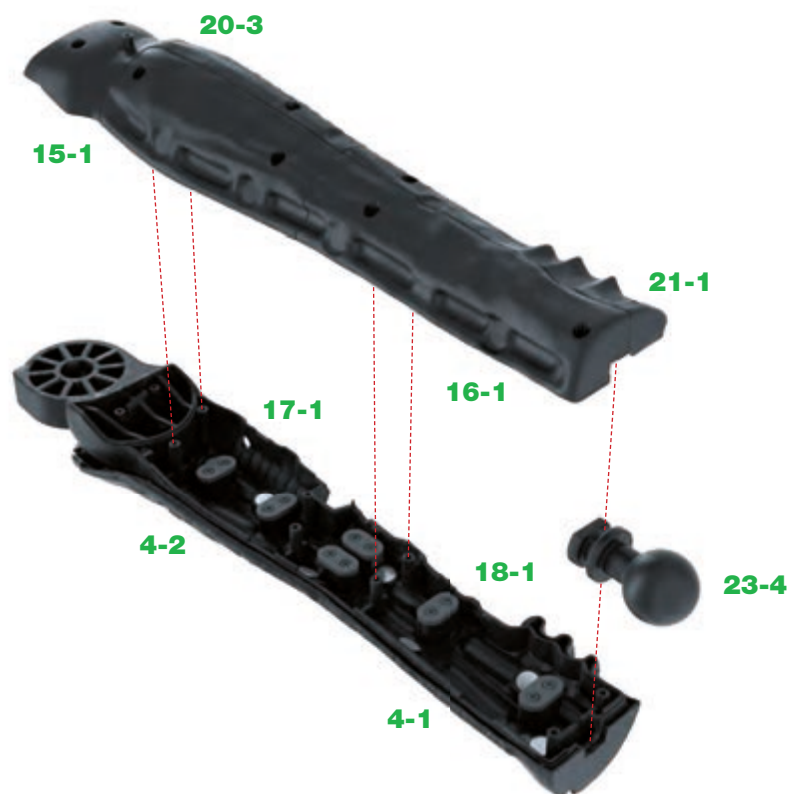

4

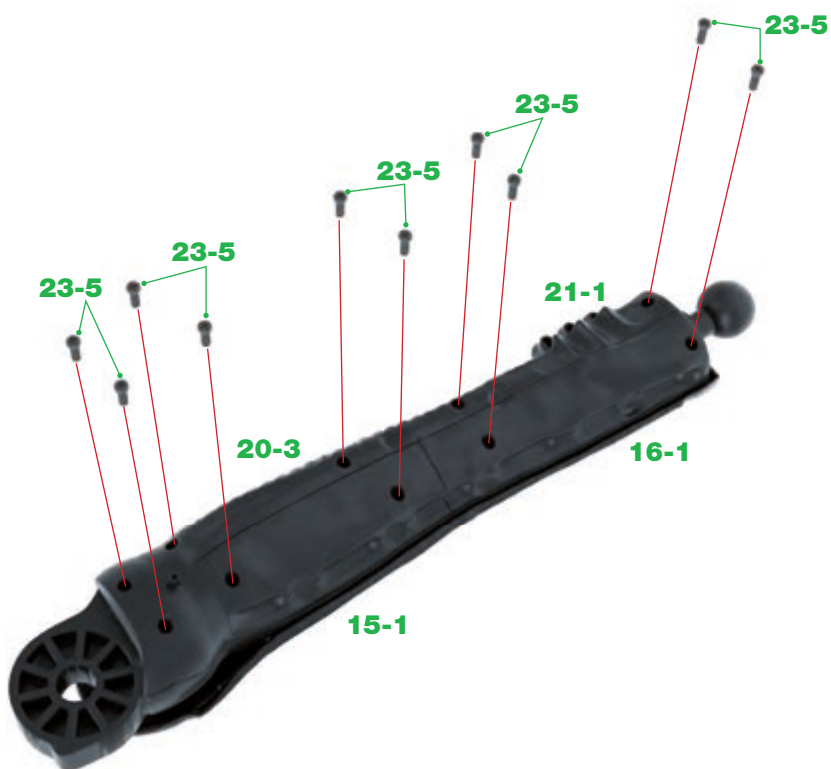

Take time to make sure that all of the parts are correctly aligned and fix firmly together with ten 2.3x6mm screws **23-5**.

5

KIT 23: THE RIGHT RIBS AND THE LEG (III)

6

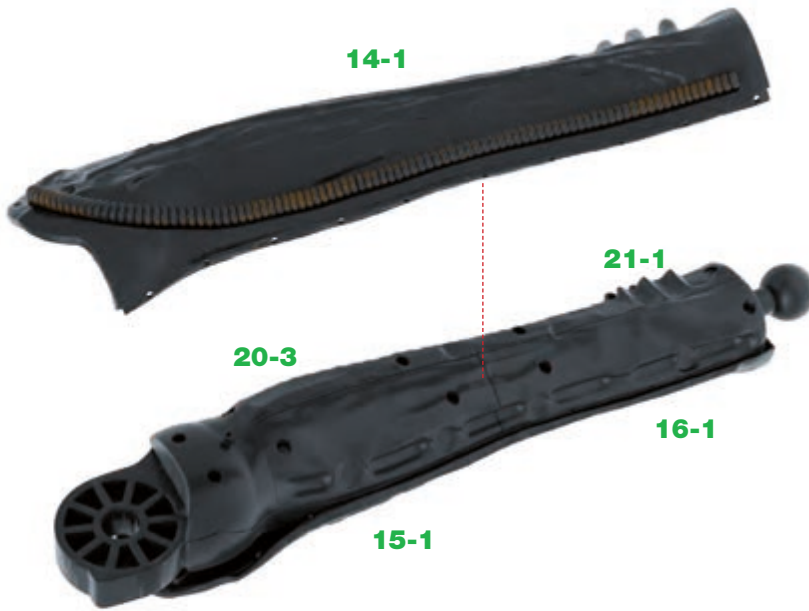

Fit the outer skin **14-1** on top of the tibia assembly, as shown. The Outer Skin **4-4** will also need to be fitted if previously removed.

Turn over the right tibia assembly. The calf protector assembly **4-6/22-1**, which was prepared in kit 22 is fitted into the recess on the assembly **17-1/20-3**, as shown. There are four raised screw sockets on the calf protector **4-6/22-1** which push-fit into corresponding holes in **17-1/20-3**. Note that the protector is placed over the ridges on the sides of skin parts **4-4** and **14-1**. The skin assemblies **4-4/14-1** and the calf protector **4-6/22-1** are only fitted temporarily at present as they will need to be removed again in a later kit.



7

KIT 23: THE RIGHT RIBS AND THE LEG (III)

Turn the tibia assembly over again as shown on the right. Check the fit of the tabs on Pipe A2 **23-3** in the slots in the Calf Piece **4-4** and secure in place with a little glue.

8

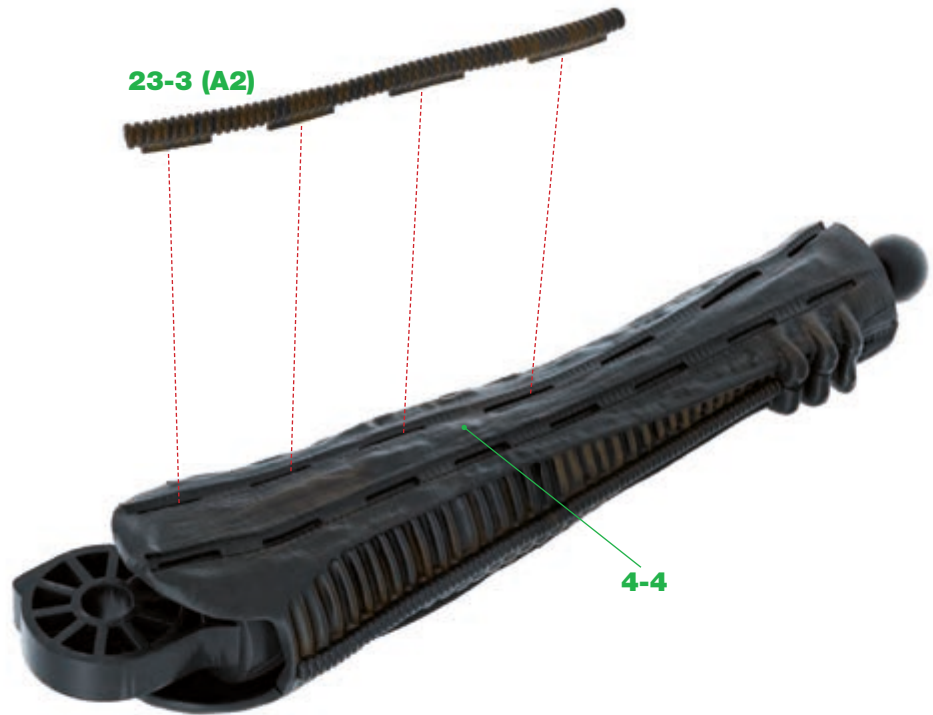

KIT 23 IS COMPLETE

MORE OF THE RIGHT LEG HAS BEEN ASSEMBLED ALONG WITH WORK ON THE RIB CAGE.



KIT 24: THE RIGHT RIBS AND THE LEG (IV)

In this kit you will continue to work on the right ribs and leg of the Xenomorph.

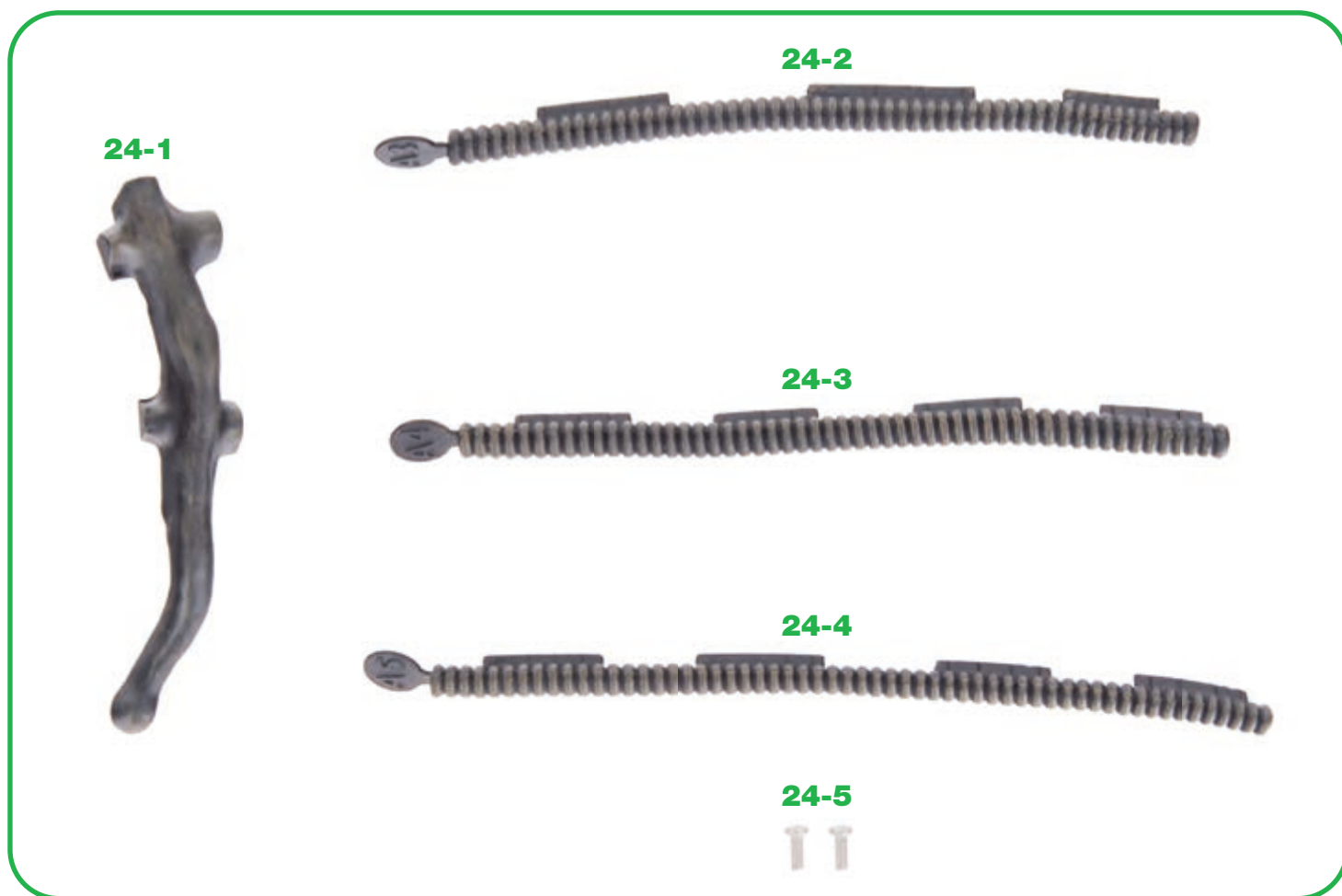

PARTS SUPPLIED

Ref.	Name	Qty.	Ref.	Name	Qty.
24-1	Right Rib	1	24-4	Pipe A5	1
24-2	Pipe A3	1	24-5	2.3x6mm screws	2*
24-3	Pipe A4	1			

*A spare screw is supplied in case of loss or damage.

KIT 24: THE RIGHT RIBS AND THE LEG (IV)

Take the rib support assembly **19-3** from the last kit. Fit the raised screw socket at one end of Rib **24-1** into its corresponding hole in support **19-3**. Fix in place with a 2.3x6mm screw **24-5**.

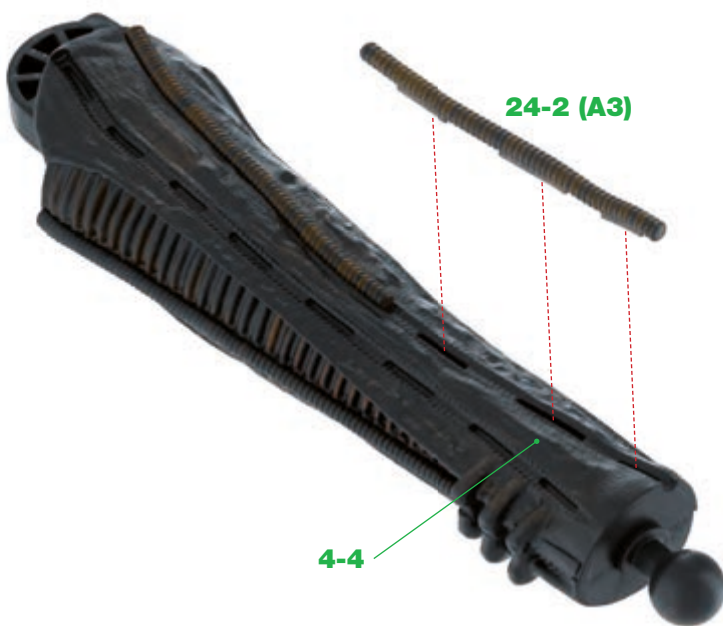
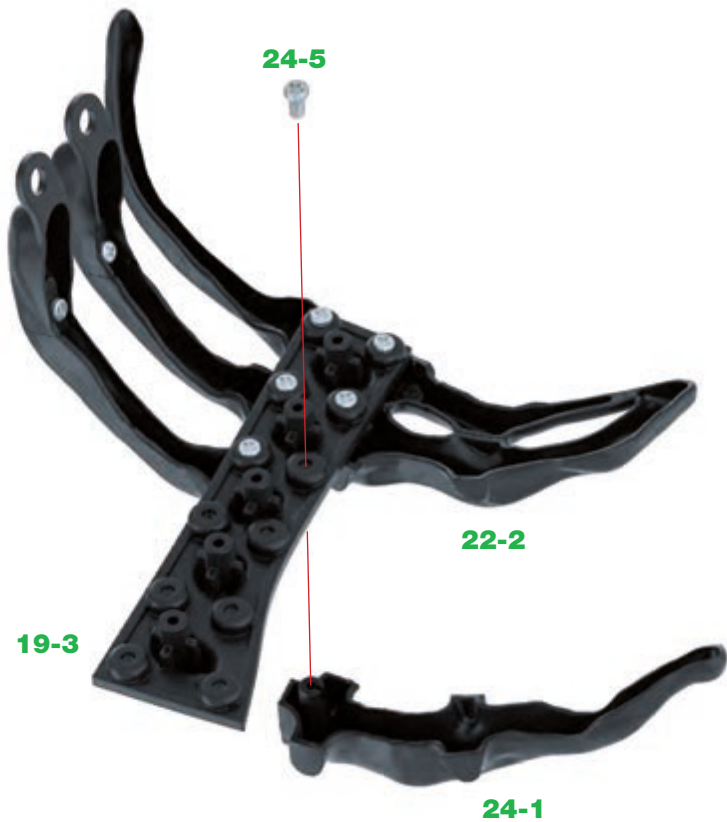

Take the right leg assembly which was worked on in kit 23 along with Pipe A3 **24-2**. After test-fitting, apply a little glue to the tabs on Pipe A3 **24-2** and firmly secure in place on Skin **4-4**.

KIT 24: THE RIGHT RIBS AND THE LEG (IV)

3

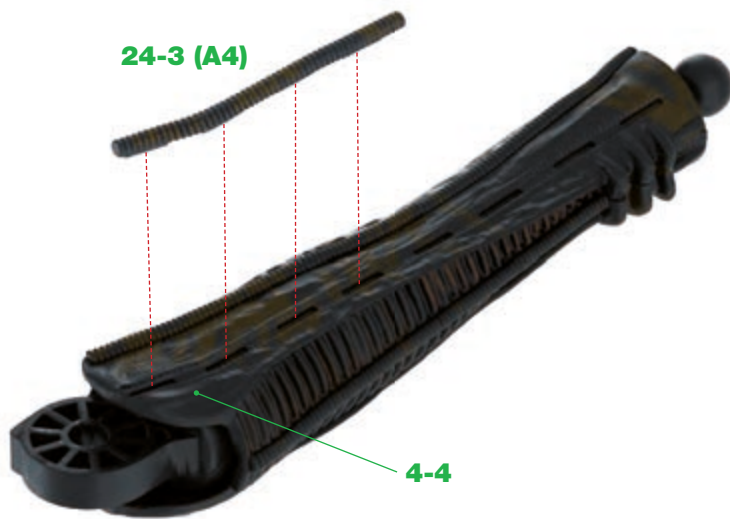

Repeat the previous step to attach Pipe A4 **24-3** in the position shown on the Calf Skin **4-4**.

Check the orientation of Pipe A5 **24-4** by test-fitting and glue the pipe in place.

4

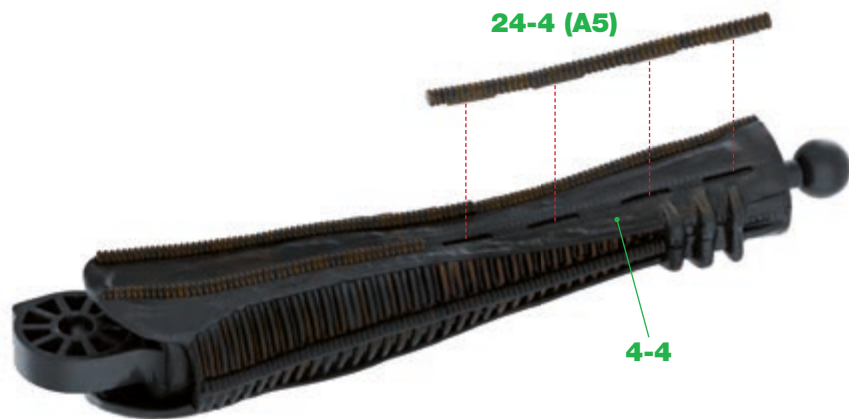

KIT 24 IS COMPLETE



ANOTHER RIB HAS BEEN ADDED AND MORE PIPES FITTED TO THE RIGHT LEG.

KIT 25: THE RIGHT RIBS AND THE RIGHT FEMUR (I)

In this kit you will continue to work on the Xenomorph's right ribs and start the assembly of the right femur.



PARTS SUPPLIED

Ref.	Name	Qty.	Ref.	Name	Qty.
25-1	Right Rib	1	25-4	Connector	1
25-2	Right Rib	1	25-5	2.3x6mm screws (1 spare)	2
25-3	Right Femur	1	25-6	2.3x4mm screws (1 spare)	3

KIT 25: THE RIGHT RIBS AND THE RIGHT FEMUR (I)

25-2

25-6

25-1

Rib parts **25-1** and **25-2** are joined together with a 2.3x4mm screw **25-6**. Note how a locating peg on Rib **25-2** fits into a raised hole in Rib **25-1**.

1

25-6

23-1

19-3

25-2

Take the rib support assembly **19-3**, which was worked on in the last kit and fit the raised screw socket on Rib **25-2** into the corresponding hole in part **19-3**. Fix in place with a 2.3x4mm screw **25-6**.

2

KIT 25: THE RIGHT RIBS AND THE RIGHT FEMUR (I)

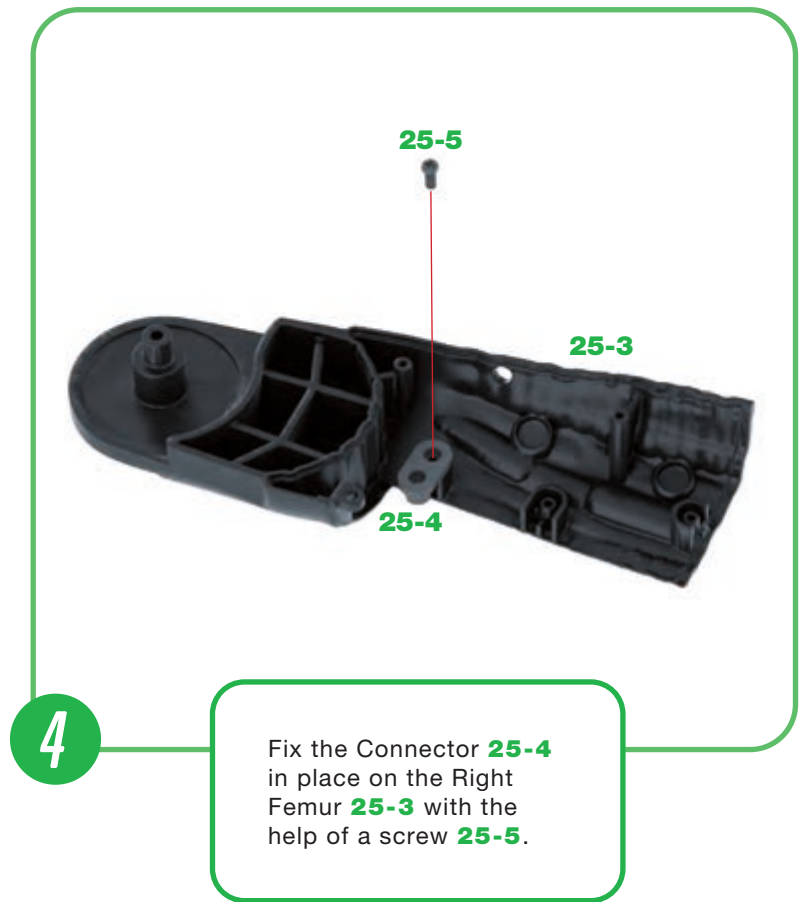

KIT 25 IS COMPLETE



*ANOTHER RIB HAS BEEN FITTED
AND WORK HAS BEGUN ON THE
RIGHT FEMUR.*

KIT 26: THE RIGHT RIBS AND THE RIGHT FEMUR (II)

In this kit you will continue to build the Xenomorph's right ribs and right femur.



PARTS SUPPLIED

Ref.	Name	Qty.	Ref.	Name	Qty.
26-1	Right Rib	1	26-4	2.3x6mm screw black (1 spare)	4
26-2	Right Femur	1	26-5	2.3x6mm screw silver (1 spare)	2
26-3	Connector	1			

KIT 26: THE RIGHT RIBS AND THE RIGHT FEMUR (II)

EXPERT ADVICE

Throughout the build, there are two main types of screws used; those for metal and those for plastic. In this kit the black screws **26-4** are for plastic and the silver screws **26-5**, which have a finer thread, are for metal.

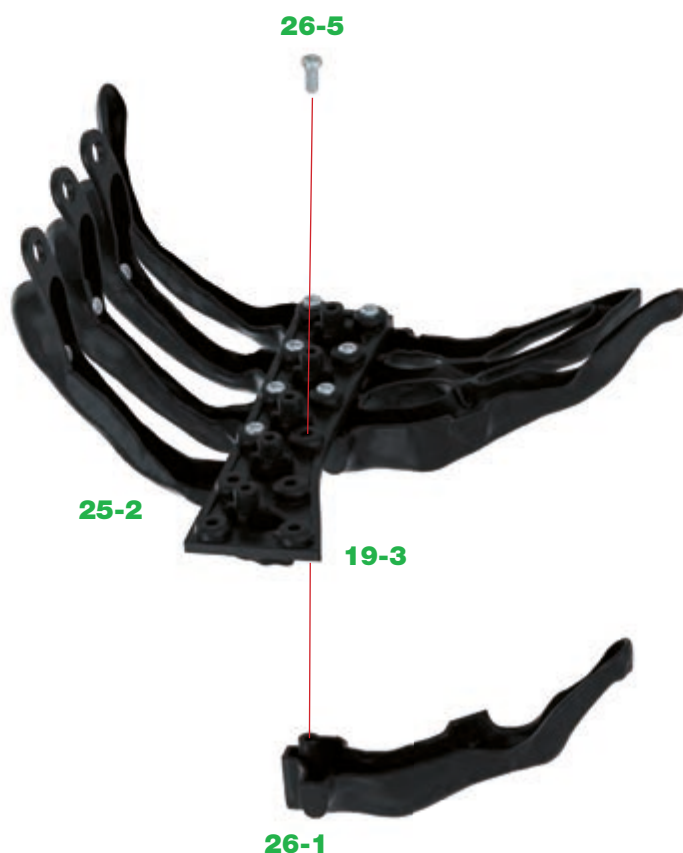

Take the rib support assembly **19-3** from the previous kit along with Rib **26-1**. Insert the raised screw socket on Rib **26-1** into the corresponding hole in the support assembly **19-3**, as shown. Fix in place with a 2.3x6mm screw **26-5** (silver).

1

The Right Femur **26-2** is now attached to the femur assembly **25-3**. There is a hole in part **25-4** (circled) which fits over a peg on part **26-2** (arrow). This had a connector fitted to it in kit 25. The previously fitted Connector **25-4** fits into the raised screw socket on part **26-2**, as shown. It may help to temporarily loosen the connector during this step.

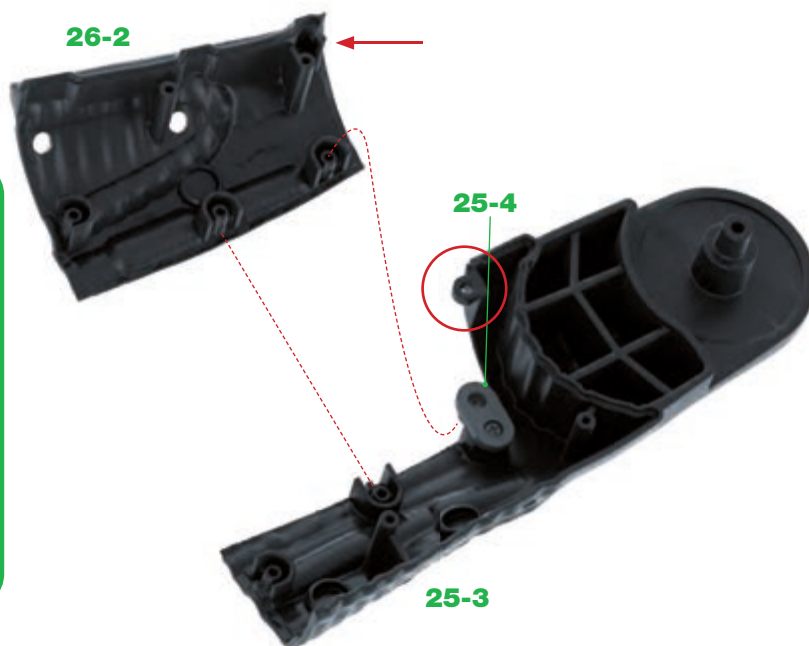

2

KIT 26: THE RIGHT RIBS AND THE RIGHT FEMUR (II)

3

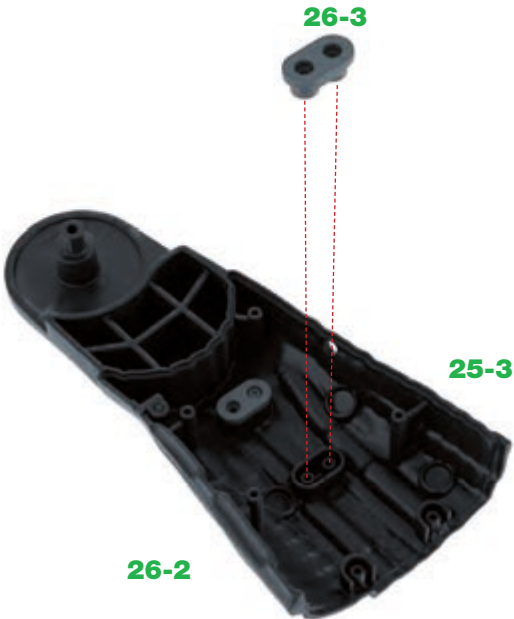

Diagram 3 shows a black plastic component, labeled 25-3, with a recessed area. A small black connector, labeled 26-3, is being inserted into this recess. The connector is also labeled 26-2. Red dashed lines indicate the alignment of the connector with the recess.

Similarly, the Connector **26-3** is fitted into the other oval recess formed by parts **25-3/26-2**, as indicated.

4

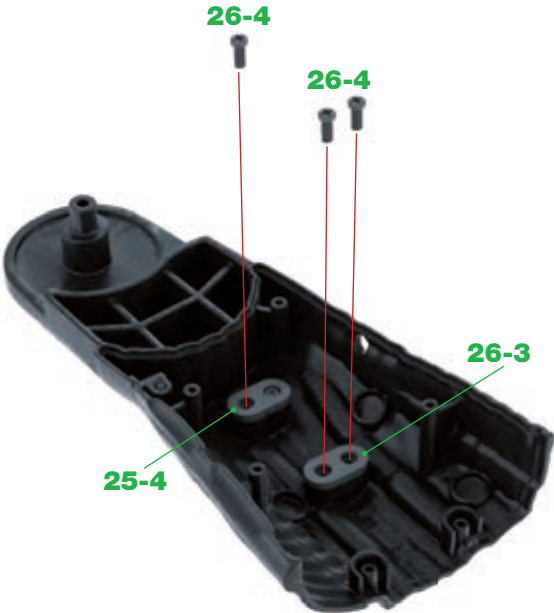

Diagram 4 shows the same black plastic component, labeled 25-4, with two connectors, labeled 26-3, already in place. Three black screws, labeled 26-4, are being used to secure the connectors. Red lines indicate the screws passing through the plastic and the connectors.

Using three 2.3x6mm screws **26-4** (black) secure the Connectors **25-4** and **26-3** in place.

KIT 26 IS COMPLETE

WORK HAS CONTINUED ON THE RIGHT FEMUR AND ANOTHER RIB HAS BEEN FITTED.



KIT 27: THE RIGHT RIBS AND THE RIGHT FEMUR (III)

In this kit you will continue to build the Xenomorph's right ribs and right femur.



PARTS SUPPLIED

Ref.	Name	Qty.	Ref.	Name	Qty.
27-1	Right Rib	1	27-4	Connector	2
27-2	Right Rib	1	27-5	2.3x6mm screws (1 spare)	3
27-3	Right Femur	1	27-6	2.3x4mm screws (1 spare)	3

KIT 27: THE RIGHT RIBS AND THE RIGHT FEMUR (III)

1

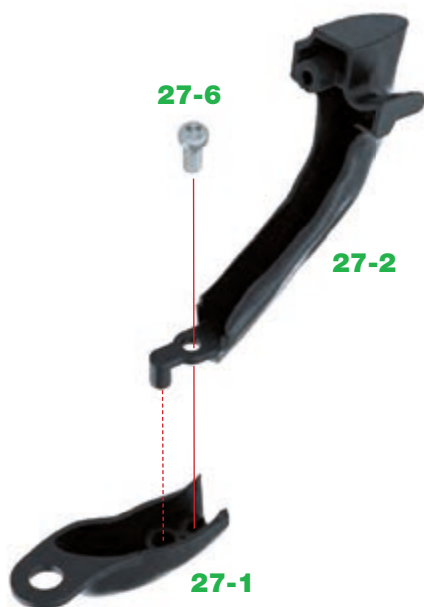

The next rib is formed using parts **27-1** and **27-2**. There is a locating pin on Rib **27-2** which engages into a corresponding hole in Rib **27-1**. Secure the two parts together using a 2.3x4mm screw **27-6**.

As with the previous ribs, fit the raised screw socket on Rib **27-2** into the corresponding hole in the rib support **19-3**. Fix in place from behind using a 2.3x4mm screw **27-6**. Put the assembly safely aside until the next kit.



2

KIT 27: THE RIGHT RIBS AND THE RIGHT FEMUR (III)

27-5

27-4

27-3

3

Next, take Right Femur **27-3**, supplied with this kit and fit one of the Connectors **27-4**, as shown. Secure in place with a 2.3x6mm screw **27-5**.

27-5

27-4

27-3

4

Repeat the previous step to add a second Connector **27-4** to the Femur, as indicated. Secure in place with a 2.3x6mm screw **27-5**.

KIT 27 IS COMPLETE

A FURTHER RIB HAS BEEN ADDED TO THE FRAME AS WELL AS CONNECTORS TO THE FEMUR.



KIT 28:THE RIGHT RIBS AND THE RIGHT FEMUR (IV)

In this kit you will continue to build the Xenomorph’s right ribs and right femur.



SUPPLIED PARTS

Ref.	Name	Qty.	Ref.	Name	Qty.
28-1	Right Rib	1	28-4	2.3x6mm screws Black (1 spare)	7
28-2	Right Femur	1	28-5	2.3x6mm screws Silver (1 spare)	2
28-3	Connector	2			

KIT 28: THE RIGHT RIBS AND THE RIGHT FEMUR (IV)

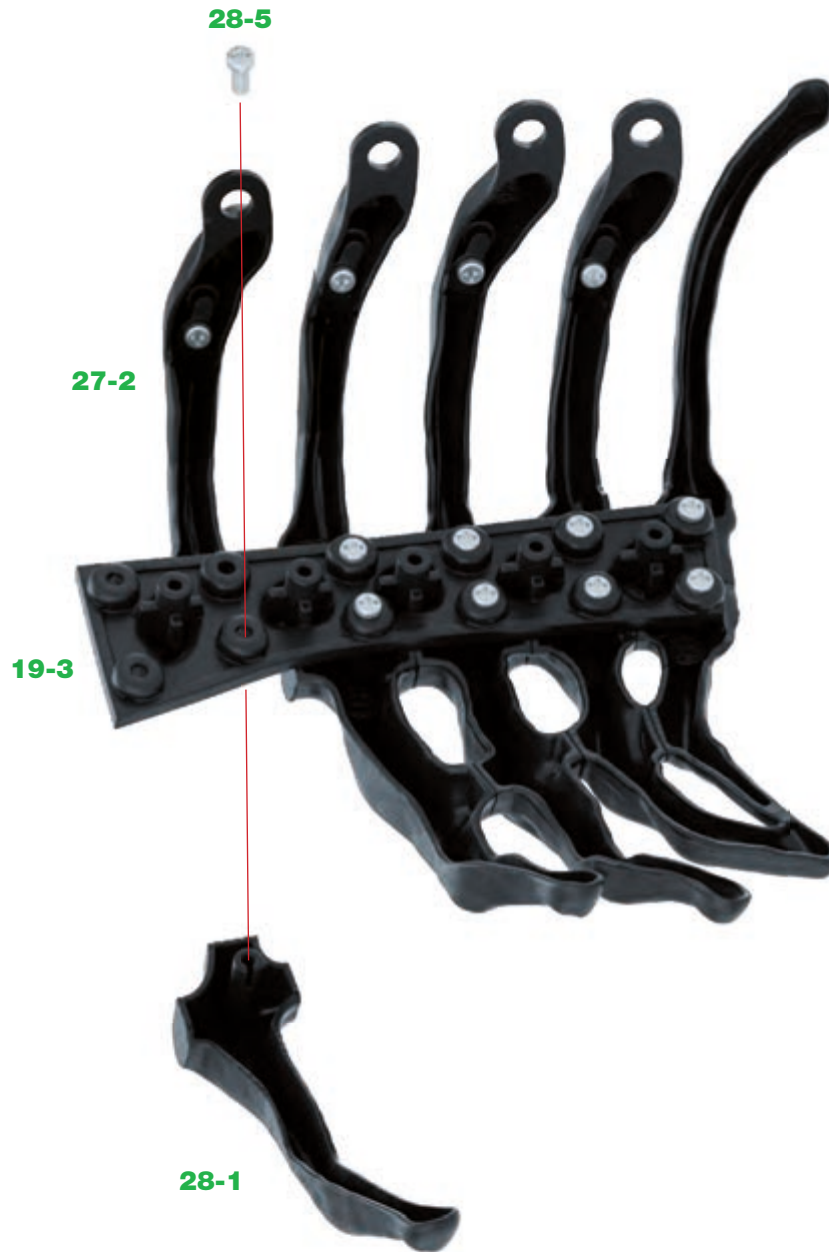

Take the rib support **19-3** which was worked on in the last kit. Fit the raised screw socket on Rib **28-1** into the hole in the support **19-3** on the opposite side to Rib **27-2**. Fix in place with a 2.3x6mm silver screw **28-5**. Put aside until it is needed in the next kit.

KIT 28: THE RIGHT RIBS AND THE RIGHT FEMUR (IV)

Next, the Right Femur **28-2** is joined to the right femur assembly **27-3** (from kit 27). Place the free end of the previously fitted Connectors **27-4** into the sockets on Rib **28-2**. You may find that you need to temporarily loosen the connector screws for the parts to fit. Secure in place with two 2.3x6mm black screws **28-4**.



2

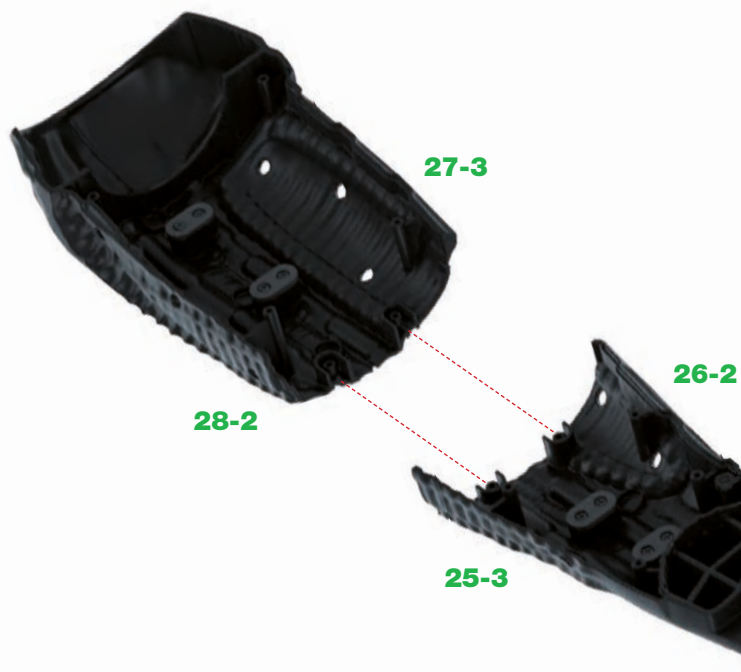

Take the right femur assembly **25-3/26-2** from kit 26 and align it with the femur assembly **27-3/28-2**, as shown.

3

KIT 28: THE RIGHT RIBS AND THE RIGHT FEMUR (IV)

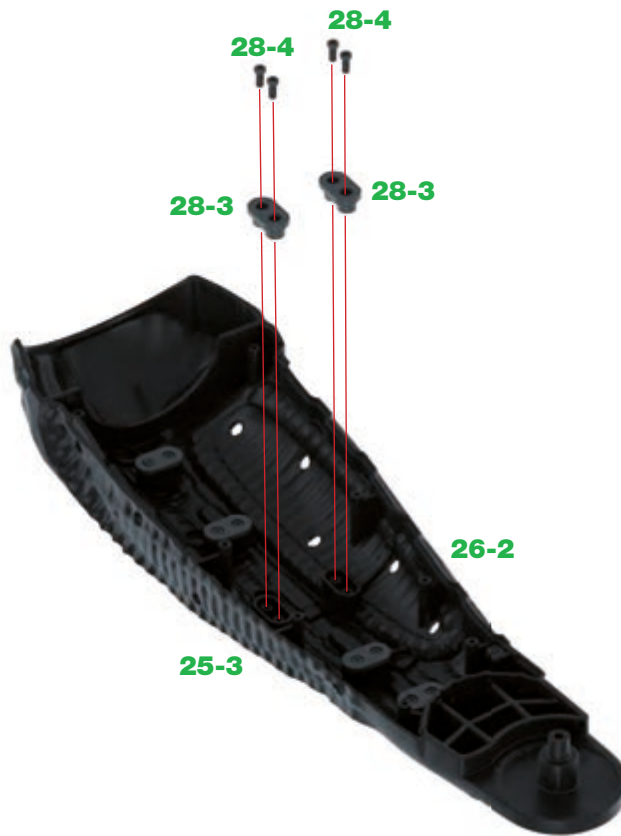

Fit the Connectors **28-3** into the matching recesses, as shown and fix them in place using four 2.3x6mm black screws **28-4**.

4

KIT 28 AND PACK 4 IS NOW COMPLETE

ANOTHER RIB HAS BEEN ADDED TO THE FRAME AND MORE OF THE RIGHT FEMUR HAS BEEN ASSEMBLED.

