

# ALIEN

SPECTACULAR

1:2  
SCALE

EASY  
ASSEMBLY

BUILD THE  
TERRIFYING  
XENOMORPH  
FROM ALIEN

PACK 8  
KITS 53 - 60

# ALIEN

## PACK 8 | BUILD INSTRUCTIONS



### KIT 53

THE LEFT HAND (II)

### KIT 54

THE LEFT HAND (III)

### KIT 55

THE LEFT RADIUS

### KIT 56

THE RADIUS &  
THE HUMERUS

### KIT 57

THE LEFT HUMERUS

### KIT 58

THE LEFT HUMERUS (II)

### KIT 59

THE LEFT HUMERUS (III)

### KIT 60

THE LEFT ARM (I)

**WARNING:** Some parts are assembled using magnets. These magnets can cause serious injury if they are swallowed. Keep away from children. If you suspect a magnet has been swallowed, seek medical help straight away.

Some parts may have sharp edges, please handle them with care.

The installation of electronic parts must always be carried out by an adult. When replacing batteries, use the same type of batteries.

Please ensure that the battery compartment is securely fastened before you use the model.

Used batteries should be recycled.

Please make sure to check with your local council how batteries should be disposed of in your area. Batteries can present a choking danger to small children and may cause serious harm if ingested. Do not leave them lying around and keep any spare batteries locked away at all times.



STEPS & TIPS ONLINE

**Hachette Partworks Ltd**, 4th Floor, Jordan House,  
47 Brunswick Place, London N1 6EB

[www.hachettepartworks.com](http://www.hachettepartworks.com)

© 2023/2024 Hachette Partworks Ltd.

© 2023 20th Century Studios.

ALL RIGHTS RESERVED

All parts belong to a kit. Collectors item for adults.

Not suitable for children under 14.



## KIT 53: THE LEFT HAND (II)

In this kit you will continue to build the left hand.



### PARTS SUPPLIED

Ref.	Name	Qty.	Ref.	Name	Qty.
53-1	Left Radius Skin	1	53-5	Left Finger L6	1
53-2	Left Hand	1	53-6	Connector	1
53-3	Left Finger L4	1	53-7	Magnets	6
53-4	Left Finger L5	1	53-8	2.3x6mm screws (1 spare)	4

## KIT 53: THE LEFT HAND (II)

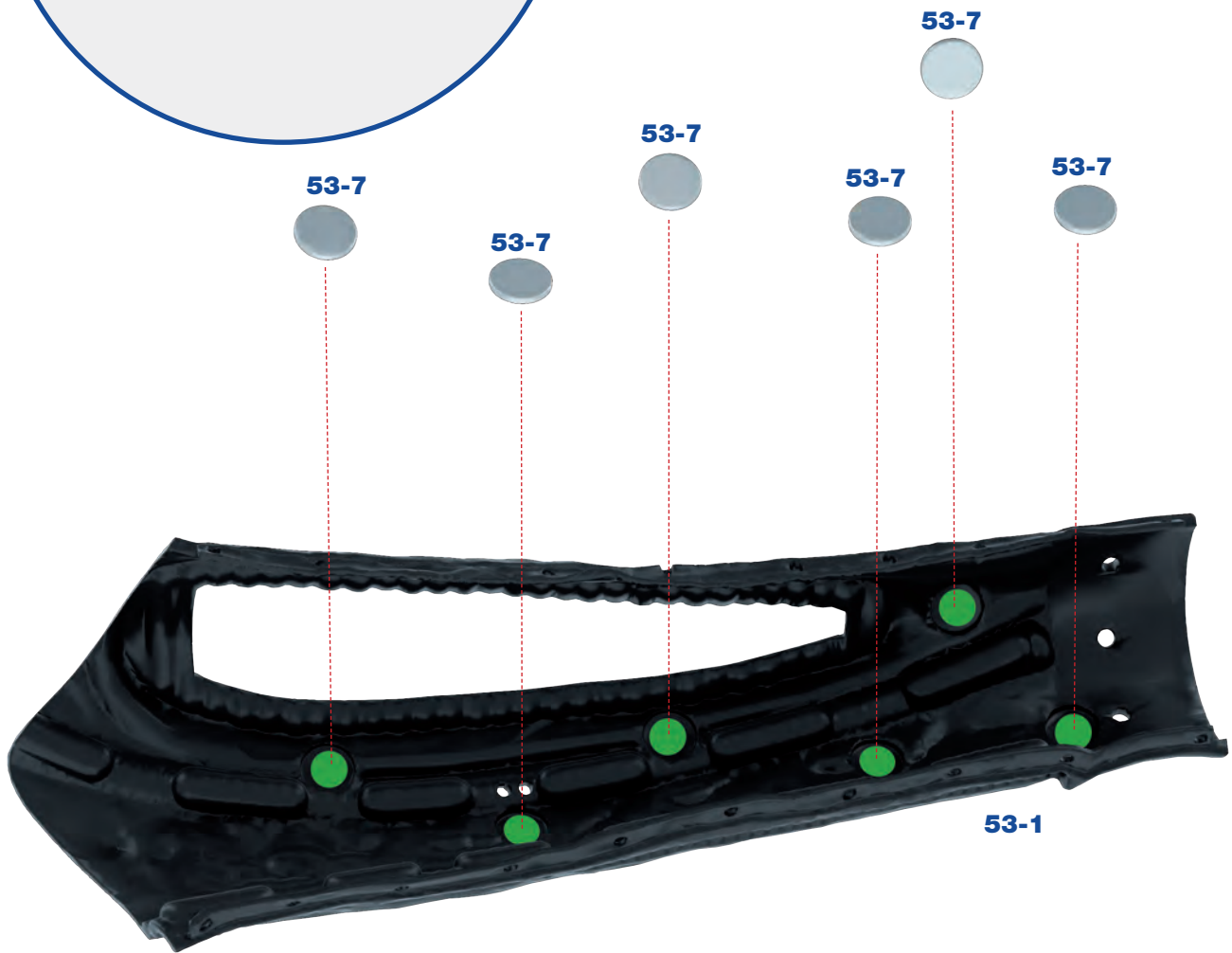
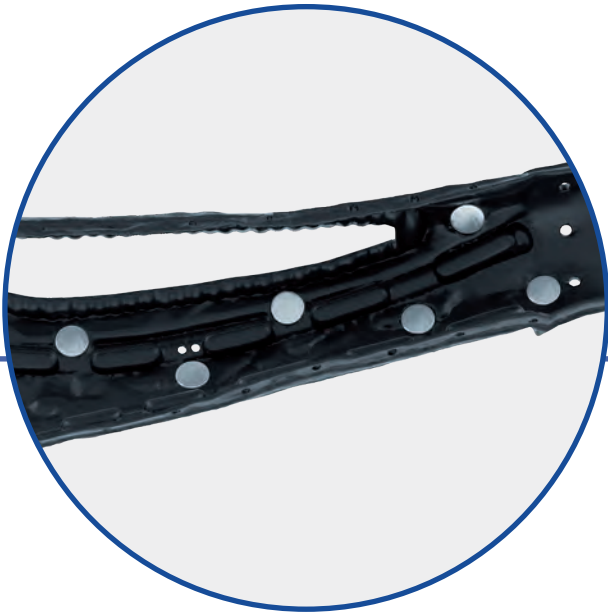

1

Glue six magnets **53-7** into the circular recesses inside the Left Radius Skin **53-1**. It doesn't matter which way round the magnets are fitted.

## KIT 53: THE LEFT HAND (II)



After checking the fit of Left Finger L5 **53-4** on the back of the Left Hand **53-2**, glue in place.

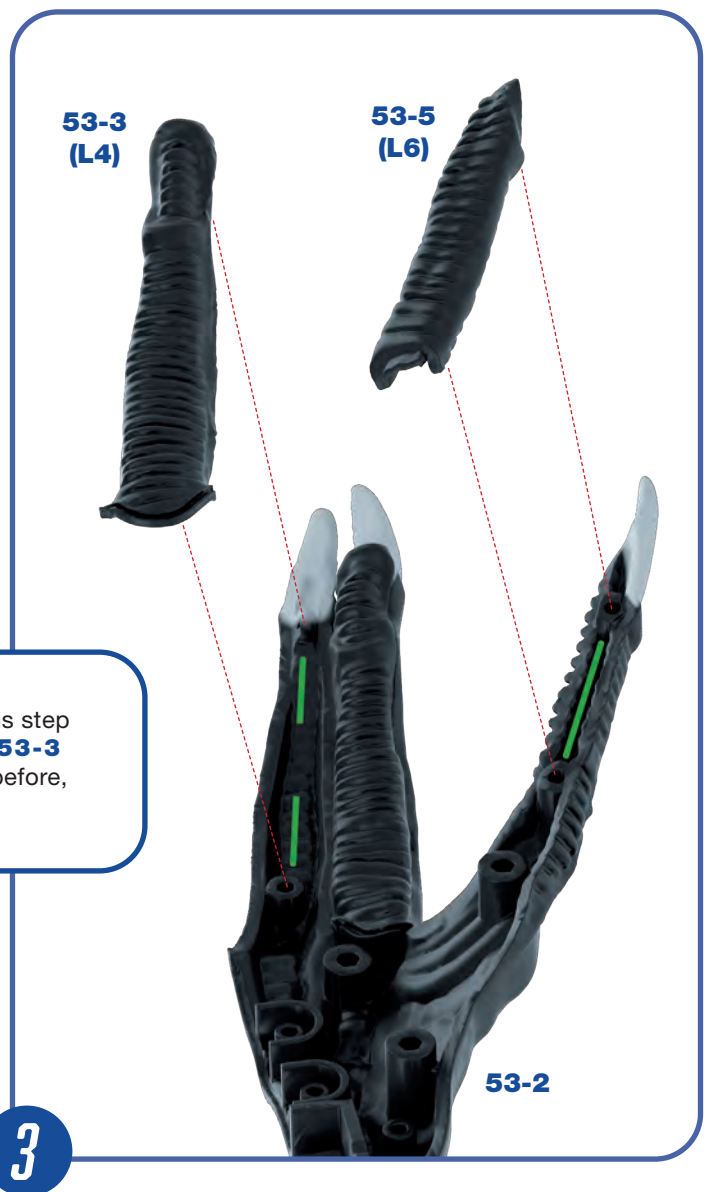

Repeat the previous step to add Fingers L4 **53-3** and L6 **53-5**. As before, glue in place.

## KIT 53: THE LEFT HAND (II)

Take the Left Hand **52-1** which was assembled in pack 7 - kit 52. Fit the free side of the Connector **52-5** over the raised screw socket on the back of Hand **53-2** and fix in place with a 2.3x6mm screw **53-8**. Whilst doing this, it may help to temporarily loosen the previously fitted screw.

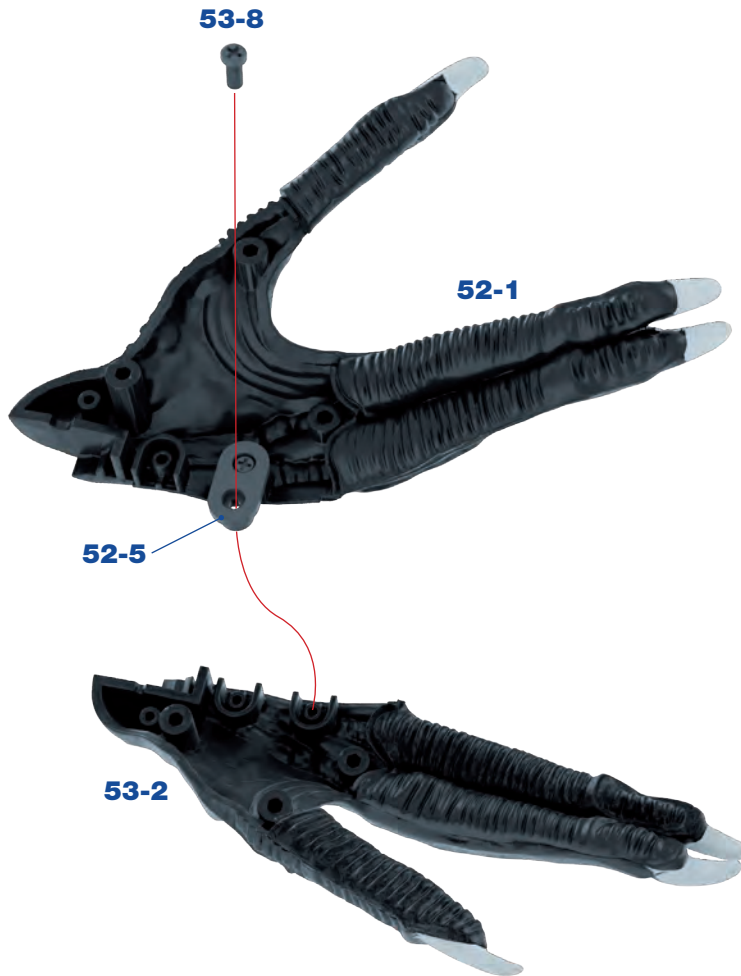

4

### KIT 53 IS COMPLETE

*MAGNETS HAVE BEEN FIXED TO THE RADIUS SKIN AND WORK HAS CONTINUED ON THE LEFT HAND.*



! Keep the screws and connector in a safe place until they are needed in the next kit.

# KIT 54: THE LEFT HAND (III)

In this kit you will continue to work on the left hand and left radius.



## PARTS SUPPLIED

Ref.	Name	Qty.	Ref.	Name	Qty.
54-1	Left Radius	1	54-6	Pipe A2	1
54-2	Left-hand Palm	1	54-7	Pin	1
54-3	Wrist Joint	1	54-8	Magnets	6
54-4	Bracket	1	54-9	2.3x6mm screws (1 spare)	3
54-5	Pipe A1	1			

## KIT 54: THE LEFT HAND (III)

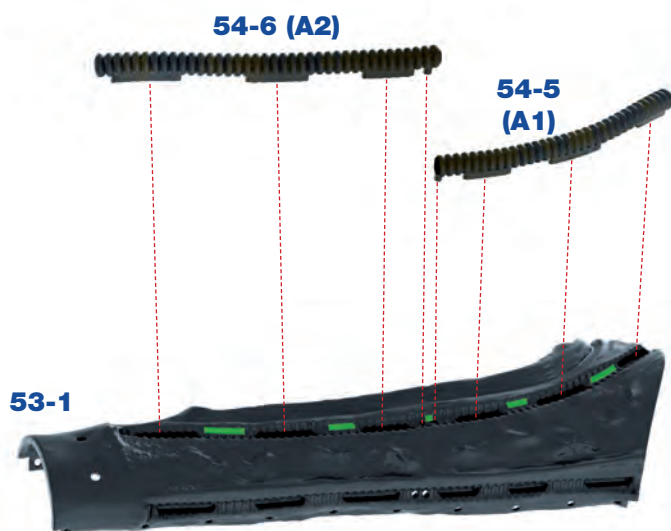

Take the left radius skin **53-1** from the previous kit. After test-fitting, glue Pipes A2 **54-6** and A1 **54-5** into the slots at the side, as shown. Note the locating peg at one end of each of the Pipes.

1



Turn the skin **53-1** over and fit the Left Radius **54-1** inside.



2

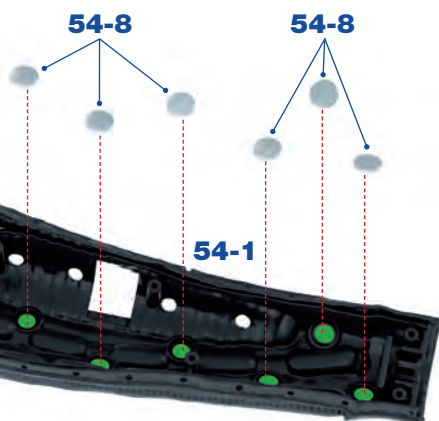

Fit six Magnets **54-8** into the circular recesses on the inside of the Left Radius **54-1**. Before glueing in place, make sure that they are correctly orientated so that they are attracted to the corresponding magnets in the skin **53-1** below.

3

## KIT 54: THE LEFT HAND (III)

Insert the Pin **54-7** into the central hole in the Wrist Joint **54-3**.



4

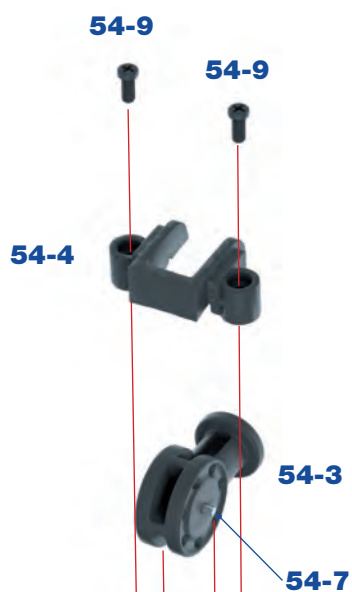

Take the left hand assembly from the previous kit and fit the Wrist Joint **54-3** into the slot in the hand formed by parts **52-1** and **53-2**. The ends of the Pin **54-7** should rest in recesses on the hand parts **52-1** and **53-2**. Orientate the Bracket **54-4**, as shown and fit the screw holes over the raised screw sockets on parts **52-1** and **52-3**. When sure of a good fit, secure in place with two 2.3x6mm screws **54-9**.



5

## KIT 54: THE LEFT HAND (III)

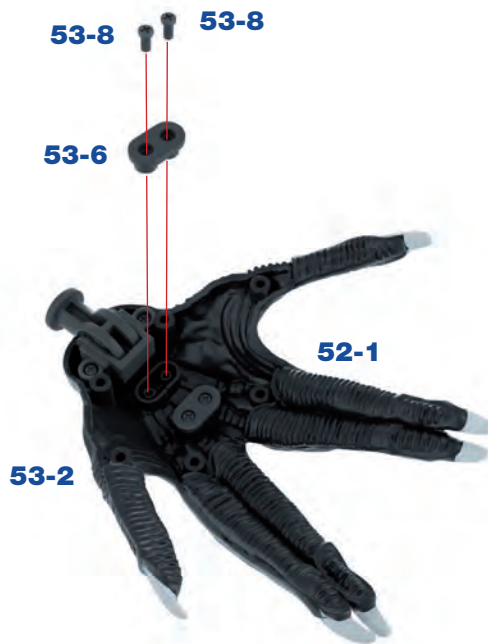

6

The connector **53-6**, supplied with the previous kit, is fitted across parts **52-1** and **53-2**, as shown. Using two of the 2.3x6mm screws **53-8**, again supplied with the previous kit, fix the connector **53-6** in place.

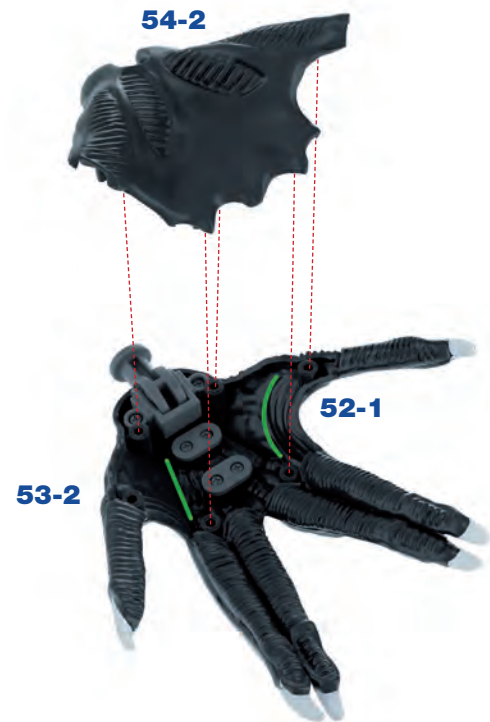

7

Test-fit the pegs on the underside of the Left-hand Palm **54-2** into the remaining holes in the hand assembly **52-1/53-2**. When certain of a good fit, glue in place.

## KIT 54 IS COMPLETE



*MAGNETS HAVE BEEN ADDED TO THE RADIUS AND THE LEFT HAND HAS BEEN COMPLETED.*

# KIT 55: THE LEFT RADIUS

In this kit you will continue to build the left radius and its appendages.



## PARTS SUPPLIED

Ref.	Name	Qty.	Ref.	Name	Qty.
55-1	Left Radius Skin	1	55-5	Pipe A4	1
55-2	Radius Protector	1	55-6	Left Wrist	1
55-3	Radius Protector	1	55-7	Magnets	6
55-4	Pipe A3	1	55-8	2.3x4mm screws (1 spare)	3

## KIT 55: THE LEFT RADIUS

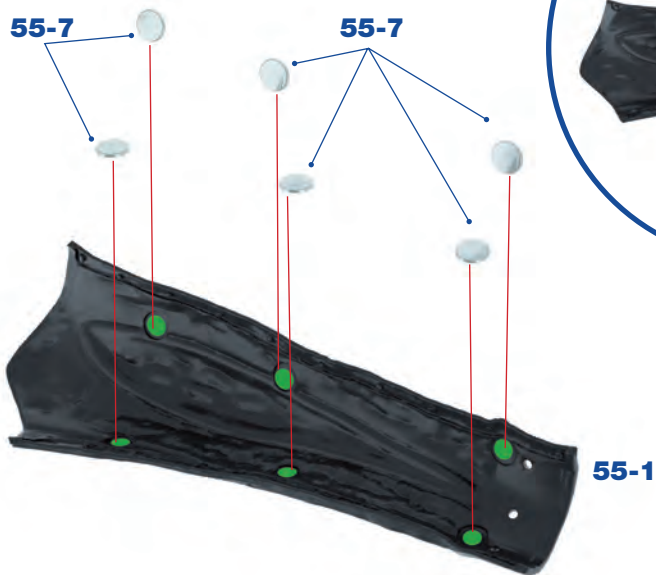

Lay the Left Radius Skin **55-1** on the work surface and glue six Magnets **55-7** into the circular recesses, as shown. It doesn't matter which way round the magnets are fitted.

1

Take the radius assembly **53-1/54-1** from the previous kit and separate the two parts. Put the radius **54-1** to one side, leaving just the skin **53-1**.



2



Fit the tabs of the Pipe A4 **55-5** into the slots along the outer edge of the skin covering **53-1**. Glue in place once you are happy with the fit.

3

**KIT 55: THE LEFT RADIUS**

4

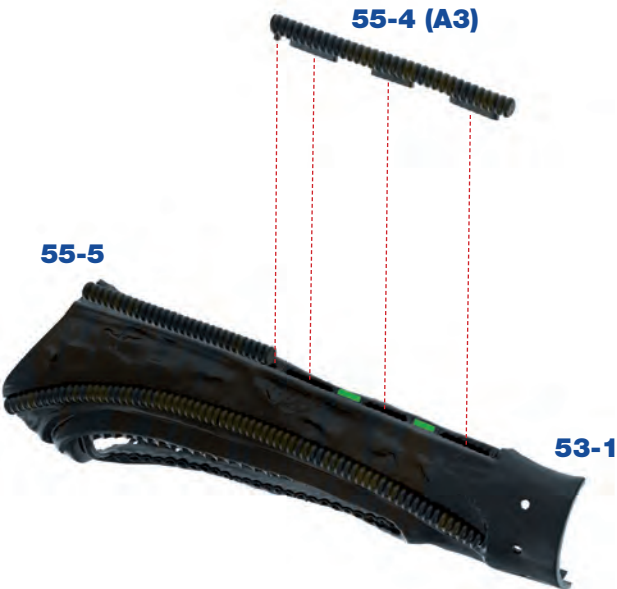

Repeat the previous step to fit Pipe A3 **55-4** into the remaining slots in the skin **53-1**.

5



Join the two parts of the Radius Protector **55-2** and **55-3** together, as shown. Secure in place using two 2.3x4mm screws **55-8**.

**KIT 55 IS COMPLETE**



*MAGNETS AND PIPES HAVE BEEN ADDED TO THE RADIUS SKIN AND THE RADIUS PROTECTOR ASSEMBLED.*

# KIT 56: THE RADIUS AND THE HUMERUS

In this kit you will complete the build of the left radius and start assembling parts of the humerus.



## PARTS SUPPLIED

Ref.	Name	Qty.	Ref.	Name	Qty.
56-1	Left Radius	1	56-5	Pipe A7	1
56-2	Left Humerus Skin	1	56-6	Magnets	10
56-3	Pipe A5	1	56-7	2.3x6mm screws (1 spare)	7
56-4	Pipe A6	1			

## KIT 56: THE RADIUS AND THE HUMERUS

1



Take the skin **55-1** from the previous kit and place the Left Radius **56-1** inside it.

56-1



55-1

2

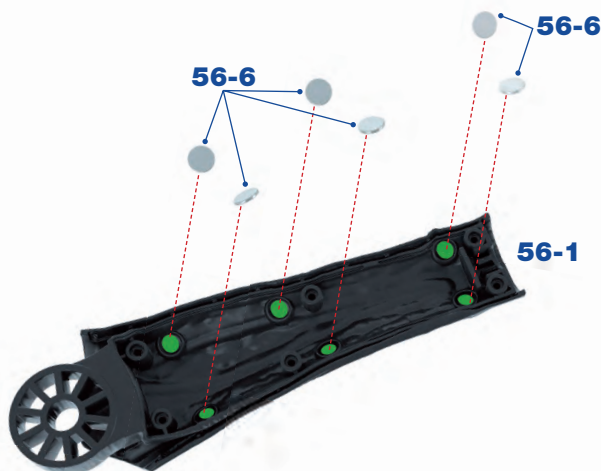

Fit six Magnets **56-6** into the circular recesses inside the Radius **56-1**. After checking that the magnets are orientated so that they are attracted to those directly below, glue them in position. Once the glue has set, separate the parts and put the skin **55-1** to one side.

3



Take the radius **54-1** and the hand assembly which was worked on in kit 54. Sandwich the wrist joint **54-3** between the ends of Radius parts **54-1** and **56-1**. See also the next step.

**KIT 56: THE RADIUS AND THE HUMERUS**

**4**

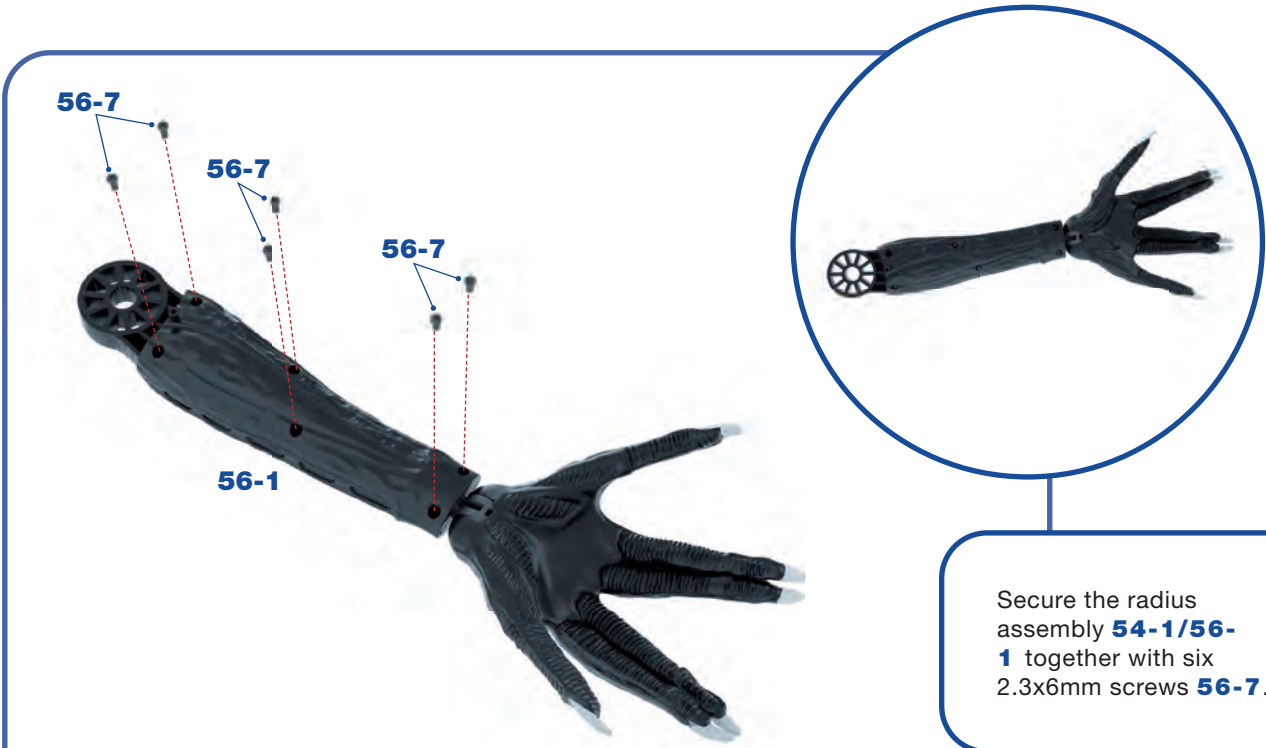

Secure the radius assembly **54-1/56-1** together with six 2.3x6mm screws **56-7**.

**5**

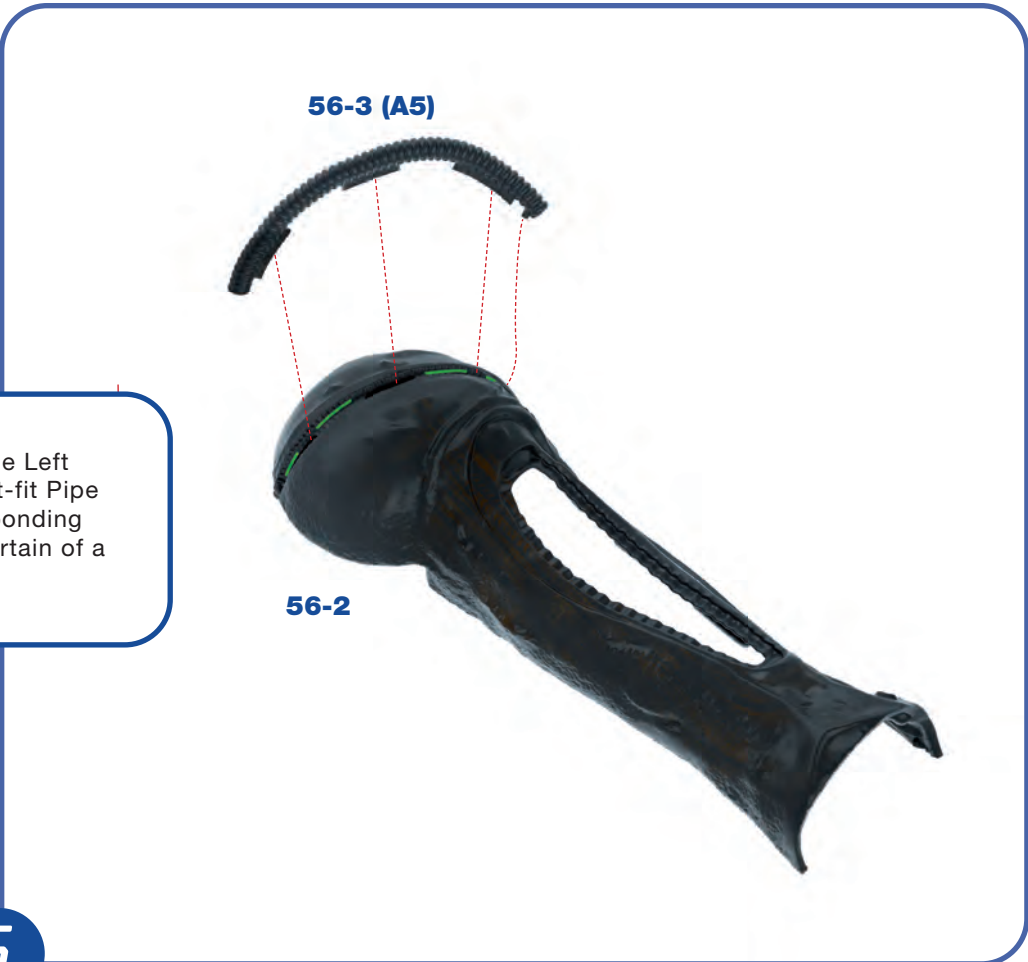

Pipes are now fitted to the Left Humerus Skin **56-2**. Test-fit Pipe A5 **56-3** into the corresponding slots, as shown. Once certain of a good fit, glue in place.

## KIT 56: THE RADIUS AND THE HUMERUS

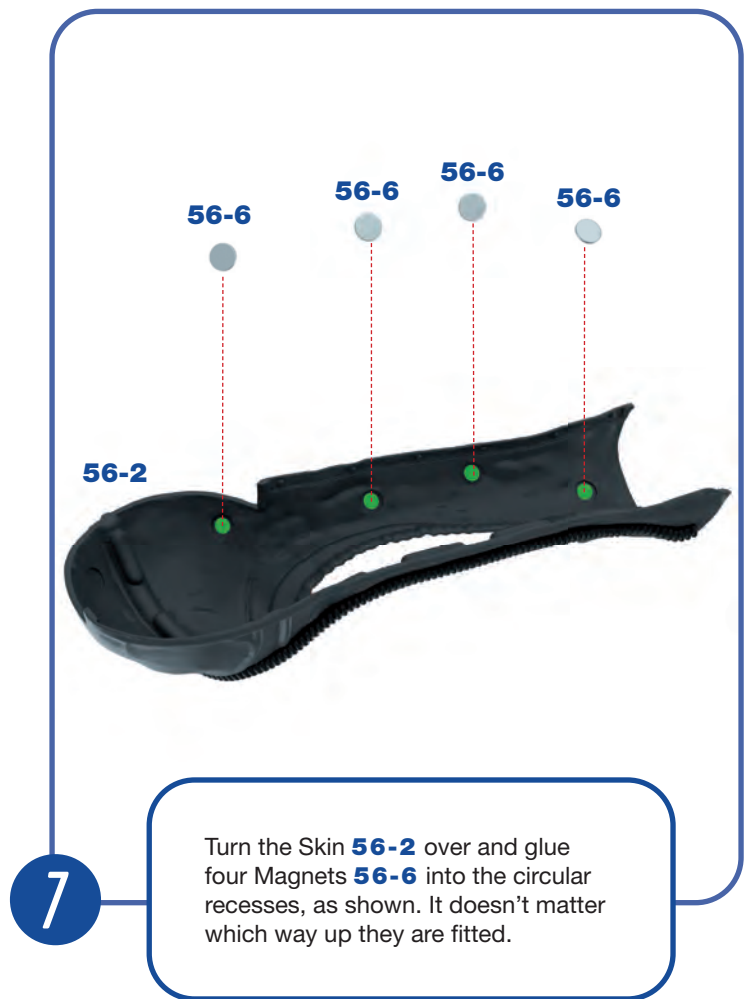

### KIT 56 IS COMPLETE



*THE RADIUS HAS BEEN ATTACHED TO THE HAND AND WORK HAS BEGUN ON THE LEFT HUMERUS.*

# KIT 57: THE LEFT HUMERUS

In this kit you will build the outer skin covering of the left humerus and its appendages.

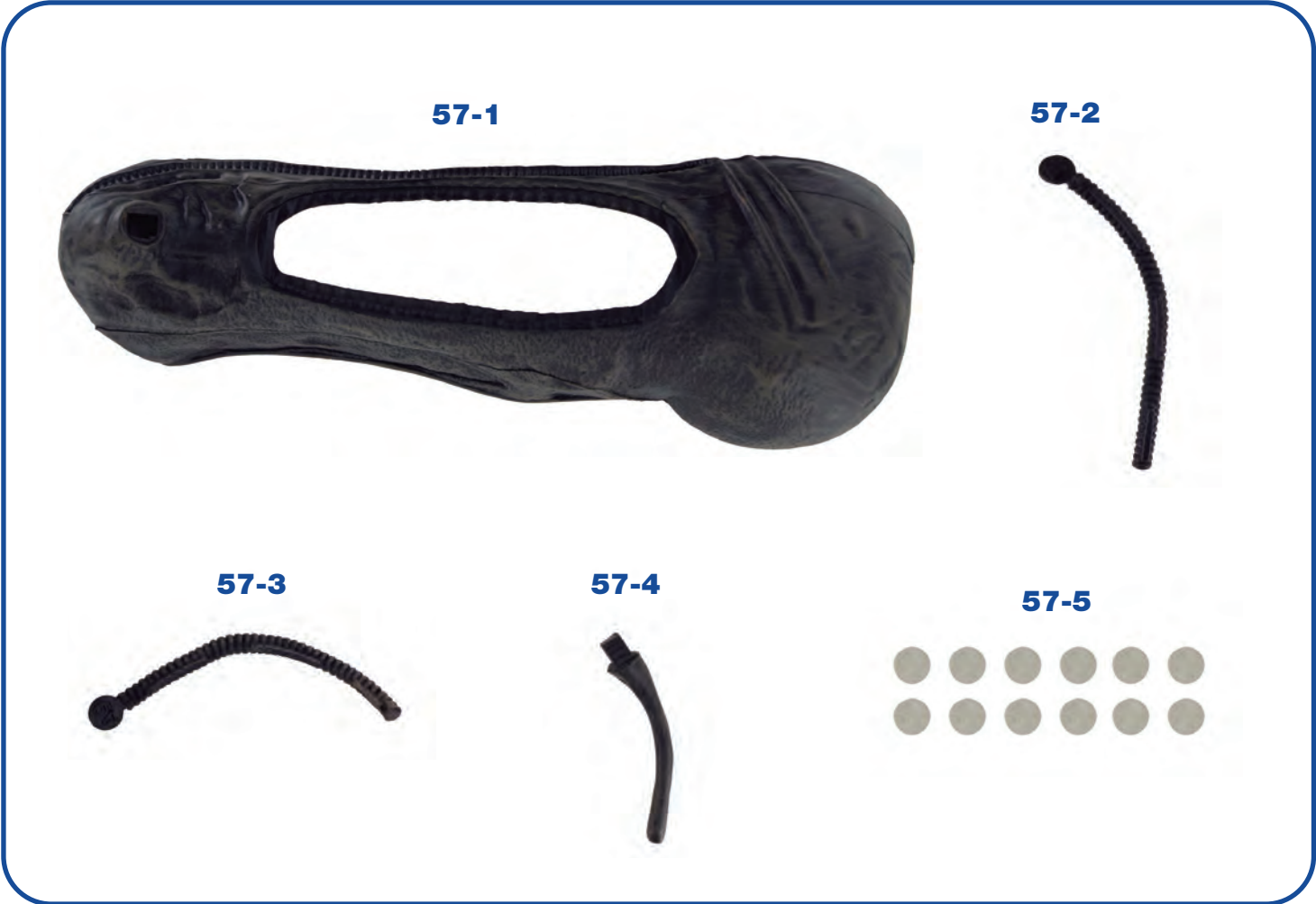

## PARTS SUPPLIED

Ref	Name	Qty	Ref	Name	Qty
57-1	Left Humerus Skin	1	57-4	Humerus Appendage	1
57-2	Pipe A8	1	57-5	Magnets	12
57-3	Pipe A9	1			

## KIT 57: THE LEFT HUMERUS

**57-1**

**57-2 (A8)**



Take the Left Humerus Skin **57-1** and test-fit the tabs on Pipe A8 **57-2** into the slots along the side. When certain of a good fit, glue in place.

**1**

Repeat the previous step to glue Pipe A9 **57-3** in place, as shown. It is a continuation of Pipe A8 **57-2**.

**57-3 (A9)**



**57-1**

**2**

**KIT 57: THE LEFT HUMERUS**



Turn the Left Humerus Skin **57-1** over and glue eight Magnets **57-5** into the circular recesses inside. It doesn't matter which way up the magnets are fitted. The upper-left inset shows where to place the two magnets not visible in the main image. The lower-right inset shows a general view of the assembly after the magnets have been attached.

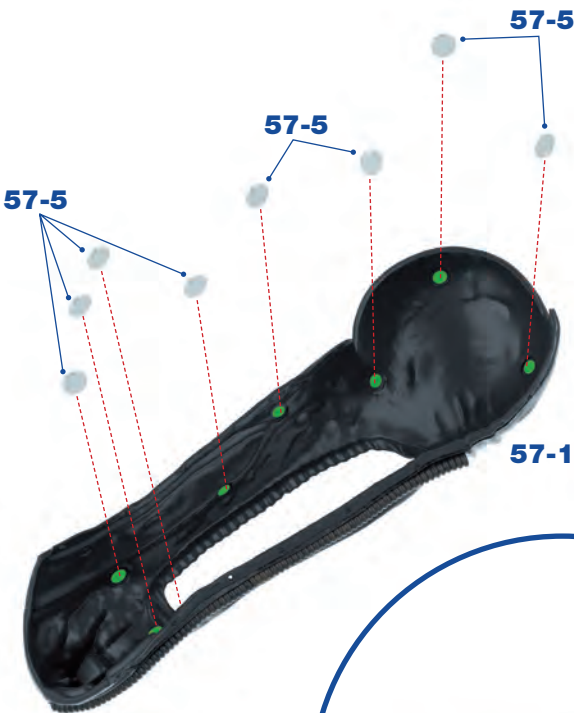

**3**



Turn the skin assembly **57-1** over and fit the peg on the Humerus Appendage **57-4** into the rectangular slot at the end of the Skin **57-1**. The peg is shaped to ensure that it is fitted the correct way round. After test-fitting, glue in place.

**4**

## KIT 57: THE LEFT HUMERUS

57-5

57-5

Take the humerus skin **56-2** from the previous kit. Glue four Magnets **57-5** into the circular recesses on the inside of the skin. It doesn't matter which way up they are fitted.

56-2



5

**KIT 57 IS COMPLETE**

*PIPES, MAGNETS AND AN APPENDAGE HAVE BEEN FITTED TO THE HUMERUS SKIN.*



# KIT 58: THE LEFT HUMERUS (II)

In this kit you will continue working on parts of the Xenomorph's left humerus.



## PARTS SUPPLIED

Ref	Name	Qty
58-1	Left Humerus	1
58-2	Left Humerus	1
58-3	Humerus Protector	1

Ref	Name	Qty
58-4	Humerus Protector	1
58-5	Magnets	8
58-6	2.3x4mm screws (1 spare)	3

## KIT 58: THE LEFT HUMERUS (II)

**1**

**58-1**

**56-2**

Take the humerus skin **56-2** from kit 56 and fit Humerus **58-1** inside.



### EXPERT TIP:

As many of the parts are similar and need to be kept to one side at times, it may help to label each part on the underside. This could be done by writing the part number on a small piece of masking tape.

**2**

**58-5**

**58-1**

**58-1**

**56-2**

Fit four Magnets **58-8** into circular recesses inside Humerus **58-1**. After checking that the magnets are attracted to those directly below, glue them in place. Once the glue has set, separate the parts and put Humerus **58-1** to one side.

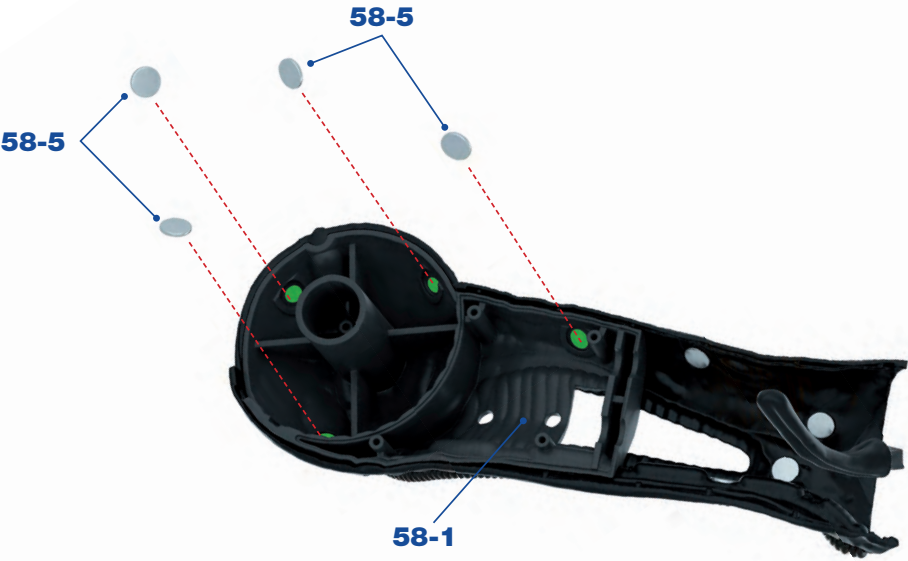

## KIT 58: THE LEFT HUMERUS (II)

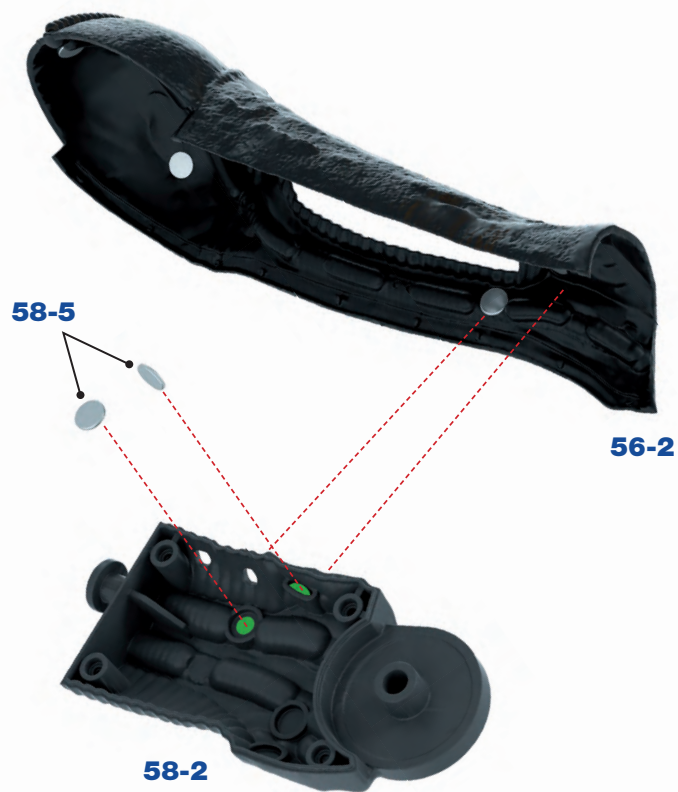

3

With the humerus skin **56-2** still on the work surface, place the Left Humerus **58-2** inside it sideways, as shown. Fit two Magnets **58-5** into a slot and circular recess inside Humerus **58-2**. After checking that the Magnets **58-5** are attracted to those below, glue them in place.

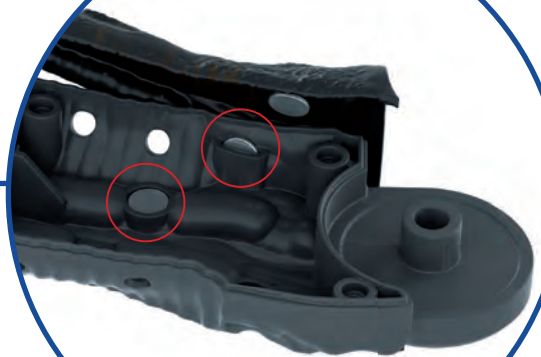

Throughout the build you may notice that there is a slight difference in colour between the parts supplied and those shown. This is due to differences in lighting and the angle of the parts. This will not affect your build.

**KIT 58: THE LEFT HUMERUS (II)**

**58-2**



**56-2**



Separate the parts and put the skin **56-2** aside.

**4**



Take the skin **57-1** from the previous kit and in a similar way to step 3, place the Humerus **58-2** sideways inside it. Fit two Magnets **58-5** into the recesses in Humerus **58-2**, as shown. Check that the Magnets **58-5** are attracted to the corresponding ones in the skin below and when correctly positioned, glue in place.

**58-5**



**58-2**



**57-1**



**5**

**KIT 58: THE LEFT HUMERUS (II)**

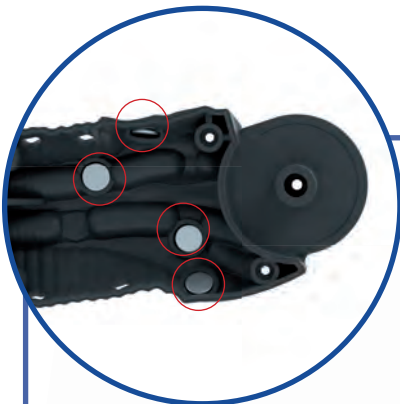

6

Remove the Humerus **58-2** from the skin **57-1** and put the parts to one side. The inset shows a close-up of the magnets fitted in the previous steps.



7

Join the two parts of the Humerus Protector **58-3** and **58-4** together with two 2.3x4mm screws **58-6** and keep safely aside until needed in a later kit.

**KIT 58 IS COMPLETE**



*FURTHER MAGNETS HAVE BEEN ADDED TO THE LEFT HUMERUS AND THE HUMERUS PROTECTOR ASSEMBLED.*

# KIT 59: THE LEFT HUMERUS (III)

In this kit you will continue working on parts of the Xenomorph's left humerus.



## PARTS SUPPLIED

Ref	Name	Qty	Ref	Name	Qty
59-1	Left Humerus	1	59-6	3x22mm screw	1
59-2	Washers	2	59-7	Nut	1
59-3	Humerus Protector	1	59-8	2.3x6mm screws (1 spare)	5
59-4	Humerus Protector	1	59-9	2.3x4mm screws (1 spare)	3
59-5	Magnets	4			

## KIT 59: THE LEFT HUMERUS (III)

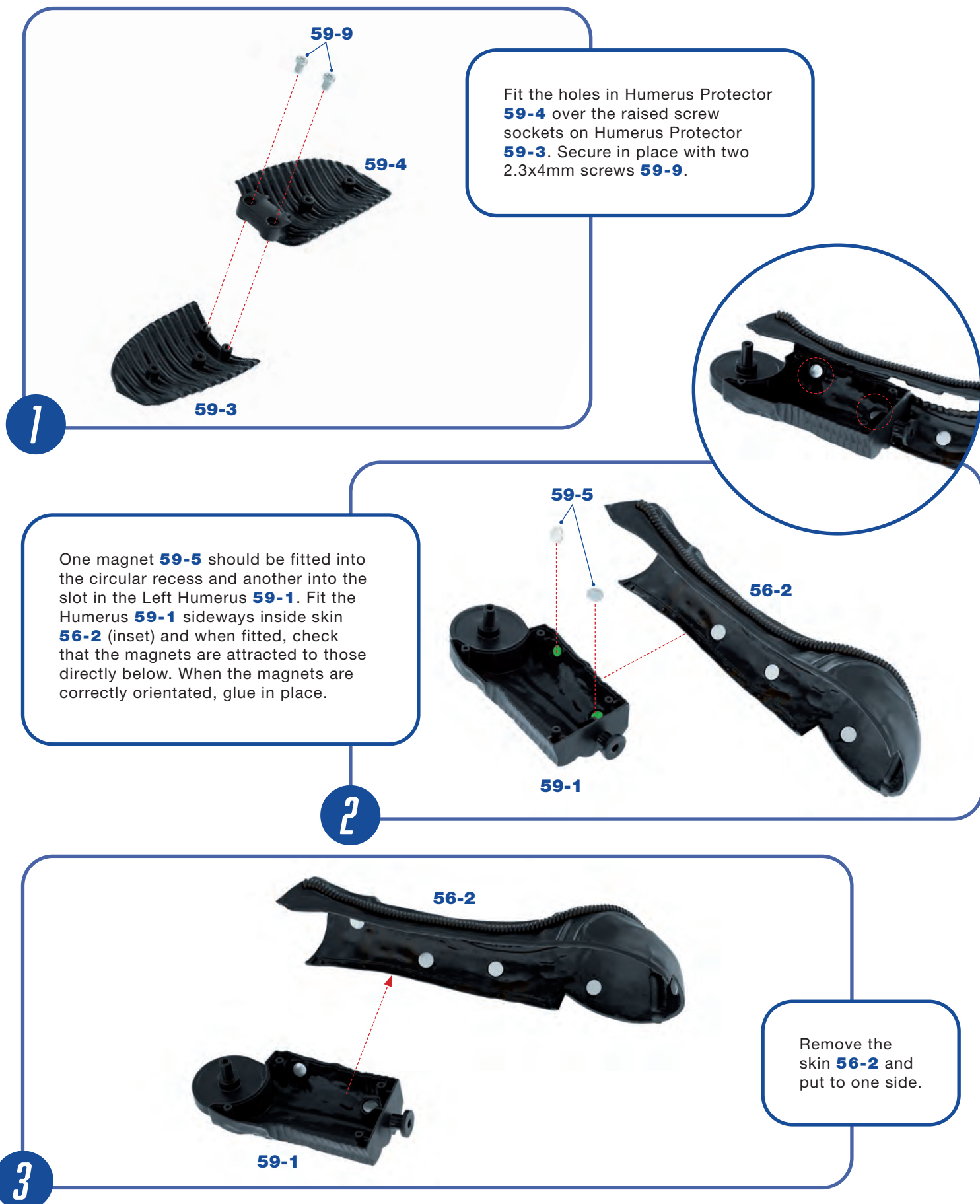

## KIT 59: THE LEFT HUMERUS (III)

4



Two further Magnets **59-5** are fitted into circular recesses inside the Left Humerus **59-1**. Fit the Humerus **59-1** sideways into the skin **57-1** as shown in the inset. After checking that the magnets are attracted to those directly below, glue in place.



Separate the parts and put the skin **57-1** aside.

5



## KIT 59: THE LEFT HUMERUS (III)

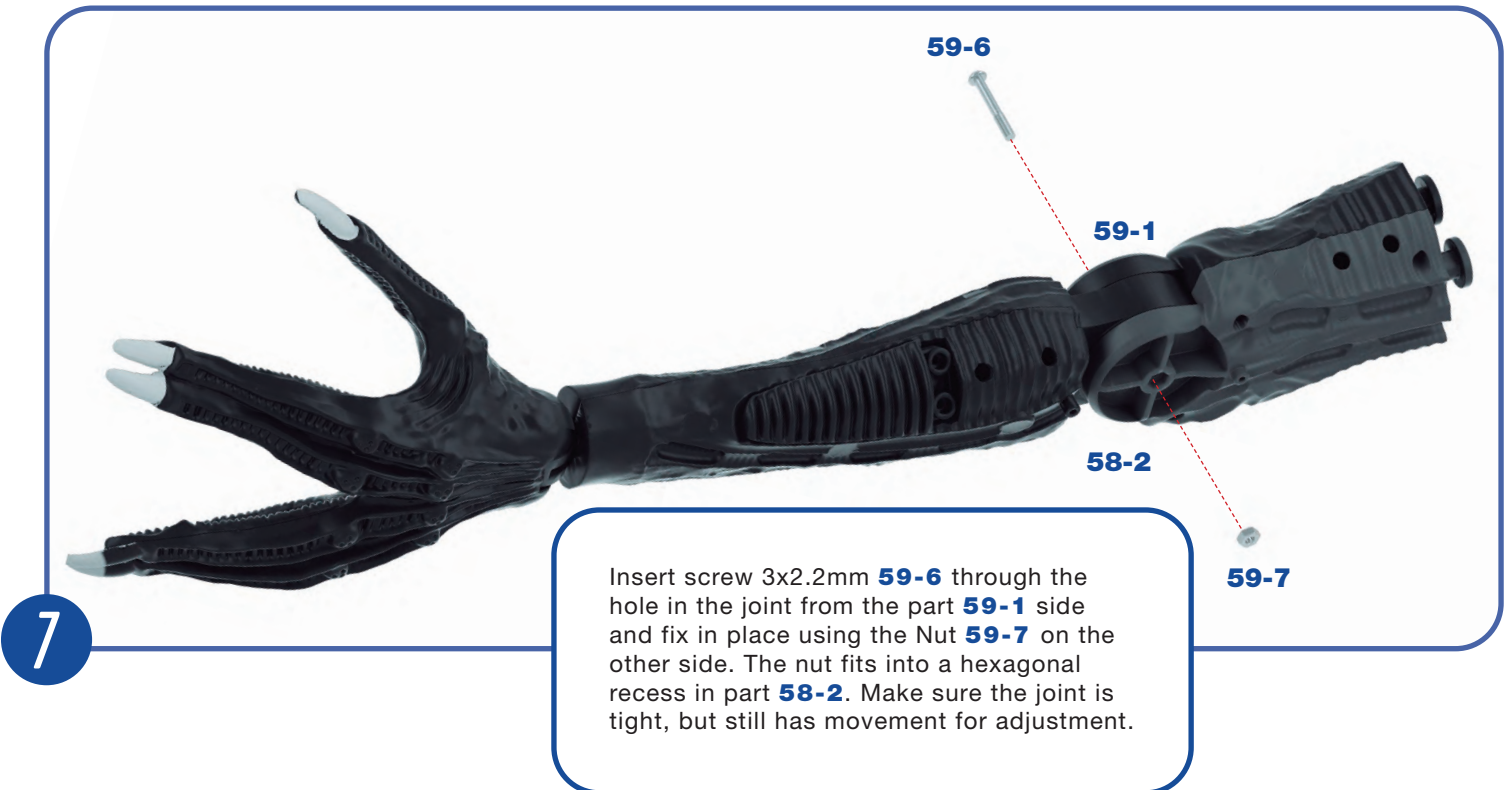
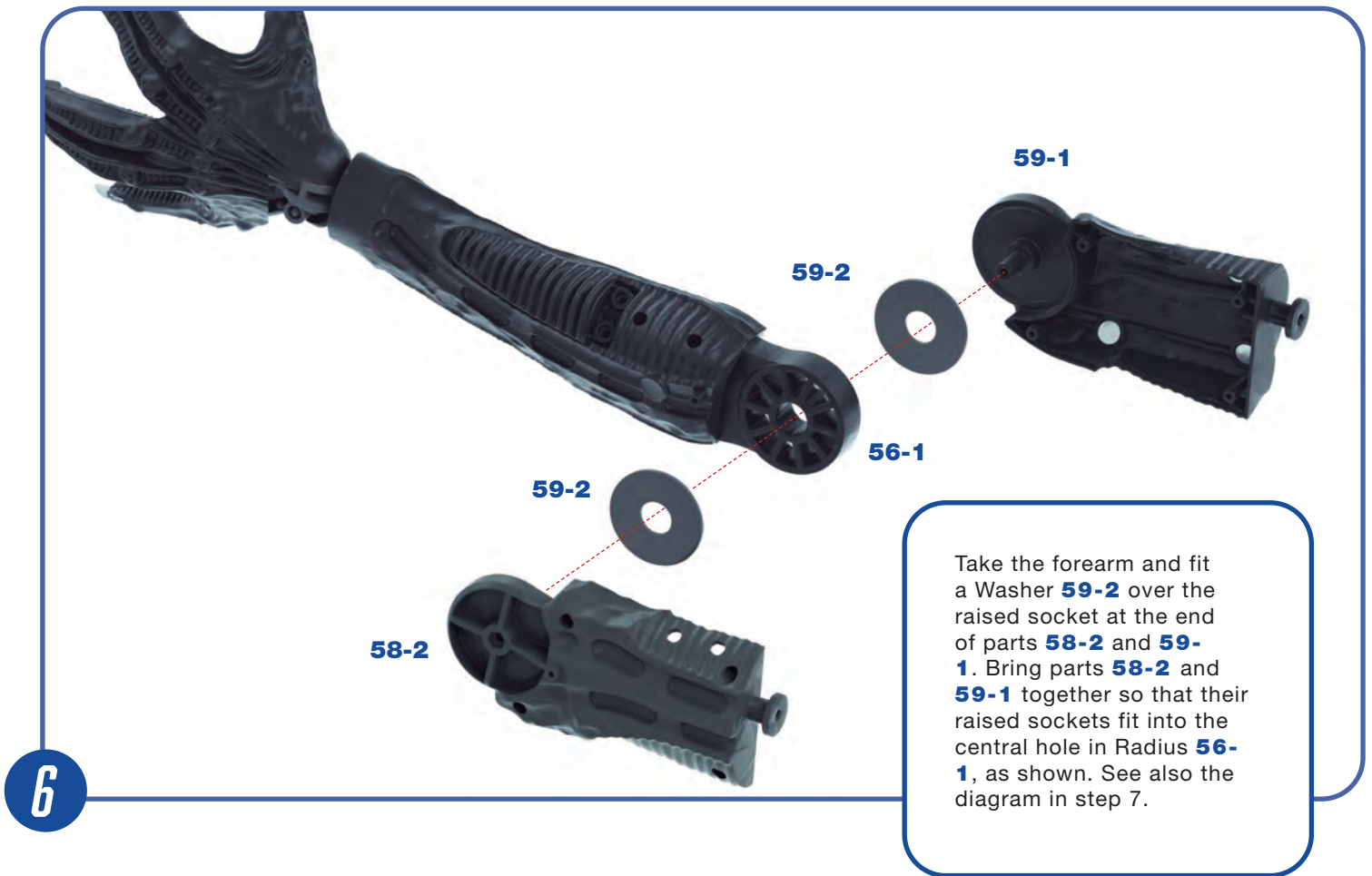

## KIT 59: THE LEFT HUMERUS (III)



Secure parts **58-2** and **59-1** together using four 2.3x6mm screws **59-8**.

8

## KIT 59 IS COMPLETE



*ANOTHER HUMERUS PROTECTOR HAS BEEN ASSEMBLED AND MORE MAGNETS ADDED TO THE HUMERUS. THE HUMERUS ASSEMBLY HAS BEEN ATTACHED TO THE FOREARM.*

# KIT 60: THE LEFT ARM (I)

In this kit you will continue building the left arm and the assembly of the skin covering of the left humerus.



## PARTS SUPPLIED

Ref	Name	Qty	Ref	Name	Qty
60-1	Humerus Joint 1	1	60-5	3x22mm screw	2
60-2	Humerus Joint 2	1	60-6	Nut	2
60-3	Elbow Skin	1	60-7	2x4mm Flange screw (1 spare)	5
60-4	Bush	1			

## KIT 60: THE LEFT ARM (I)

1

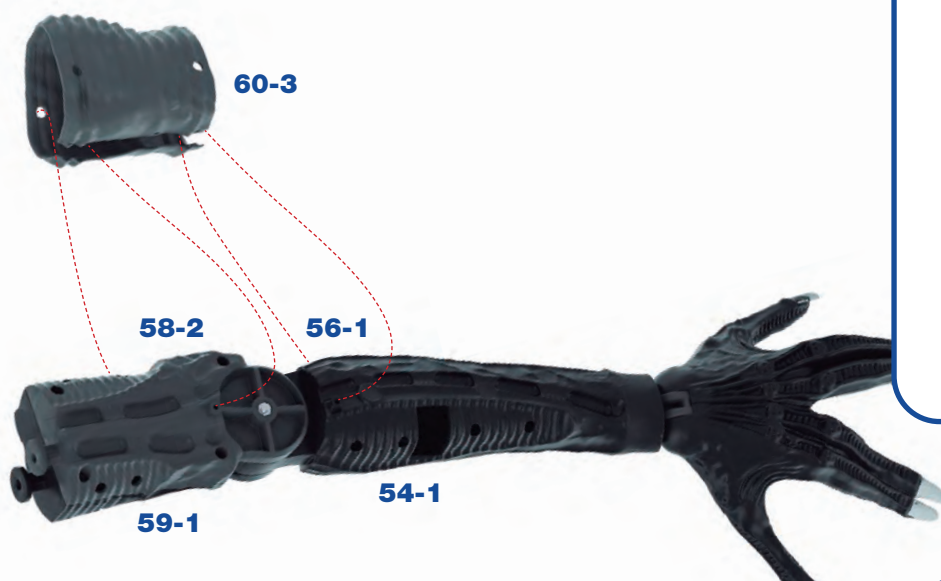

Take the left arm assembly which was worked on in the previous kit. Carefully open Elbow Skin **60-3** and fit it over the elbow as shown in the diagram; the narrow end fits on the radius **54-1/56-1** and the wider end on the humerus **58-2/59-1**. Carefully fit the four holes in the Elbow Skin **60-3** over the raised screw sockets on the right arm. See also the next step.

2



The Elbow Skin **60-3** is held in place using four 2x4mm flange screws **60-7**; take care not to over-tighten these screws. Once the screws have been fitted, turn the assembly over and glue the edges of the Elbow Skin **60-3** together as shown in the inset photograph. Hold firmly together until the glue has set.

3



The two skin parts **53-1** and **55-1** will now be joined together. Apply glue to the contact areas on part **53-1**, as shown in green. Hold the parts together firmly until the glue has set. Do not glue the other edges at this stage.

## KIT 60: THE LEFT ARM (I)

4



Locate the six pegs on the inside of the wrist **55-6**. Carefully pull the edges of the wrist **55-6** apart so that it fits around the arm assembly **53-1/55-1**. Test fit the pegs in the corresponding holes (circled in green) and when certain of a good fit, apply a little glue to the pegs to secure in place. The edges of the wrist must remain separated for now (inset).

### EXPERT TIP:

You may find it easier to glue and secure one half of the wrist before fixing the other half in place.



Take the wrist **55-6**, which was supplied in kit 55 and locate the six pegs inside. Carefully pull the edges of the skin assembly **53-1/55-1/55-6** and fit it around the arm assembly **54-1/56-1**. Study the diagrams carefully and when correctly positioned, glue the edges of the wrist **55-6** together. Then complete the fitting by joining the edges of parts **53-1** and **55-1** together.

5



## KIT 60: THE LEFT ARM (I)

60-4



58-1

Take the humerus part **58-1** which was worked on in kit 58 and place the Bush **60-4** over the central shaft, as shown.

6

60-6

60-2

60-6

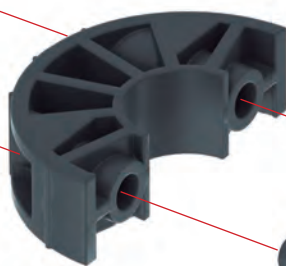

60-1

60-5

60-5

Humerus Joint 1 **60-1** and 2 **60-2** are joined together with two 3x22mm screws **60-5**. These pass through the holes in parts **60-1** and **60-2** and are secured in place with two Nuts **60-6**. The nuts fit into hexagonal recesses in part **60-2**. Do not fully tighten the screws at this stage.

7

## KIT 60: THE LEFT ARM (I)

8



Note the position of Humerus Joint **60-1** when fitting the assembly **60-1/60-2** over the Bush **60-4**. Also note that there are slight ridges on Humerus Joint **60-2** which fit into slots in humerus **58-1**. Once in place, the screws **60-5** from the previous step may be fully tightened.

**PACK 8 AND KIT 60 IS  
NOW COMPLETE**



*SKIN HAS BEEN ADDED TO THE FOREARM  
AND PART OF THE HUMERUS SHOULDER  
JOINT HAS BEEN ASSEMBLED.*